



# LOTUS SUPER 7 SERIES II



1/24 SPORTS CAR SERIES



◀Clubman Racer Type▶  
◀Clubman Racer Type▶

◀Road Car Type▶  
◀Road Car Type▶

★ This kit contains parts to be assembled into one automobile.  
★ Der Kit enthält Teile für ein Auto.

The Lotus Seven grew out of Mr. Colin Chapman's sporting interest in the Austin Sevens, and was a direct development of the Lotus MK. VI. The early layout had simple body panels attached to a sturdy space frame, motorcycle type fenders and little protection from inclement weather. England, during the late 1950's, required a heavy purchase tax on all new cars. A factory built Seven would cost 1,036 lbs (\$2900.00) of which 346lbs (\$968.00) was tax. Chapman decided to take advantage of the tax rule and offer a comprehensive kit which could be assembled in a short time without any special tools. This meant that a sports car enthusiast could obtain a very high performance vehicle for a cost of only 526lbs (\$1472.00). It is a real credit to the designers that after a period of 25 years, the car is still available in kit form, and is still being built, driven, and cherished by sports car enthusiasts around the world. The Lotus Super Seven is powered by a Ford Cosworth 4 cylinder 1.3 liter engine using two dual throated Weber carburetors, which produces 83 BHP at 6,000 RPM. This engine transmits its power through a four speed gearbox providing a top speed, at 6,000 RPM, of a little more than 160km/h. Front suspension is an independent wishbone using helical coils and anti roll bar. Steering is a very tight

rack and pinion system that is quite responsive. Brakes are of the drum type, simple, positive and effective. Rear wheels are mounted on a rigid axle and damped by large coil springs.

The Lotus Super Seven is a true sports car with few creature comforts. If you are looking for a smooth ride in luxurious comfort the Lotus Seven is not for you. If you are looking for phenomenal performance, economical operation and pure fun, then this car will do that, and more. Used by car clubs for racing events, it has won more than its share of honors, and will go on to win even more. Light in weight and with more than enough power, plus the superb road handling it is by far the finest kit form automobile you could obtain.

\* \* \*

Colin Chapman hatte grosses sportliches Interesse an den Austin Seven's und daraus entstand dann der Lotus Mk. VII. Die erste Ausführung hatte eine einfache Karosserie auf einem robusten Gitterrohrrahmen, Schutzbleche wie ein Motorrad, sowie einen kleinen Schutz vor rauhem Wetter. Gegen Ende der 50er Jahre verlangte England eine sehr hohe Verkaufssteuer für alle neue Wagen. Ein

fabrikproduzierter Seven kostete ca 2900.00 Dollar, die Steuer betrug dann darauf nochmals 968.00 Dollar. Chapman fand aus den Steuervorschriften heraus, dass ein Auto im Selbst-Baukasten-Prinzip, welches ohne Spezialwerkzeuge zu einem Wagen mit grosser Leistung zusammengebaut werden konnte, um 1472.00 Dollar verkauft werden kann. Erstaunlich ist, dass diesen Baukasten auch heute, nach rund 25 Jahren immer noch von vielen Sportwagen-Fans gekauft, gebaut, gefahren und heiss geliebt wird. Der Lotus Super Seven hat einen Ford Cosworth 4 Zylinder Motor mit 1,3 Liter, zwei Weber-Doppelvergaser und bringt 83 BHP bei 6000 RPM. Mit einem Viergang-Getriebe geht der Tacho auf über 160km/h. Die Vorderradaufhängung hat unabhängige Querlenkerarme mit Schraubenfedern und Stabilisatoren. Die Steuerung geht über eine sehr stramme Zahnstange und ist ziemlich direkt. Als Bremsen gibt es Trommelbremsen, welche sehr zuverlässig sind, die Hinterräder sind an einer starren Achse montiert, haben grosse Schraubenfedern als Stossdämpfer. Der Lotus Super Seven ist ein richtiger Sportwagen, wenig Komfort, aber eine grosse Leistung ausserdem sehr wirtschaftlich und macht viel Spass beim Fahren. Mit leichtem Gewicht und grosser Kraft bei bester Strassenlage dürfte dieser Auto-Kit im Masstab 1:1 bei weitem das Beste sein, was man bekommen kann.



★ This kit can be made into the "Road Car Type" or the "Clubman Racer Type". Select one before assembly.  
 ★ Mit diesem Kit kann man den "Road Car Type" oder den "Clubman Racer Type" bauen.

## READ BEFORE ASSEMBLY.

ERST LESEN  
 — DANN BAUEN.

- ★ Study the instructions and photographs before commencing assembly.
- ★ You will need a sharp knife, a screwdriver, a file and a pair of pliers.
- ★ Use cement sparingly. Use only enough to make a good bond.
- ★ Apply cement to both parts to be joined.
- ★ Make sure to ventilate room, when you use cement and paints.

This mark denotes paint color, with color names and numbers for Tamiya Acrylic Paints and Tamiya Paint Markers. Page 8 has detailed painting instructions; however, some parts should be painted prior to model's completion, and these are called out during assembly.

★ Vor Beginn die Bauanleitung studieren und den Nummern nach die Elemente zusammensetzen.

★ Bauteile nicht vom Spritzling abbrechen, vorsichtig abschneiden oder abwickeln.

★ Teile vor Kleben zusammenhalten, auf genauen Sitz achten. Nicht zuviel Klebstoff verwenden. Kleine Teile hält man mit Pinzette fest.

★ Abziehbilder vorsichtig von der Unterlage im Wasser abschieben, auf richtigen Sitz achten und gut trocknen lassen.

★ Der Bastelraum sollte bei Verwendung von Farben und Klebstoff gut gelüftet sein.

Dieses Zeichen zeigt die Farbe und Farbnummer der Tamiya Acryl-Farben und Paint Marker.

«Body Color»  
 «Karosseriefarbe»

Body color of the Lotus Super 7  
 Karosserie-Farbe des Lotus Super 7

1. Lemon Yellow ..... (X-8)
2. Red ..... (X-7)
3. White ..... (X-2)
4. Green ..... (X-5)
5. Royal Blue ..... (X-3)

Each interior is combined with above colors. Refer to chart on page 5.  
 Die Inneneinrichtung lässt sich mit obigen Farben variieren, siehe Seite 5 Farbtabelle.

### 3 «Front End» «Vorderbremsen»

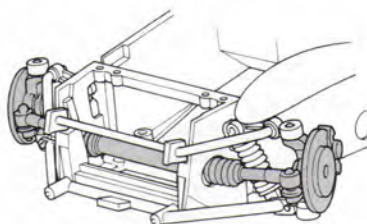

### Tamiya rubbing polishes compound



Used for preparation of plastic surfaces prior to painting and for adding the final polishing to painted surfaces. It can be used to polish out paint overspray from the base coat for a perfect finish.

## 1 Assembly of Front Suspension Vorderere Achsaufhängung

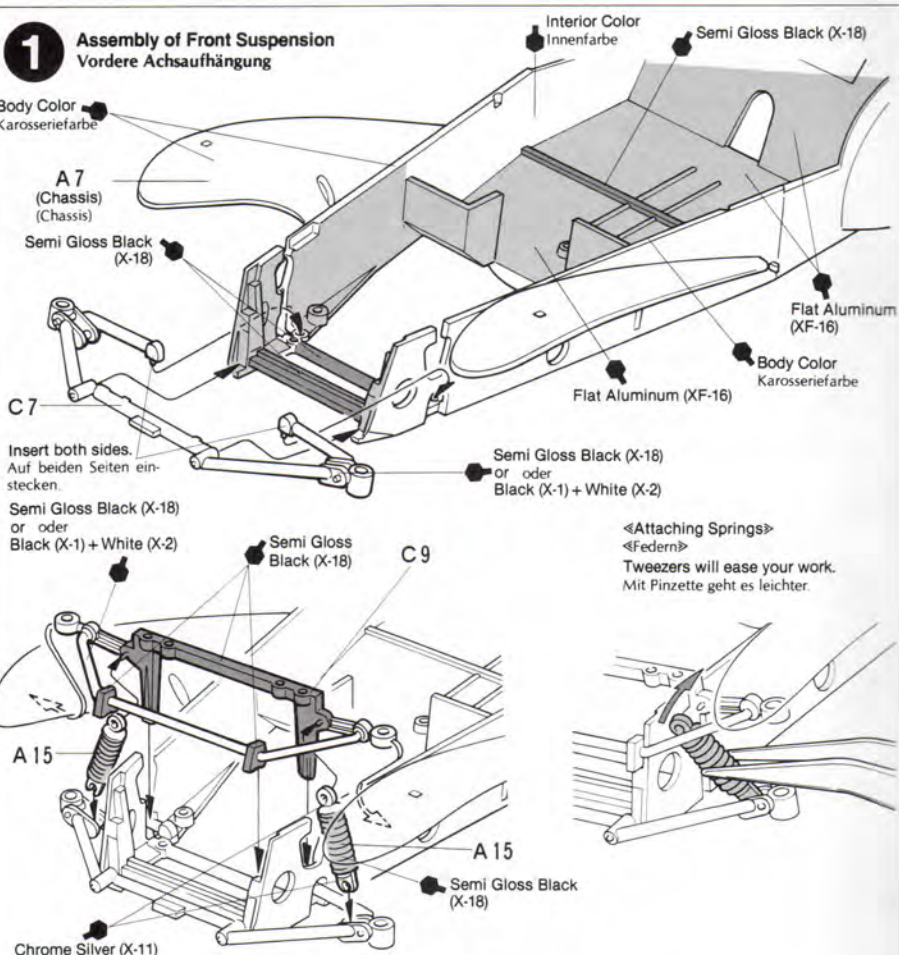

## 2 Assembly of Front Brakes Vorderbremsen

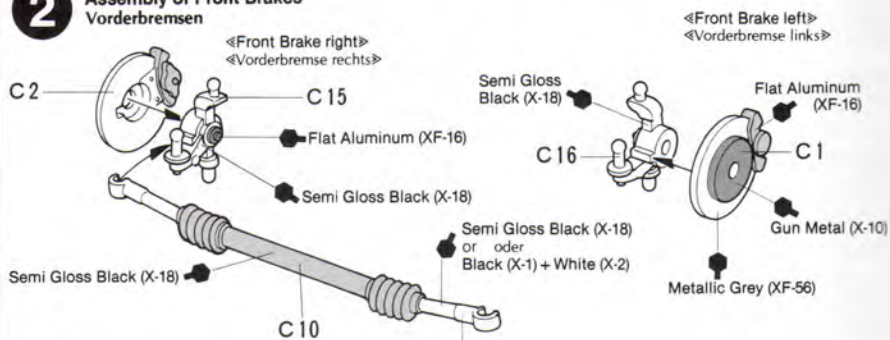

## 3 Attaching Front Brakes Einsetzen der Vorderbremsen

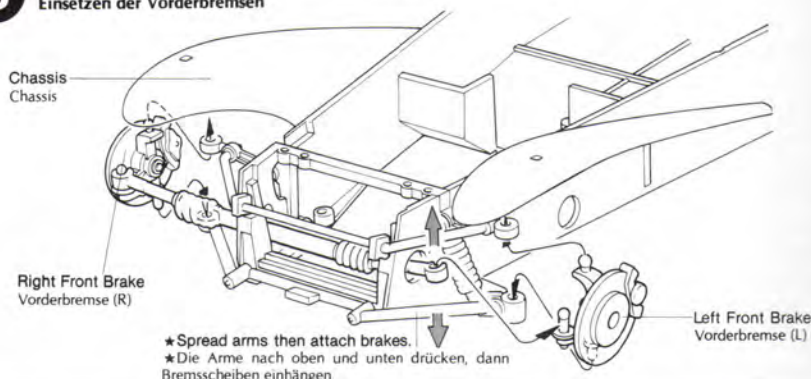



**4** <<Rear Suspension>>  
<<Hintere Achsaufhängung>>

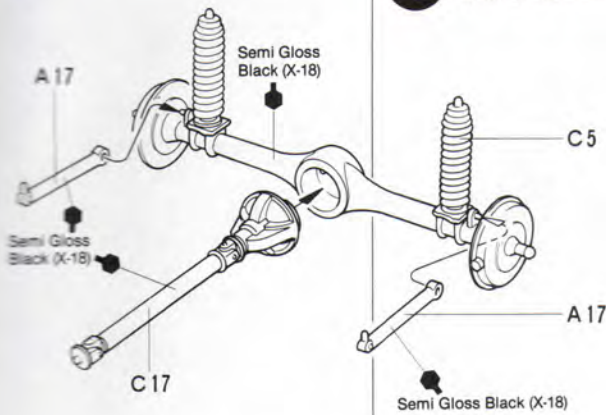

<<Attaching Rear Suspension>>  
<<Einbau der hinteren Achsaufhängung>>  
Tweezers will ease your work.  
Mit Pinzette geht es leichter.

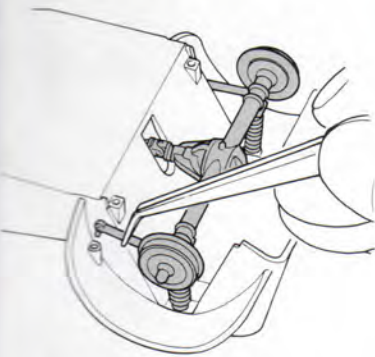

**5** <<Carburetors and Exhausts>>  
<<Vergaser und Auspuff>>

Attach carburetors and exhaust pipes parallel.  
Vergaser und Auspuffrohre parallel einbauen.

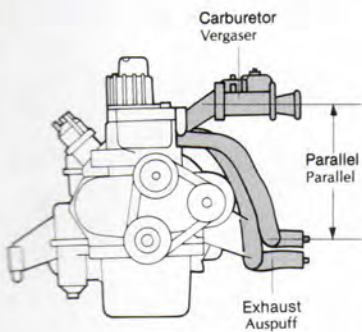

**TAMIYA ACRYLIC PAINTS**  
Need precise color matching?  
Try the new Tamiya acrylic paints. Engineered by modelers for modeler's use. The final cover for the finest models. Insist on Tamiya for perfect results.



**4** Assembly of Rear Suspension  
Montage der hinteren Achsaufhängung

<<Attaching Rear Suspension>>  
<<Einbau der hinteren Achsaufhängung>>

Paint both edges of chassis undersurface (1mm) in body color.  
Die beiden Bodenkanten noch ca 1mm in der für rosse-rie-Farbe bemalen.

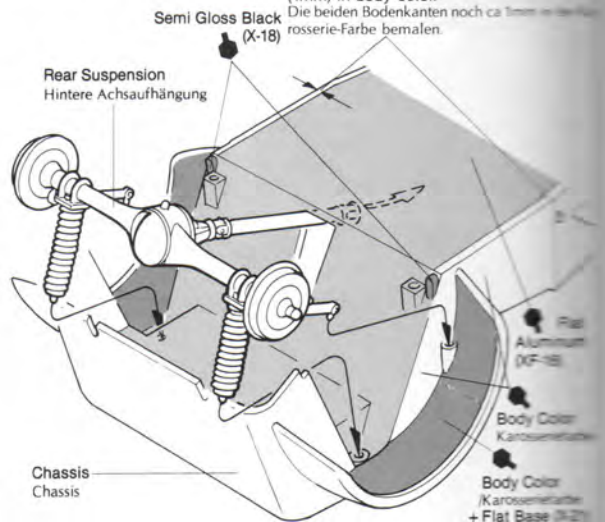

**5** Assembly of Engine  
Motorenbau

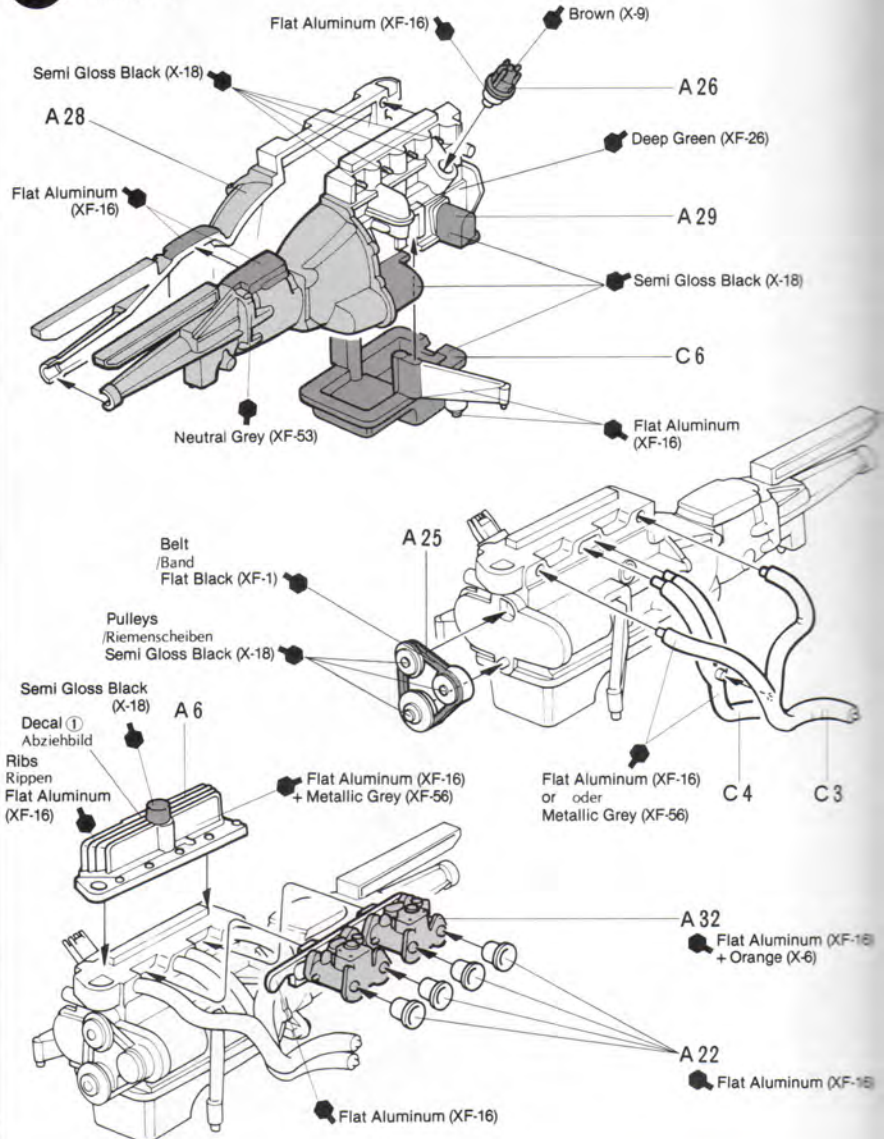

## 7 <<Clubman Racer Type>> <<Clubman Racer Type>>

If you make the Clubman Racer, open holes as shown, in A34.  
Bei Clubman Racer Modell Löcher wie gezeigt machen.

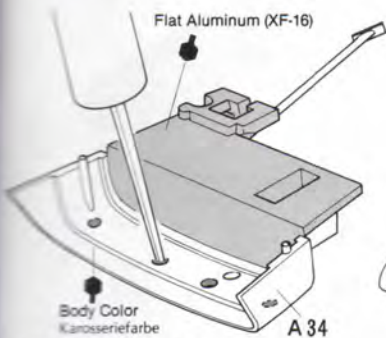

### <<Marking of Meters>>

#### <<Instrumentenbrett>>

Refer to figure below when making and painting meter panel (A9).

Instrumentenbrett + Bemalung siehe Bild unten.

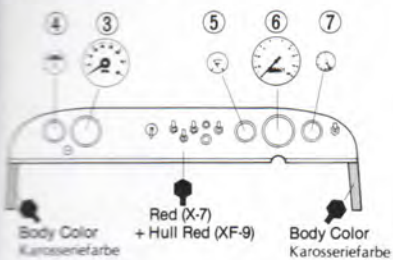

### <<Meter Panel>> <<Instrumentenbrett>>

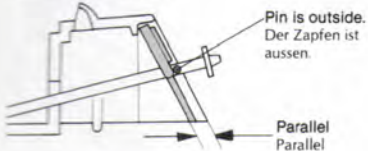

Attach meter panel parallel with cockpit edge.  
Das Instrumentenbrett parallel mit Cockpitkante einbauen.

### <<Pedals>> <<Pedale>>

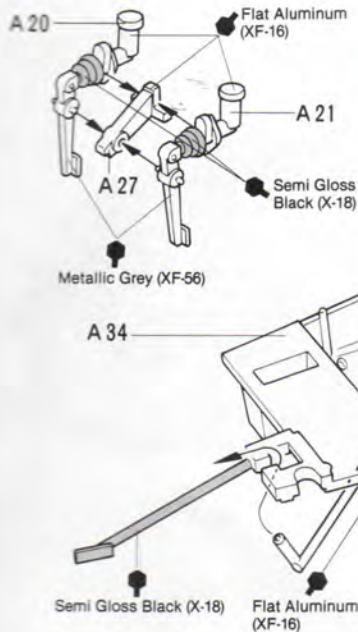

## 6 Attaching Engine Einbau des Motors

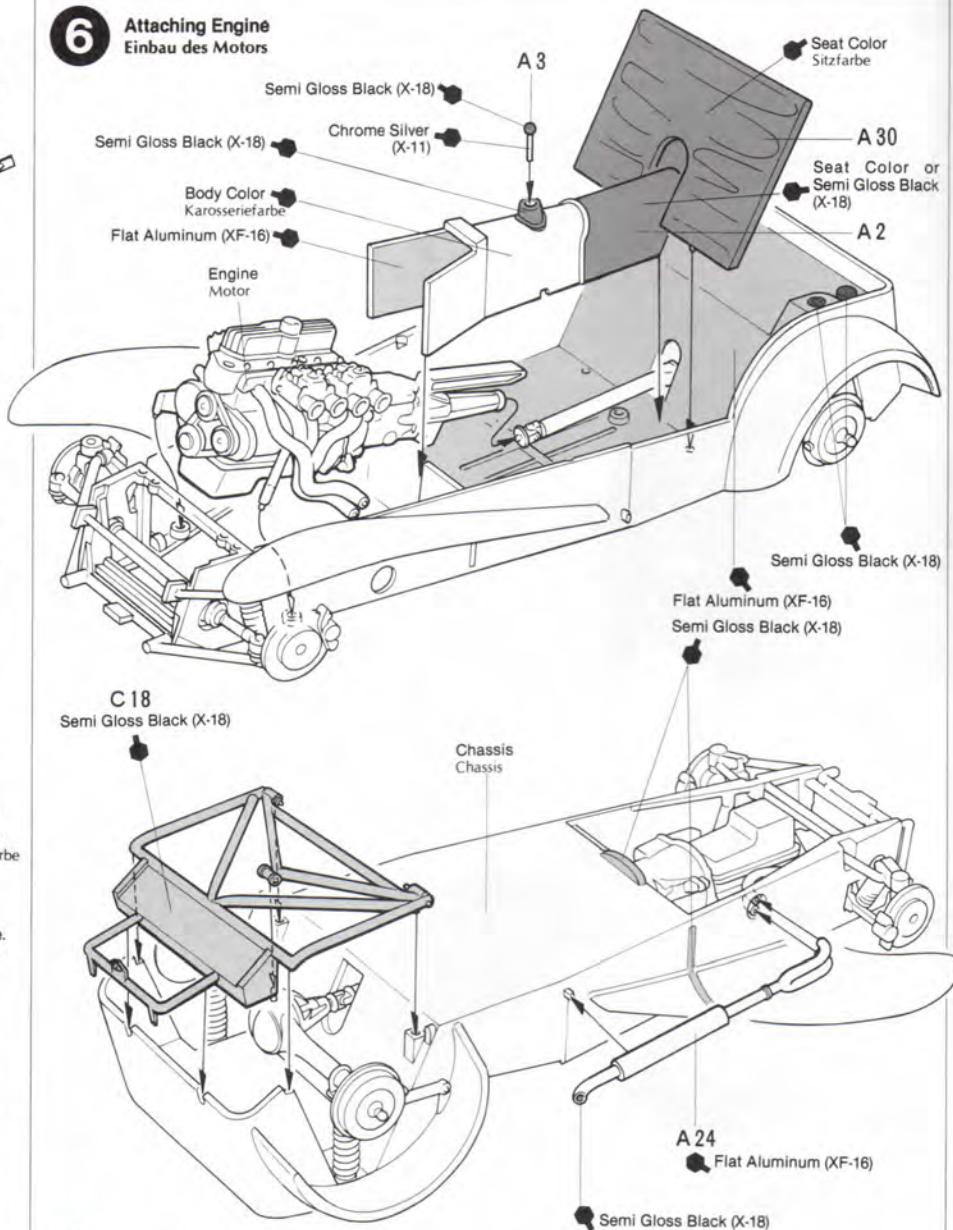

## 7 Assembly of Cockpit Zusammenbau des Cockpit

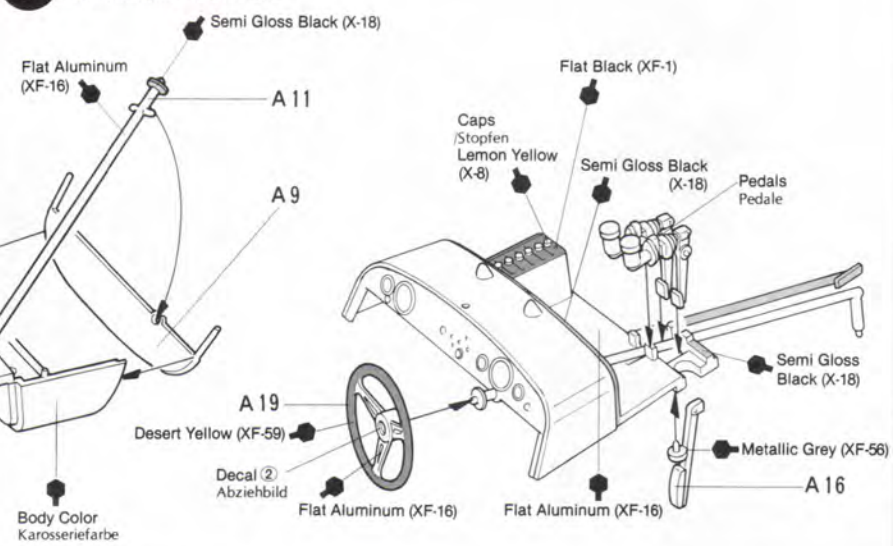



**8** <<Body, Interior and Seat Color>>  
<<Farbentabelle für Karosserie, Sitz und Inneres>>

Interior and seat colors are matched for each body color. Refer to diagram below. Die Farben der Sitze und des Inneren sind auf jede Karosseriefarbe abgestimmt, siehe Tabelle.

Body Color	Seat Color	Interior Color
White (X-2)	Red (X-7) :2	Red (X-7) :2 + Hull Red :1 (XF-9)
Green (X-5)		
Lemon Yellow (X-8)		
Red (X-7)	Black (X-1)	Hull Red :1 (XF-9)
Royal Blue (X-3)		

**9** <<Engine Room>>  
<<Motorraum>>

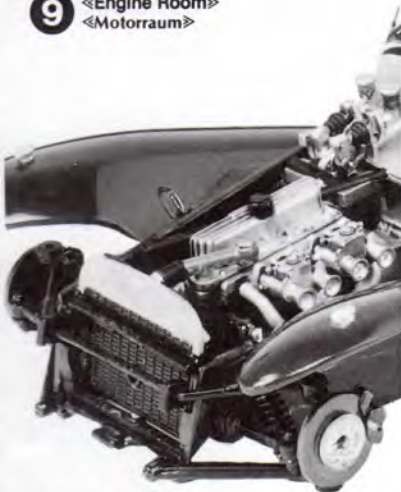

**10** <<Front Grill>>  
<<Frontgrill>>

Bend pins of grill right-angled as shown below. Die Zapfen am Kühlergrill rechtwinklig abbiegen.

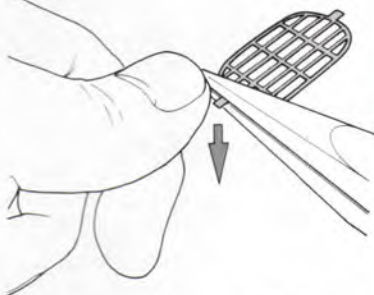

Hold grill firmly with radio type pliers. Den Grill mit Spitzzange festhalten.

**TAMIYA COLOR CATALOGUE**

The latest in cars, boats, tanks and ships. Motorized, radio controlled and museum quality models are all shown in full color in Tamiya's latest catalogue. At your nearest hobby supply house.

**8** Attaching Cockpit  
Zusammenbau des Cockpits

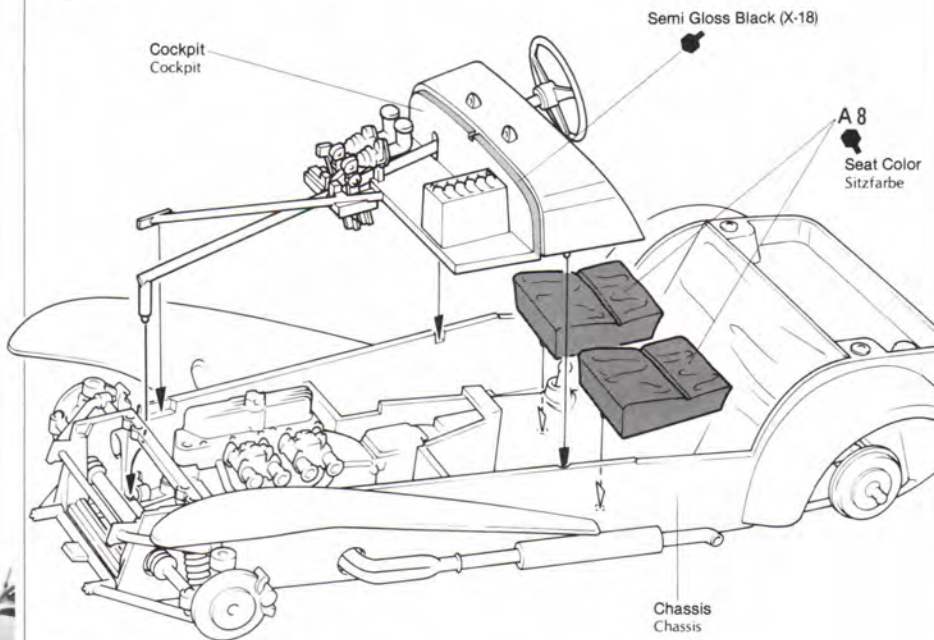

**9** Assembly of Engine Room  
Zusammenbau des Motorraums

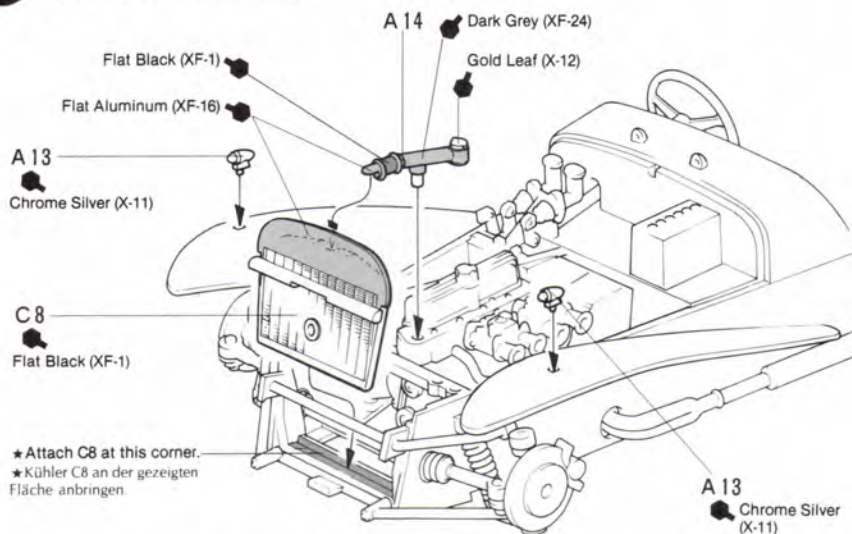

**10** Assembly of Nose Shell  
Zusammenbau der Fronthaube

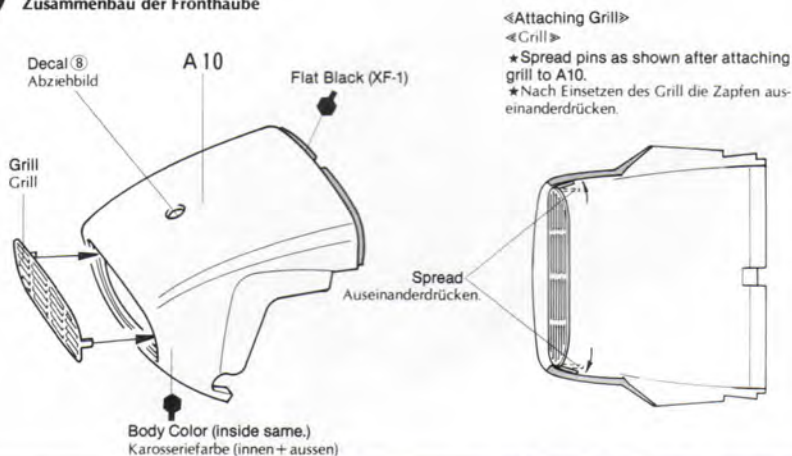

# 11 «Headlights» «Scheinwerfer»

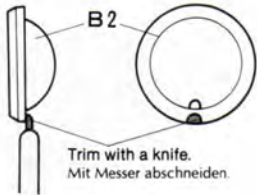

# 12 «Wheel» «Räder»

Pass pin through wheel first, then apply cement to tip of pin with a match.  
Radachse durch Rad stecke und dann Klebstoff mit Zahnstocher nur auf Achse bringen.



# 11 Assembly of Headlights Montage der Scheinwerfer

«Right Light»  
«Rechtes Licht»

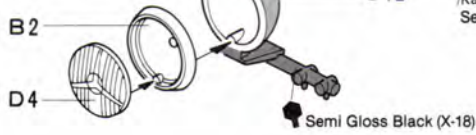

«Left Light»  
«Linkes Licht»

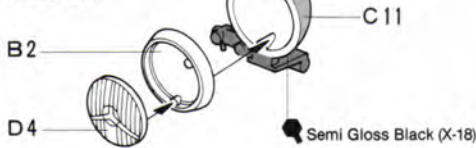

# «Assembly of Wheels»

«Räder»

★ Make 5 sets. (4 sets for clubman racer)  
★ 5 Sätze machen. (Für Clubman Racer 4 Sätze machen.)

Lug Nuts / Radmuttern  
Semi Gloss Black (X-18)

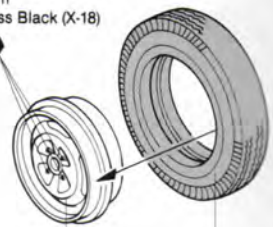

Chrome Silver (X-11) or oder White (X-2)

# 12 Attaching Wheel Einbau der Räder

Right Light  
Rechtes Licht

Left Light  
Linkes Licht

Snap onto pins.  
Radachsen einstecken.

Flat Aluminum (XF-16)  
A 4

Nose Shell  
Fronthaube

Semi Gloss Black (X-18)  
C 13

Flat Aluminum (XF-16)

Chassis  
Chassis

Flat Aluminum (XF-16)

A 4

Body Color  
Karosseriefarbe

A 33

# «Wheel Covers» «Radkappen»

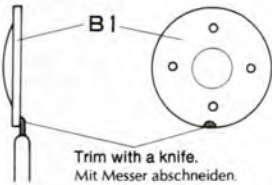

Semi Gloss Black (X-18)  
D 2

Clear Red (X-27)

Flat Aluminum (XF-16)

Semi Gloss Black (X-18)

★ In many cases, the clubman racer type doesn't use a spare tire.  
★ Viele Clubman Racer Type haben kein Ersatzrad angebracht.

B 1

A 1

Flat Aluminum (XF-16)  
★ Push in.  
★ Einstecken.

A 5

Decal ⑨  
Abziehbild

Semi Gloss Black (X-18)

Clear Red (X-27)

B 1

★ Do not use on clubman racer type.  
★ Der Clubman Racer Type hat keine Zierblech.





### 13 Final Assembly Endmontage

<<Road Car>>  
<<Road Car>>

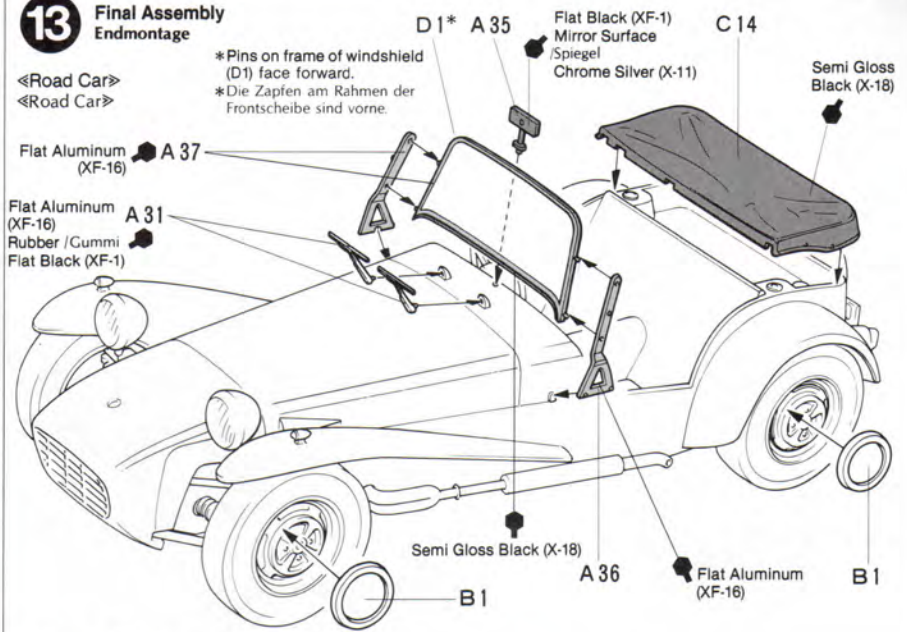

<<Clubman Racer>>  
<<Clubman Racer>>

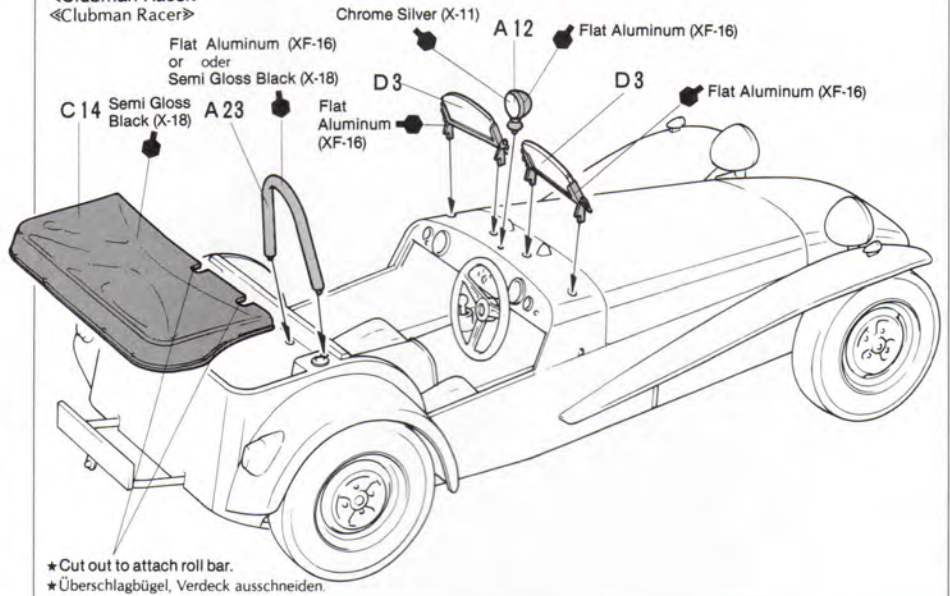

BUILD A COLLECTION OF TAMIYA  
PRECISION CARS

1/24 FAIRLADY Z 300ZX



1/24 MINI COOPER RALLY



1/24 FERRARI F40

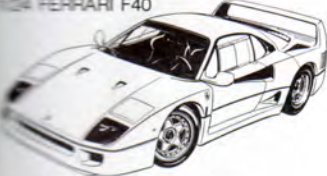

1/24 CAMPUS FRIENDS SET



<<Clubman Racer Type>>  
<<Clubman Racer Type>>





# PAINTING

## «Painting of the Lotus Super 7»

The Super 7 was offered in 5 basic colors of green; yellow, red, white and blue. The seat and interior colors were a reddish brown or black. The interior colors were chosen to contrast with the exterior body colors. Refer to the chart located on page 5 for the combinations. The meter panel was done in red. Use the car numbers on the clubman racing type. Detail painting is called out during construction and should be done at that time.

## «Die Bemalung des Lotus Super 7»

Der Lotus Super 7 wurde in 5 Grundfarben angeboten: grün, gelb, rot, weiss oder blau. Der Sitz und die Inneneinrichtung war schwarz oder braun. Die Farbe der Inneneinrichtung wurde je nach Karosseriefarbe abgestimmt. Das Instrumentenbrett war in rot lackiert. Der Clubman Racer Type hatte Wagennummern. Bemalung der Details sind in der Anleitung angegeben und sollten je nach Step sofort gemacht werden.

### Colors required:

Folgende Farben werden benötigt:

★ From Tamiya Acrylic Paints

Black .....	X-1
White .....	X-2
Royal Blue .....	X-3
Green .....	X-5
Orange .....	X-6
Red .....	X-7
Lemon Yellow .....	X-8
Brown .....	X-9
Gun Metal .....	X-10
Semi Gloss Black .....	X-18
Flat Base .....	X-21
Clear Red .....	X-27
Flat Black .....	XF-1
Hull Red .....	XF-9
Flat Aluminum .....	XF-16
Dark Grey .....	XF-24
Deep Green .....	XF-26
Neutral Grey .....	XF-53
Metallic Grey .....	XF-56
Desert Yellow .....	XF-59

★ From Tamiya Paint Markers

Chrome Silver .....	X-11
Gold Leaf .....	X-12

### «Decal Application»

- (1) Remove all dust, dirt and adhesive smears with a wet cloth before applying any decals.
- (2) The decal to be applied should be removed beforehand from the decal sheet. Cut off translucent film along colored parts.
- (3) Dip the decal in tepid water for about 10 seconds and then remove it onto a clean cloth. Be careful of over immersion to avoid loss of decal's adhesive.



- (4) Hold the backing sheet edge and slide the decal onto the model.
- (5) Wet the decal with a little water on your finger so that it can be moved more easily into position.
- (6) Press the decal down gently with a clean soft cloth to remove air bubbles and until all excess water has been fully absorbed. When a decal has to be applied to a surface which is uneven or curved, press the decal down with a hot towel so that the decal will fit the contours perfectly. Cut off the excess transparent portion around each decal. The decal must then not be touched until dry.

### «Marking of Lotus Super 7»

«Lotus Super 7»

«Road Car Type»

«Road Car Type»

Body Color  
Karosseriefarbe

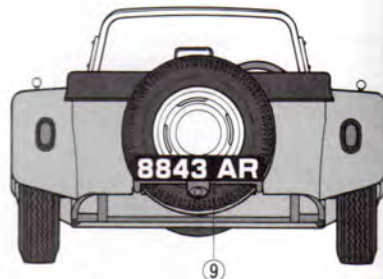
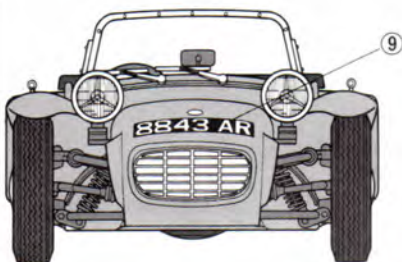
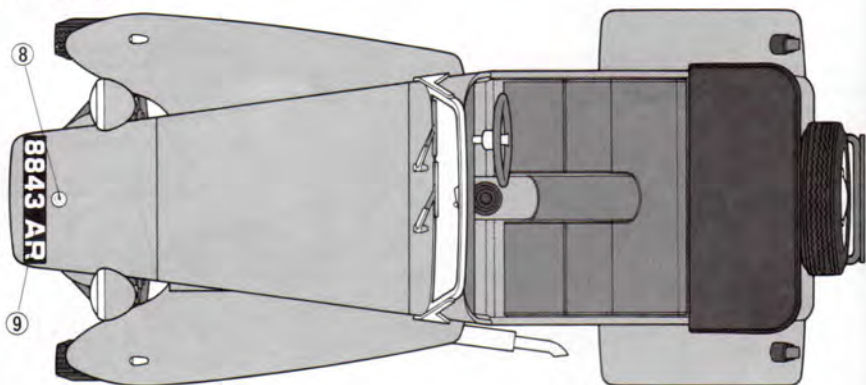

«Clubman Racer Type»

★ Select car number from decal 12 and 13.

«Clubman Racer Type»

★ Wagennummer Decal 12 oder 13

