

## 6. BODY TO CHASSIS

- 1 LOCATE ASSEMBLED INTERIOR TO CHASSIS.** The interior has 8 main points where it connects to the chassis, as shown in the diagrams below by “✖”. Set completed interior onto frame and carefully align and insert the pins on the chassis floor pan area into the posts on the underside of the interior. Install two screws as shown in step 2. Then snap forward sections of roll cage into frame.

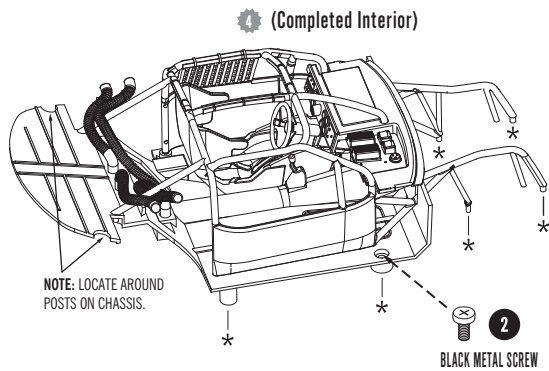

- 5 LOCATE BODY TO CHASSIS.** The body has 6 main points where it connects to the chassis: 4 posts and 2 tabs. Spread body slightly and place it over chassis, carefully inserting the two pins over the rear wheels on the chassis into the locating posts inside the body. Align the front screw mounting posts of chassis with front posts inside body. Turn body/chassis over. Spread rear of body slightly and make sure chassis is snapped under the tabs in sides of body as shown in DETAIL 'A'. Install two screws in front of chassis as shown in step 6.

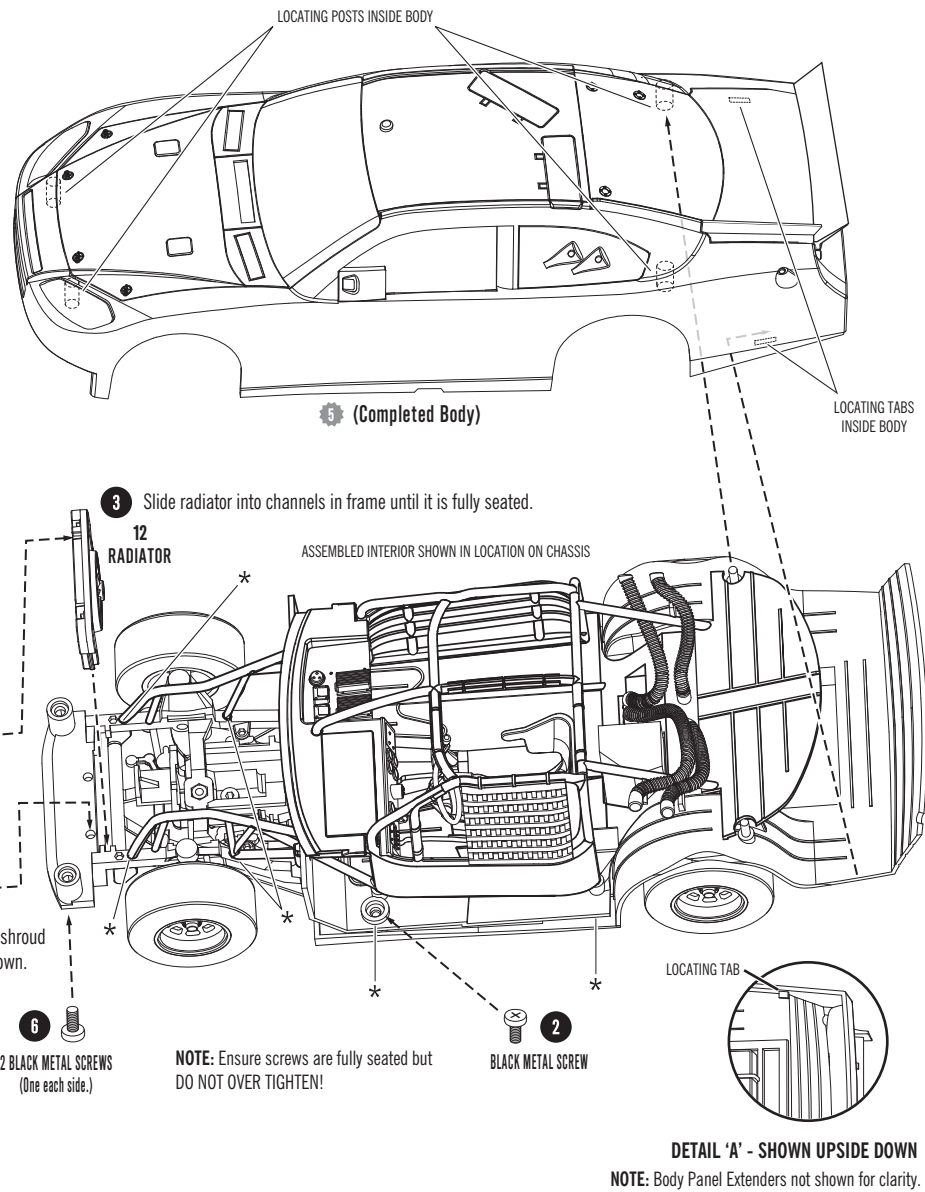
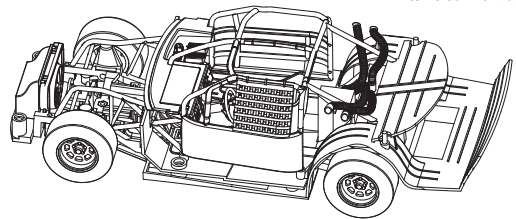

## 7. FINAL ASSEMBLY

- 1** Install front filler panel (30) to body by locating pins on top side of filler into mounting posts in front of body. Forward edge of filler locates behind lip of body, closing the 5 notches.

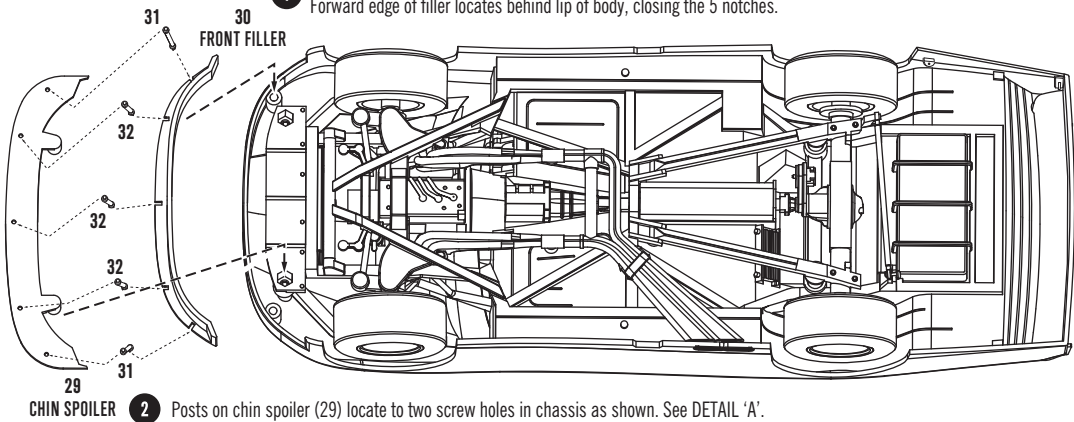

- 3 BRACE INSTALLATION.** Install the 2 outer braces (31) and 3 inner braces (32) between the front filler and chin spoiler by slightly spreading the chin spoiler out enough to pop in the braces as shown in DETAIL 'B'. Outer braces angle inward from bottom to top. Inner braces angle back towards vertical surface of front filler.

**NOTE:** Locating pins and joints on braces are very fragile. Use care when installing to avoid breakage.

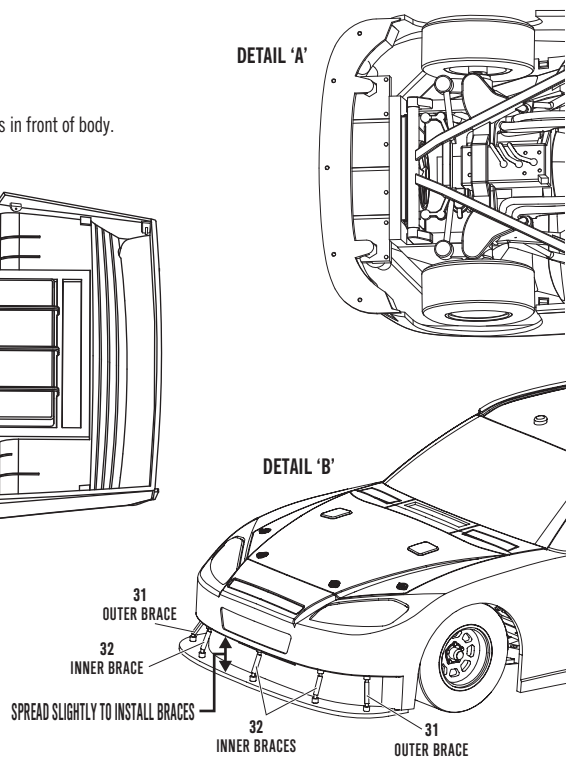

## READ THIS BEFORE YOU BEGIN

- Carefully study and understand the entire instruction sheet before removing any parts from the trees
- Compare the parts in the box to the instruction sheet to be sure all parts are present and accounted for
- Use clippers or hobby knife to remove parts from the trees - DO NOT twist or bend parts off the trees
- Sand or trim away excess flash and parting lines from parts before assembling
- As you proceed, examine contact points on parts to ensure proper location and alignment
- Sub-assemblies should be painted before other parts are attached
- Cement may be used on parts for a stronger, permanent bond - use sparingly for a clean job

**⚠ FOLLOW ASSEMBLY SEQUENCE AS SHOWN AND READ ALL NOTES VERY CAREFULLY**

**IF YOU WISH TO PAINT PARTS OF YOUR MODEL:** Use a solution of mild soap and water to wash parts thoroughly, to remove any dirt or oily residue. Dry parts with a soft towel, then allow them to fully air-dry. Keep your hands and working area clean and dry when assembling your model kit.

Apply a coat of "primer" prior to painting. Any joints that have been glued may then be filled and sanded. Use only filler putty designed for plastic. Test filler on some scrap plastic before applying to your model kit. A tack rag may be used to remove any lint or sanding dust before painting. Paints should be applied evenly in several thin layers rather than one heavy coat. Each layer should be allowed to thoroughly dry before the next is applied. Each coat may be "wet sanded" using slightly damp minimum #1200 sandpaper. Be careful not to remove molded details while sanding. Use frosted tape to mask areas you do not want painted. Remove tape when paint is dry to the touch. Paint lightest colors first. Use a fine brush to touch up edges.

**TIPS FOR USING STICKERS:** Avoid touching the adhesive side of the stickers to prevent fingerprints. Bend the backing sheet enough to lift the edge of the desired sticker and carefully remove it from the sheet. Where possible, it is best to locate the middle of the sticker and work out towards the edges.

## 1. WHEELS & TIRES

- 1** Stretch tire over wheel making sure it is fully seated.

**NOTE:** To make the tires easier to stretch, run them under very warm water for 30-60 seconds. **BE CAREFUL NOT TO BURN YOUR HANDS.**

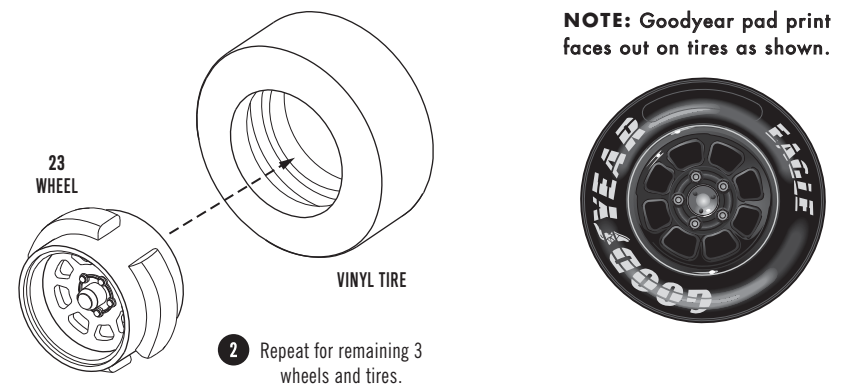

**NOTE:** Goodyear pad print faces out on tires as shown.



© MARVEL. Goodyear (and wing foot design) and Eagle are trademarks of The Goodyear Tire & Rubber Company, Akron, Ohio USA used under license by Round 2, LLC. AMT and design is a registered trademark of Round 2, LLC. ©2013 Round 2, LLC, South Bend, IN 46628 USA. Product and packaging designed in the USA. Made in China. All rights reserved.



## 2. CHASSIS

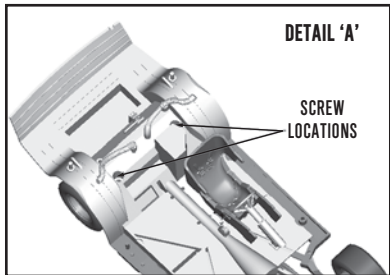

### 3. WHEELS TO CHASSIS



## 4. INTERIOR

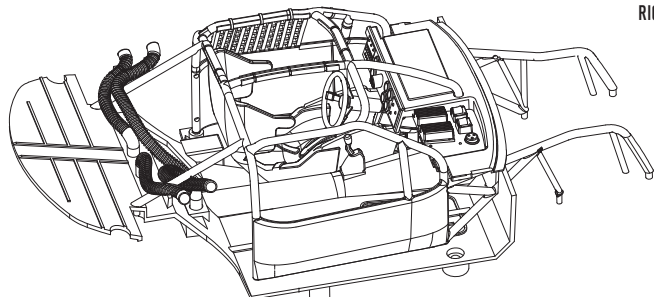

## 5. BODY SUB-ASSEMBLIES



Install left body extender (27) by pressing circular mounting tab over mounting pin on the inside of the body. While doing so, align notch in square mounting tab with raised rib on inside of body. Ensure extender is fully seated at both mounting points. The area shown in gray will be flush with the outer surface of the body when correctly installed. Repeat this procedure to install the right side body extender.