



Kenworth Dump Truck

07406-0389

© 2012 by Revell GmbH & Co. KG. A subsidiary of Hobbico, Inc.

PRINTED IN GERMANY



Kenworth Dump Truck

Ob Straßen, Kanäle, Häuser oder Brücken, überall dort, wo gebaut wird, werden oft riesige Mengen von Sand, Kies, Schotter oder Asphalt benötigt. Diese sogenannten Schuttgüter werden dann von Lastwagen mit speziellen Aufbauten transportiert. Bezeichnungen wie Dreiseitenkipper, Hinter- oder auch Muldenkipper gehören hierzu-lande zu den bekanntesten. In den USA ist ein Dump Truck oder Dumper ebenfalls ein Kipper, der aber ausschließlich das transportierte Material nach hinten abkippt oder entleert. Viele verschiedene Aufbautenhersteller liefern ihre Kippmulden für mehrachsige LKW-Fahrgestelle der Firmen Peterbilt, Mack, Freightliner oder auch Kenworth. Meistens werden die Kipper aus Aluminium gefertigt, und wie sollte es im Lande der unbegrenzten Möglichkeiten auch anders sein, natürlich in auffälligen Lackierungen oder ganz in Chrom. Sozusagen im „feinsten Sonntagsanzug“ präsentiert sich der Kenworth W900 mit verchromtem Kipperaufbau, hergestellt von der Firma Truckweld in Oregon, USA. Was diese Art von Baufahrzeuge oder auch Construction Trucks genannt angeht, so findet man in den Vereinigten Staaten unzählige Gestaltungs- und Konstruktionsarten.

Kenworth Dump Truck

For streets, canals, houses or bridges, everywhere that is built up, great piles of sand, gravel, stone or asphalt will often be needed. These so-called bulk goods will be transported by lorries with special bodies. Names such as three-way tipper, rear tipper or dump truck are the best known in these parts. In the USA a dump truck or dumper is also a tipper, but which only tips out or empties the transported materials at the back. Many different manufacturers of body superstructures supply dumper bodies for multiple-axle lorry chassis made by the firms Peterbilt, Mack, Freightliner or Kenworth. Most of the dumpers are made of aluminium and, how could it be otherwise in the land of unlimited possibilities, naturally they are attractively painted or all in chrome. The Kenworth W900 with chrome superstructure presents itself in its "finest Sunday suit", made by Truckweld of Oregon, USA. As far construction vehicles of this kind are concerned in the USA one finds innumerable types of design and construction.

Licence Text:

Kenworth and KW & design trademarks licensed by PACCAR Inc., Bellevue, Washington, U.S.A.

Form hergestellt und im Eigentum von Revell GmbH & Co. KG. Widerrechtliche Nachahmungen werden gerichtlich verfolgt.

Ce produit est propriété de la société Revell GmbH & Co. KG. Toute utilisation ou duplication frauduleuse fera l'objet de poursuites en justice.

Modelado y en propiedad de Revell GmbH & Co. KG. Imitaciones ilícitas serán perseguidas por la ley.

Forma prodotta dalla Revell GmbH & Co. KG. e di proprietà della stessa impresa, la quale procederà legalmente contro ogni imitazione abusiva.

Malli on Revell GmbH & Co. KG. valmistama ja omaisuutta. Laittoomaan kopiointiin tullaan puuttumaan oikeudellisin toimin.

A forma előállította és a tulajdonjog birtokosa a Revell GmbH & Co. KG. A jogellenes utánzatokat és hamisítványokat bíróságiag üldözik.

Produkcija i prava vlasnosti firme Revell GmbH & Co. KG. Nielegalne podrabianie jest zabronione pod odpowiedzialnoscia sadowa.

Model, Revell GmbH & Co. KG. firmasının mülkiyeti altında imal edilmiştir. Kanuna aykırı taklitler mahkemeye takip edilecektir.

A forma előállította és a tulajdonjog birtokosa a Revell GmbH & Co. KG. A jogellenes utánzatokat és hamisítványokat bíróságiag üldözik.

Mould manufactured by and property of Revell GmbH & Co. KG. Illegal imitations are subject to prosecution.

Vorm vervaardigd door en eigendom van Revell GmbH & Co. KG. Onrechtmatige nabootsingen worden gerechtelijk vervolgd.

Formas produzidas e de propriedade da Revell GmbH & Co. KG. Cópias não autorizadas serão processadas juridicamente Como determinado na lei.

Modellen tillverkad av och tillhör Revell GmbH & Co. KG. All kopiering beivras enligt lagen om upphovsrätt.

Formen er fremstillet af Revell GmbH & Co. KG. som også har ejendomsret. Lovstridige efterligninger sagsøges.

Μοδελς κατασκευαστηκε και παρηλθε ιδιοκτησια της Revell GmbH & Co. KG. Οι παρανομες μιμησεις θα καταδικωνται δικαστικως.

Tvor byl vytvořen firmou Revell GmbH & Co. KG. a je jejím vlastnictvím. Profi nezákonným napodobením s bade postupovat soudní cestou.

Forma je proizvedene in je vlasnistvo Revell GmbH & Co. KG. Neovlascene kopije bodo pravno kaznjene.

Verwendete Symbole/Used Symbols

Bitte beachten Sie folgende Symbole, die in den nachfolgenden Baustufen verwendet werden.
 Veuillez noter les symboles indiqués ci-dessous, qui sont utilisés dans les étapes suivantes du montage.
 Swanse tener en cuenta los símbolos facilitados a continuación, a utilizar en las siguientes fases de construcción.
 Si prega di fare attenzione ai seguenti simboli che vengono usati nei susseguenti stadi di costruzione.
 Huomioi seuraavat symbolit, joita käytetään seuraavissa kokonaisuissa.
 Legg merke til symbolene som benyttes i monteringsstapene som følger.
 Proszę zwrócić na następujące symbole, które są użyte w poniższych etapach montażowych.
 Παρακαλώ προσέξτε τα παρακάτω σύμβολα, τα οποία χρησιμοποιούνται στις παρακάτω βαθμίδες συναρμολόγησης.
 Doha sonraki montaj basamaklarında kullanılmak üzere, aşağıdaki sembollere lütfen dikkat edin.
 Kérjük, hogy a következő szimbólumokat, melyek az alábbi építési fokokban alkalmazásra kerülnek, vegyétek figyelembe.

Please note the following symbols, which are used in the following construction stages.
 Neen a.u.b. de volgende symbolen in acht, die in de onderstaande bouwfasen worden gebruikt.
 Por favor, preste atenção aos símbolos que seguem pois os mesmos serão usados nas próximas etapas de montagem.
 Observera: Nedanstående piktogram används i de följande arbetsmomenten.
 Læg venligst mærke til følgende symboler, som benyttes i de følgende byggefaser.
 Пожалуйста, обратите внимание на следующие символы, которые используются в последующих их операциях сборки.
 Παρακαλώ προσέξτε τα παρακάτω σύμβολα, τα οποία χρησιμοποιούνται στις παρακάτω βαθμίδες συναρμολόγησης.
 Dbejte prosim na dáte uvedené symboly, které se použijí konstrukčních stupnic.
 Prosimo za Vašu pozornost na sledeče simbole ki se uporabljajo v naslednjih korakih gradbe.



Kleben
Glue
Coller
Lijmen
Engomar
Colar
Incollare
Limmas
Limmaa
Klæbning
Lim
Клеить
Przykleić
κόλλημα
Yapıştırma
Lepen
ragasztani
Lepiti

Nicht kleben
Don't glue
Ne pas coller
Niet lijmen
No engomar
Não colar
Non incollare
Limmas ej
Älä limaa
Må ikke klæbes
Ikke lim
Не клеить
Nie przyklejać
μη κολλάτε
Yapıştırılmayın
Nelepit
nem szabad ragasztani
Ne lepití

Wahlweise
Optional
Facultatif
Naar keuze
No engomar
Alternado
Facoltativo
Valfritt
Vaihtoehtoisesti
Efter eget valg
Valgfritt
На выбор
Do wyboru
εναλλακτικά
Szemlél
Választéni
tetszés szerinti
način izbire

Anzahl der Arbeitsgänge
Number of working steps
Nombre d'étapes de travail
Het aantal bouwstappen
Número de operaciones de trabajo
Alternado
Número de etapas de trabalho
Numero di passaggi
Antal arbetsmoment
Työvaiheiden lukumäärä
Antal arbejdsforløb
Antall arbeidstrinn
Κοличество операций
Liczba operacji
αριθμός των εργασιών
İş safhalarının sayısı
Počet pracovných operáci
a munkafolyamatok száma
Številka koraka montaže

Klebeband
Adhesive tape
Dévidoir de ruban adhésif
Plakband
Cinta adhesiva
Fita adesiva
Nastro adesivo
Tejp
Teippi
Tape
Tape
Клейкая лента
Tašma klejajca
κολλητική ταινία
Yapıştırma bandı
Lepici páska
ragasztószalag
Traka z lepilom

Abziehbild in Wasser einweichen und anbringen
Soak and apply decals
Mouiller et appliquer les décalcomanies
Transfer in water even laten weken en aanbrengen
Remojar y aplicar las calcomanías
Pôr de molho em água e aplicar o decalque
Immergere in acqua ed applicare decalcomanie
Blöt och fäst dekalerna
Kostuta siirtokuvaa vedessä ja aseta paikalleen
Overføringsbilledet lægges i blød og anbringes
Dypp bildet i vann og sett det på
Переводную картинку намочить и нанести
Zmękczyć kalkomanie w wodzie a następnie nakleić
Βουτήξτε τη χαλκομανία στο νερό και τοποθετείστε την
Çikartmayı suda yumuşatın ve koyun
Obtisk namočiti ve vodě a umístit
a matricát vızben beázatni és felhelyezni
Preslikać potopiti v vodo in zatem nanašati

Entfernen
Remove
Détacher
Verwijderen
Sacar
Retirar
Eliminare
Tag loss
Poista
Fjernes
Fjern
Удалить
Usunąć
απομακρύνετε
Temizleyin
Odstranit
eltávolítani
Ostraniti



Bauteile trocken lassen
Allow the parts to dry
Laisser sécher les pièces
Dejar secar las piezas
Deixar secar os componentes
la delene tørke
Onderdelen laten drogen
Far asciugarsi i componenti
Anna osien kuivua
Låt byggdelarna torka
Lad komponenterne tørre
Czesci pozostawic do wyschnięcia
Yapı parçalarını kurumaya bırakınız
Jednotlivé díly nechte zaschnout
Αφήστε τα μέρη να στεγνώσουν
Alkatrészeket hagyja száradni
Pustite da sestavni deli posušijo
Дать деталям высохнуть

Klarsichtteile
Clear parts
Pièces transparentes
Transparente onderdelen
Limpjar las piezas
Peça transparente
Parte transparente
Genomsiktliga detaljer
Läpinäkyvät osat
Gennemsigtige dele
Gjennomsiktige deler
Прозрачные детали
Elementy przezroczyste
εξαρτήματα
Birtűrtílen parçaların şekli
Zobrazení sestavených dílů
őszéallított alkatrészek ábrája
Slika slopljenega dela

Abbildung zusammengesetzter Teile
Illustration of assembled parts
Figure représentant les pièces assemblées
Afbeelding van samengevoegde onderdelen
Ilustración piezas ensambladas
Figura representando peças encaixadas
Illustrazione delle parti assemblate
Bildet visar dalarna hopsatta
Kuva yhteellistyistä osista
Illustration af sammensatte dele
Ilustrasjon, sammensatte deler
Изображение смонтированных деталей
Rysunek złożonych części
απεικόνιση των συναρμολογημένων εξαρτημάτων
Birtűrtílen parçaların şekli
Zobrazení sestavených dílů
őszéallított alkatrészek ábrája
Slika slopljenega dela

Zur Anbringung der Abziehbilder empfohlen
Recommended for affixing the decals
Recommandé pour l'application des décalcomanies
Aanbevelen voor het aanbrengen van de transfers
Recomendado para fijar las calcas
Posição recomendada para aplicar os decalques
Raccomandato per applicare le decalcomanie
Rekommenderas för montering av dekaler
Anbefales til påsætning og placering af decals
Рекомендуется использовать для фиксации переводных картинок на поверхности модели
kartonok na permukaan model
Zalecan do nanoszenia kalkomanii
Συνιστάται για την επικόλληση των ετικετών.
Dekallerin yapıştırılmasında kullanılması tavsiye edilir
Priporavke na zlepljenje prilnavosti obtisků
Matrica lágyító
Priporočljivo za pritjevanje nalepk
Odporúčané na zleplenie prilnavosti nálepiek
RECOMANDAT PENTRU APLICAREA ACTIBLURILOR
Подходящо за фиксация на картини върху повърхността на модела

Zur Anbringung der Klarteile empfohlen
Recommended to fix clear parts
Recommandé pour fixer les pièces transparentes
Aanbevelen voor het aanbrengen van transparante delen
Recomendado para fijar piezas transparentes
Consigliato per fissare pezzi trasparenti
Recomendado para colar peças transparentes.
Rekommenderas för festsättning av transparenta delar
Suositellaan läpinäkyvien osien kiinnittämiseen
Anbefales til fastgørelse af gennemsigtige dele
Anbefales til å feste klare deler
Рекомендується для кріплення прозорих частей
Zalecan do mocowania przezroczystych elementów
Συνιστάται για την τοποθέτηση διαφανών στοιχείων
Şeffaf parçaları birleştirilmede tavsiye edilir
Doporučeno pro připevnění průzračných částí
Ajánlott az alkatrészek felerősítéséhez ajánlott
Priporočeno za nameslitev prozornih delov
Doporučuje sa pre montáž priesvitných prvkov
Recomandat pentru fixarea pieselor transparente
Препоръчва се за закрепване на прозрачни части



Gleichen Vorgang auf der gegenüberliegenden Seite wiederholen
Repeat same procedure on opposite side
Opérer de la même façon sur l'autre face
Dezelfde handeling herhalen aan de tegenoverliggende kant
Realizar el mismo procedimiento en el lado opuesto
Repetir o mesmo procedimento utilizado no lado oposto
Stessa procedura sul lato opposto
Upprepa proceduren på motsatta sidan
Toista sama toimenpide kuten viereisellä sivulla
Det samme arbejdet gentages på den modsatliggende side
Gjenta prosedyren på siden tvers overfor
Повторять такую же операцию на противоположной стороне
Taki sam przebieg czynności powtórzyc na stronie przeciwnej
επαναλάβετε την ίδια διαδικασία στην απέναντι πλευρά
Ayın işlemleri karşı tarafta tekrarlayın
Stejný postup zopakovat na protilehlé straně
ugyanazt a folyamatot a szemben található oldalán megismételni
Isti postopek ponoviti in na suprotni strani

Mit einem Messer abtrennen
Detach with knife
Détacher au couteau
Met een mesje afsnijden
Separarlo con un cuchillo
Separar utilizando uma faca
Staccare col coltello
Skär loss med kniv
Irrotta veitsellä
Adskilles med en kniv
Skjær av med en kniv
Отделять ножом
Odciać nożem
διαχωρίστε με ένα μαχαίρι
Bir bıçak ile kesin
Oddélit pomocí nože
kés segítségével leválasztani
Oddelíti z nožem

Chromteile
Chrom parts
Pièces chromées
Chroom onderdelen
Cromar las piezas
Peça cromada
Parti cromate
Kromdetaljer
Kromatut osat
Krom-dele
Kromdeler
Хромированные детали
Elementy chromowane
εξαρτήματα χρωμίου
Krom parçaları
Χρόμωθε díly
krom alkatrészek
Kromirani deli

Wegfeilen
File off
Enlever avec une lime
Wegvijlen
Retirar
Eliminare
Tag loss
Poista
Fjernes
Fjern
Удалить
Usunąć
απομακρύνετε
Temizleyin
Odstranit
eltávolítani
Ostraniti

Zur Anbringung der Chromteile empfohlen
Recommended to fix chrome parts
Recommandé pour fixer les pièces chromées
Aanbevelen voor het aanbrengen van verchroomde delen
Recomendado para fijar piezas de cromo
Consigliato per fissare pezzi cromati
Rekommenderas för festsättning av förkromade delarna
Anbefales til fastgørelse af kromdele
Συνιστάται για την τοποθέτηση χρωμιωμένων στοιχείων
Anbefales til å feste kromdeler
Recomendado para colar peças cromadas
Suositellaan kromiosien kiinnittämiseen
Rekomendues for krepplena kromierovanných částey
Zalecan do mocowania chromowych elementów
Krom parçaları birleştirilmede tavsiye edilir
Doporučeno pro připevnění chromových částí
Ajánlott az alkatrészek felerősítéséhez ajánlott
Priporočeno za nameslitev delov iz kroma
Doporučuje sa pre montáž chromových prvkov
Recomandat pentru fixarea pieselor cromate.
Препоръчва се за закрепване на хромирани части



Nicht enthalten
Not included
Non fourni

Behoort niet tot de levering
No incluido
Non compresi

Não incluído
Ikke medsendt
Ingår ej

Ikke inkluderet
Eivät sisälly
Δεν συμπεριλαμβάνεται

He содержится
Nem tartalmazza
Nie zawiera

Ni vsebovano
Içerisinde bulunmamaktadır
Neni obsaženo

Benötigte Farben/Used Colors

Benötigte Farben Required colours	Peintures nécessaires Benodigde kleuren	Pinturas necesarias Tintas necessárias	Colori necessari Använda färger	Tarvittavat värit Du trenger følgende farger	Nødvendige farger Необходимые краски	Potrzebne kolory Απαιτούμενα χρώματα	Gerekli renkler Potrebne barvy	Szükséges színek Potrebne barve
A anthrazit, matt 9 anthracite grey, matt anthracite, mat antraciet, mat antracita, mate antracite, fosco antracite, opaco antracit, matt antrasitti, himmeä koksgrå, mat antrasitt, matt антрацит, матовый antracyt, matowy anvbraki, mat antrasit, mat antracit, matná antracit, matt tanno siva, mat	B weiß, seidenmatt 301 white, silky-matt noir, satiné mat wit, zijdemat blanco, mate seda branco, fosco sedoso bianco, opaco seta vit, sidenmatt valkoinen, silkinhimmeä hvid, silkematt белый, шелковисто-матовый bialy, jedwabisto-matowy λευκό, μεταξωτό ματ beyaz, ipek mat bílá, hedvábně matná fehér, selyemmatt bela, svila mat	C aluminium, metallic 99 aluminium, metallic aluminium, métallique aluminium, metallic aluminio, metalizado aluminio, metálico alluminio, metallico aluminium, metallic alumiini, metallikiilto aluminium, metallak aluminium, metallic алюминиевый, металлик aluminium, metalliczny αλουμινίου, μεταλλικό aluminium, metalik hliniková, metaliza aluminium, metall aluminium, metalik	D schwarz, seidenmatt 302 black, silky-matt noir, satiné mat zwart, zijdemat negro, mate seda preto, fosco sedoso nero, opaco seta svart, sidenmatt musta, silkinhimmeä sort, silkematt черный, шелковисто-матовый czarny, jedwabisto-matowy μαύρο, μεταξωτό ματ siyah, ipek mat černá, hedvábně matná fekete, selyemmatt črna, svila mat	E silber, metallic 90 silver, metallic argent, métallique zilver, metallic plata, metalizado prata, metálico argento, metallico silver, metallic hopea, metallikiilto solv, metallak solv, metallic серебристый, металлик srebro, metaliczny oşmi, metaliko gümüş, metalik stříbrná, metaliza ezüst, metál srebrna, metalik	60% beige, seidenmatt 314 + beige, silky-matt beige, satiné mat beige, zijdemat beige, mate seda beige, fosco sedoso beige, opaco seta beige, sidenmatt beige, silkinhimmeä beige, silkematt beige, silkematt бежевый, шелковисто-матовый beżowy, jedwabisto-matowy μπεζ, μεταξωτό ματ bej, ipek mat béžová, hedvábně matná bézs, selyemmatt slonova kost, svila mat	F 60% lufthansa-gelb, seidenmatt 310 "Lufthansa" yellow, silky-matt jaune "Lufthansa", satiné mat Lufthansa geel, zijdemat amarillo Lufthansa, mate seda amarillo Lufthansa, fosco sedoso giallo Lufthansa, opaco seta Lufthansa-gul, sidenmatt Lufthansa-keltainen, silkinhimmeä Lufthansa-gul, silkematt Lufthansa-gul, silkematt желтый "люффтанза", шелк-матовый žofy Lufthansa, jedwabisto-matowy κίτρινο δ'ύ' αούδ, μεταξωτό ματ lufthansa sarisi, ipek mat žlutá Lufthansa, hedvábně matná Lufthansa-sárga, selyemmatt lufthansa rumena, svila mat	G feuerrot, seidenmatt 330 fiery red, silky-matt rouge feu, satiné mat rood helder, zijdemat rojo fuego, mate seda vermelho vivo, fosco sedoso rosso fuoco, opaco seta eldród, sidenmatt tulipunainen, silkinhimmeä íldróð, silkematt íldróð, silkematt огненно-красный, шелк-матовый czerwony ognisty, jedwabisto-mat. κόκκινο φωτιάς, μεταξωτό ματ ateş kırmızısi, ipek mat ohnivě červená, hedvábně matná tűzpiros, selyemmatt ogenj rdeča, svila mat	
H staubgrau, matt 77 dust grey, matt gris poussière, mat stofgrijs, mat ceniciento, mate cinzento de pó, fosco grigio sabbia, opaco dammgrå, matt pölyharmaa, himmeä stovgrå, mat stovgrå, matt серый пыльный, матовый szary kurz, matowy χρώμα σκόνης, ματ toz grisi, mat prachové šedá, matná porszürke, matt prah siva, mat	I grau, seidenmatt 374 grey, silky-matt gris, satiné mat grijs, zijdemat gris, mate seda cinzento, fosco sedoso grigio, opaco seta grå, sidenmatt harmaa, silkinhimmeä grå, silkematt grå, silkematt серый, шелковисто-матовый szary, jedwabisto-matowy γκρι, μεταξωτό ματ gri, ipek mat šedá, hedvábně matná szürke, selyemmatt siva, svila mat	J rot, klar 731 red, clear rouge, clair rood, helder rojo, claro vermelho, claro rosso, chiaro röd, klar punainen, kirkas röd röd красный κόκκινο, διαυγές kírmizi, şeffaf červená, čirá piros, áttetsztel rdeča, jasna	K nachtblau, glänzend 54 night blue, gloss bleu nuit, brillant nachtblau, glansend negro azulado, brillante azul de noite, brilhante blu notte, lucente nattblå, blank yönsininen, kiiltävä natteblå, skinnende nattblå, blank синий ночной, блестящий granatowy, błyszczący μπλε νύχτας, γυαλιστερό demir, metalik železná, metaliza vas, metál železna, metalik	L eisen, metallic 91 steel, metallic coloris fer, métallique ijzerkleurig, metallic ferroso, metalizado ferro, metálico ferro, metalico jernfårg, metalik teräksenväriäinen, metallikiilto jern, metallak jern, metallic стальной, металлик żelazo, metaliczny σιδηρό, μεταλλικό demir, metalik železná, metaliza vas, metál železna, metalik	M orange, klar 730 orange, clear orange, clair oranje, helder naranja, claro laranja, claro arancione, chiaro orange, klar oranssi, kirkas orange orange оранжевый pomarańczowy πορτοκαλί, διαυγές portakal, şeffaf oranžová, čirá narancs, áttetsztel pomarandžasta, jasna	50% orange, glänzend 30 + orange, gloss orange, brillant oranje, glansend naranja, brillante laranja, brilhante arancione, lucente orange, klar oranssi, kiiltävä orange orange, blank оранжевый, блестящий pomarańczowy, błyszczący πορτοκαλί, γυαλιστερό portakal, parlak oranžová, lesklá narancsszín, fényes pomorandžast, bleskajoca	N 50% feuerrot, seidenmatt 330 fiery red, silky-matt rouge feu, satiné mat rood helder, zijdemat rojo fuego, mate seda vermelho vivo, fosco sedoso rosso fuoco, opaco seta eldród, sidenmatt tulipunainen, silkinhimmeä íldróð, silkematt íldróð, silkematt огненно-красный, шелк-матовый czerwony ognisty, jedwabisto-mat. κόκκινο φωτιάς, μεταξωτό ματ ateş kırmızısi, ipek mat ohnivě červená, hedvábně matná tűzpiros, selyemmatt ogenj rdeča, svila mat	
50% schwarz, seidenmatt 302 + black, silky-matt noir, satiné mat zwart, zijdemat negro, mate seda preto, fosco sedoso nero, opaco seta svart, sidenmatt musta, silkinhimmeä sort, silkematt sort, silkematt черный, шелковисто-матовый czarny, jedwabisto-matowy μαύρο, μεταξωτό ματ siyah, ipek mat černá, hedvábně matná fekete, selyemmatt črna, svila mat	O 50% dunkelgrau, seidenmatt 378 dark grey, silky-matt gris foncé, satiné mat donkergrijs, zijdemat gris oscuro, mate seda cinzento escuro, fosco sedoso grigio scuro, opaco seta mörkgrå, sidenmatt harmaa, silkinhimmeä mörkegrå, silkematt mörkegrå, silkematt серый, шелковисто-матовый szary, jedwabisto-matowy γκρι, μεταξωτό ματ gri, ipek mat šedá, hedvábně matná szürke, selyemmatt siva, svila mat							

D: Beiliegenden Sicherheitstext beachten und nachschlagebereit halten.

GB: Please note the enclosed safety advice and keep safe for later reference.

F: Respecter les consignes de sécurité ci-jointes et les conserver à portée de main.

NL: Houdt u aan de bijgaande veiligheidsinstructies en hou deze steeds bij de hand.

E: Observar y siempre tener a disposición este texto de seguridad adjunto.

I: Seguire le avvertenze di sicurezza allegate e tenerle a portata di mano.

P: Ter em atenção o texto de segurança anexo e guard-lo para consulta.

S: Beakta bifogad säkerhetstext och håll den i beredskap.

FIN: Huomioi ja säilytä ohaiset varoitukset.

DK: Overhold vedlagte sikkerhedsanvisninger og hav dem liggende i nærheden.

Dieser Bausatz wurde in mehreren Qualitäts- und Gewichtskontrollen auf Vollständigkeit überprüft. Reklamationen können nur bearbeitet werden, wenn die **Bauanleitung**, das aus der Kartongabe herausgeschnittene **EAN-Strichcode-Feld** und der **Kassenbon** eingeschickt werden. Bitte haben Sie Verständnis dafür, dass wir Ihre Gewährleistung bei aktuellen Artikeln übernehmen können, die im Zeitraum der letzten 24 Monate erworben worden sind. **Unfrei eingesandte Reklamationssendungen werden von uns nicht angenommen!** Einzelteile für Umbauten können gegen Vorkasse erworben werden". Unsere Adresse: Revell GmbH & Co. KG, Abteilung X, Henschelstr. 20-30, D-32257 Bünde. Dieser Direktservice gilt für die Länder: Deutschland, Benelux, Österreich, Frankreich, Großbritannien. Reklamationen aus den übrigen Ländern werden über die jeweiligen Distributoren abgewickelt. Bitte kontaktieren Sie Ihren Händler.

This Model Kit has been subject to extensive quality and weight checks during the manufacturing process to ensure it leaves our warehouse in perfect condition. We are only able to process applications for missing parts if the following procedure is followed. In all cases the following will be required before we are able to process any request: Original receipt (proof of purchase) original instruction sheets (will be returned) and the bar code cut out of the box. We may not be able to process requests for products that have been discontinued for more than 24 months. Products that are returned directly to us without prior authorisation by a company representative will not be accepted and returned to sender. Replacement parts for conversion or spares will continue to be available however they will incur a handling charge. Please write to: Department X Revell GmbH & Co. KG, Henschelstr 20-30, D-32257 Bünde. This direct service is only available in the following markets: Germany, Benelux, Austria, France & Great Britain, Revell GmbH & Co. KG, Orchard Mews, 18c High Street, Tring Herts. HP23 5AH, Great Britain. For all other markets please contact your local dealer or distributor directly.

N: Ha alltid vedlagt sikkerhetstekst klar til bruk.

RUS: Соблюдать прилагаемый текст по технике безопасности, хранить его в легко доступном месте.

PL: Stosować si do załączonej karty bezpieczeństwa i mieć ją stale do wglądu.

GR: ροσ ξτε τις συνημμ ves υποδείξεις ασ άλειας και υλάτε τις τοι ώστε να τις χτε παντα σε διαθ ση ασς.

TR: Ekteki güvenli talimatların dikkate alıp, bakabileceğiniz bir şekilde muafaza ediniz.

CZ: Dbejte na pfiilolen "bezpeanostni text a mjte jej pfiipraven" na dosah.

H: A mellékelt biztons-gi szöveget vegye figyelembe és tartsa fellapoz-sra készen!

SLO: Pridloena varnostna navodila izvajajte in jih hranite na vsem dostopnem mestu.

Afin de vous donner entière satisfaction et pour nous assurer que tous les éléments nécessaires au montage de votre maquette sont présents dans la boîte, cet article a subi dans son intégralité divers contrôles qualitatifs ainsi que des contrôles de poids. Si toutefois vous deviez nous faire part de certaines réclamations, nous vous prions de bien vouloir vous adresser à votre revendeur habituel, muni de la notice de montage, du code EAN découpé sur la boîte, ainsi que de votre ticket de caisse. Le SAV ne sera assuré que pour les articles ayant été acquis depuis moins de 24 mois. Les pièces de rechange utilisées pour la transformation de maquettes pourront être obtenues en pré-paiement. Dans le cas où vous n'obtiendriez pas satisfaction, vous pouvez vous adresser directement à notre service SAV à l'adresse suivante: REVELL GmbH & Co. KG, Abteilung X, Henschelstraße 20-30, D-32257 Bünde ou Revell GmbH & Co. KG, 14 B, rue du Chapeau Rouge, F-21000 Dijon, France. Pour tous les autres marchés, merci de prendre contact avec votre détaillant ou distributeur.

Deze bouwdoos werd verscheidene malen volledig gecontroleerd op kwaliteit en gewicht. Klachten kunnen slechts in behandeling worden genomen indien de bouwhandleiding, de uit de doos geknipte EAN - streepjescode en de kassabon zijn meegezonden. Wij vragen om uw begrip dat wij alleen garantie kunnen geven voor huidige artikelen die binnen een periode van de laatste 24 maanden zijn gekocht. Onvolledig ingezonden klachten kunnen niet in behandeling worden genomen. Onderdelen voor ombouw kunnen tegen vooruitbetaling gekocht worden. Ons adres is: Revell GmbH & Co. KG, Afdeling X, Henschelstrasse 20-30, D-32257 Bünde, Duitsland. Deze directe service geldt alleen voor de volgende landen: Duitsland, Benelux, Oostenrijk, Frankrijk, Groot Britannië. Klachten afkomstig uit overige landen worden via de eventuele lokale vertegenwoordigers van Revell afgewikkeld. Wij verzoeken u contact op te nemen met uw winkelier.

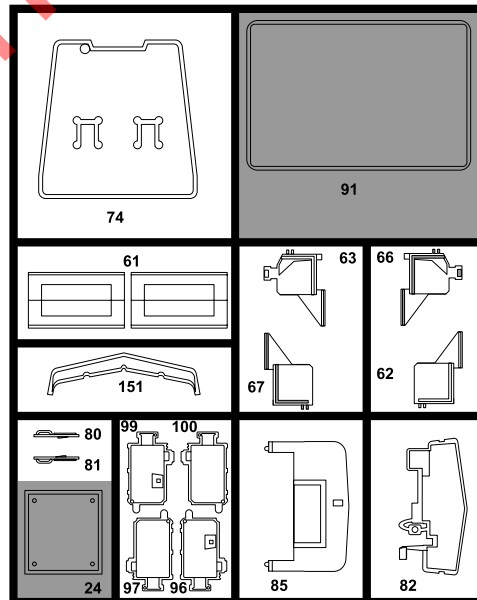
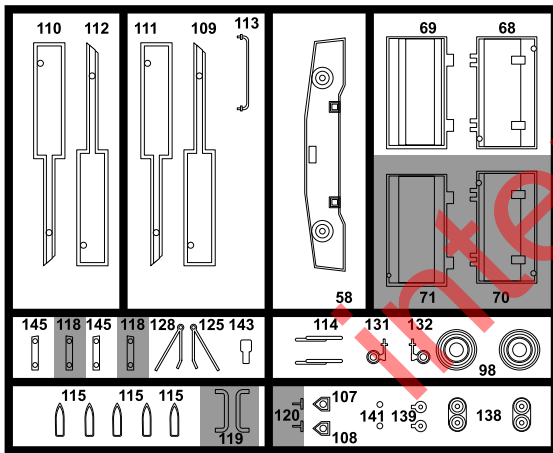
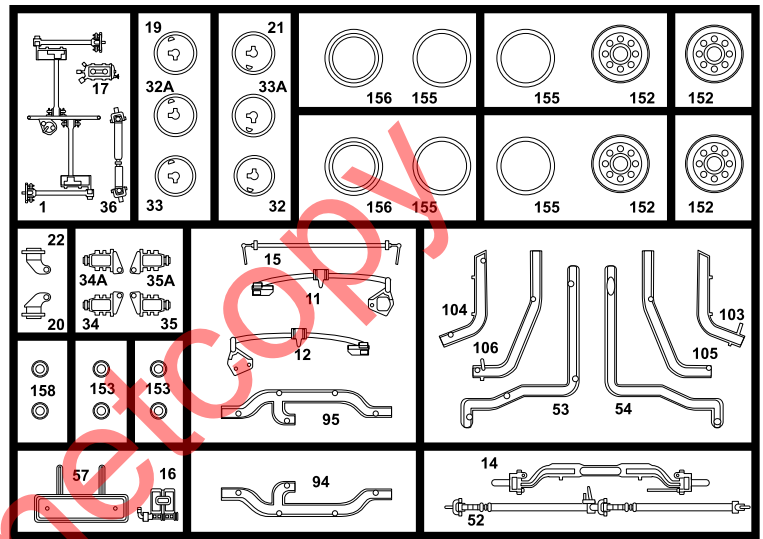
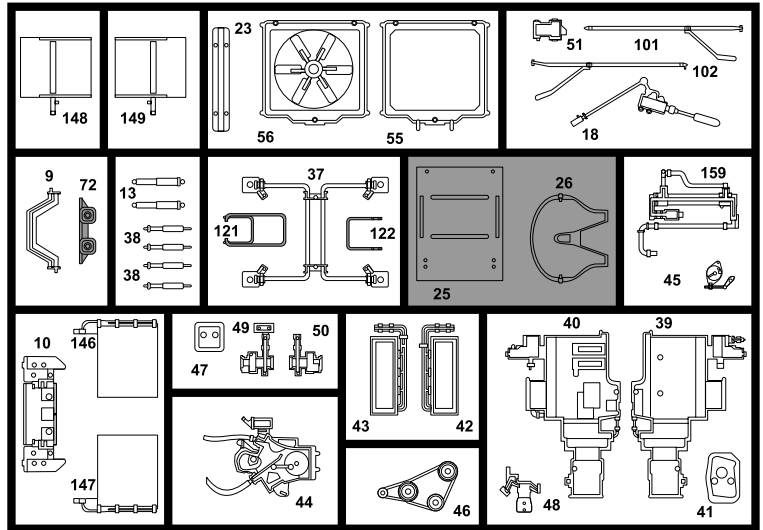
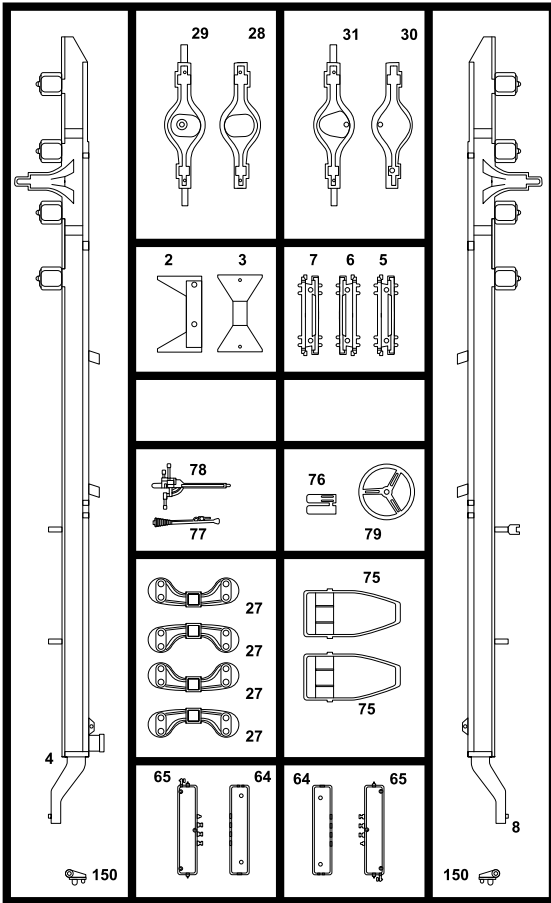

Nicht benötigte Teile
 Parts not used
 Pièces non utilisées
 Niet benodigde onderdelen
 Piezas no necesarias
 Peças não utilizadas
 Parti non usate
 Inte använda delar
 Tarpeettomat osat
 Ikke nødvendige dele
 Deler som ikke er nødvendige
 Неиспользованные детали
 Elementy niepotrzebne
 μη χρειαζούμενα εξαρτήματα
 Gereksiz parçalar
 Nepotrebné diely
 fel nem használt alkatrészek
 Nepotrební deli

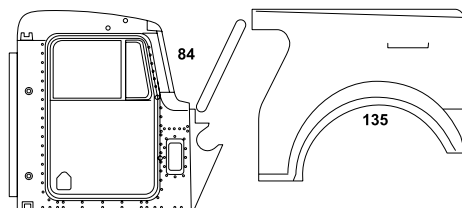
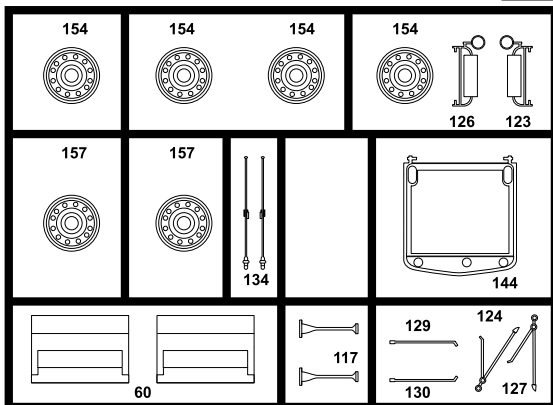

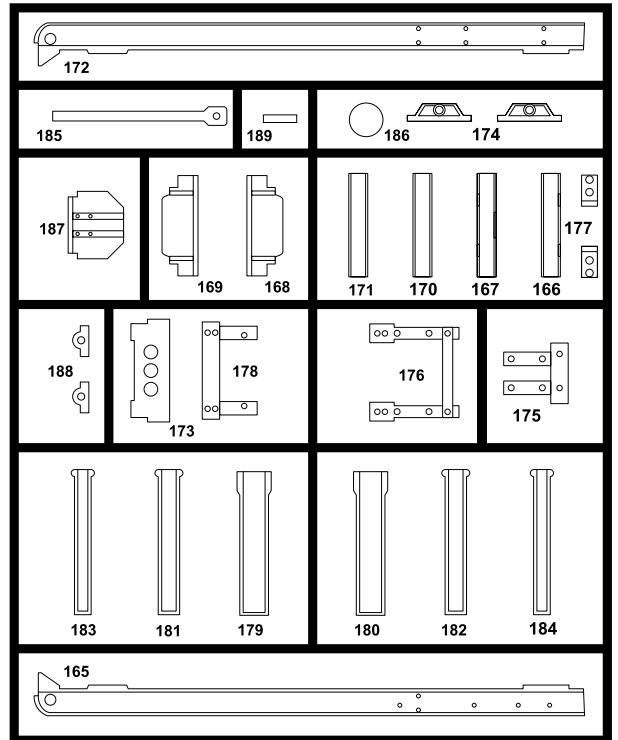
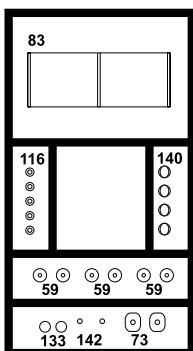
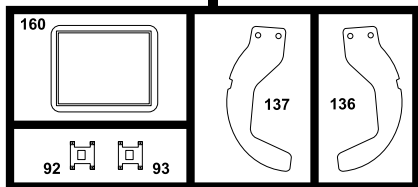
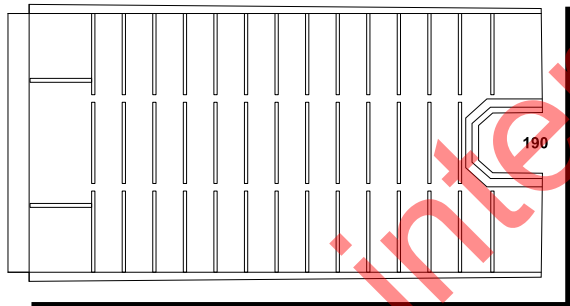
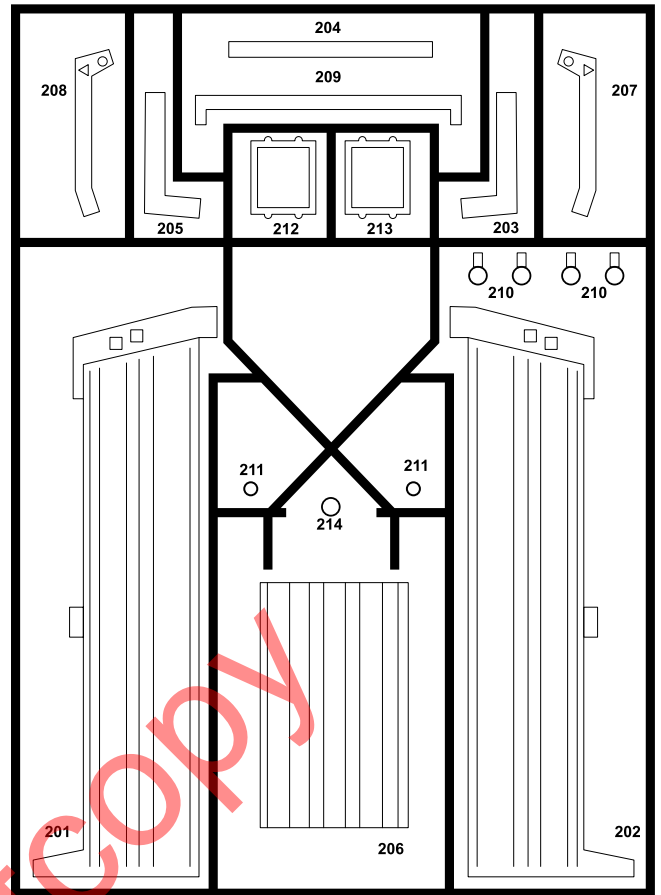
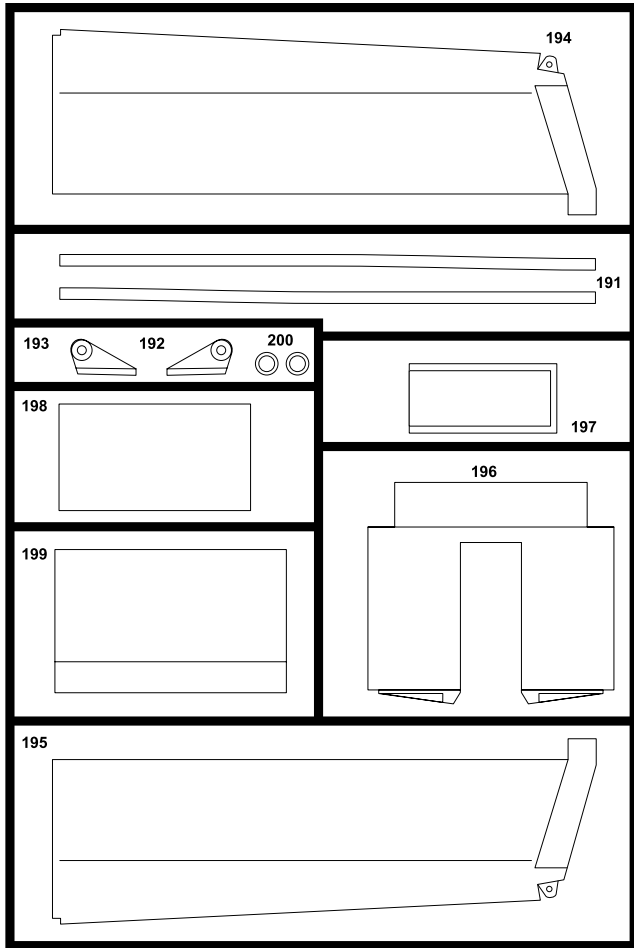

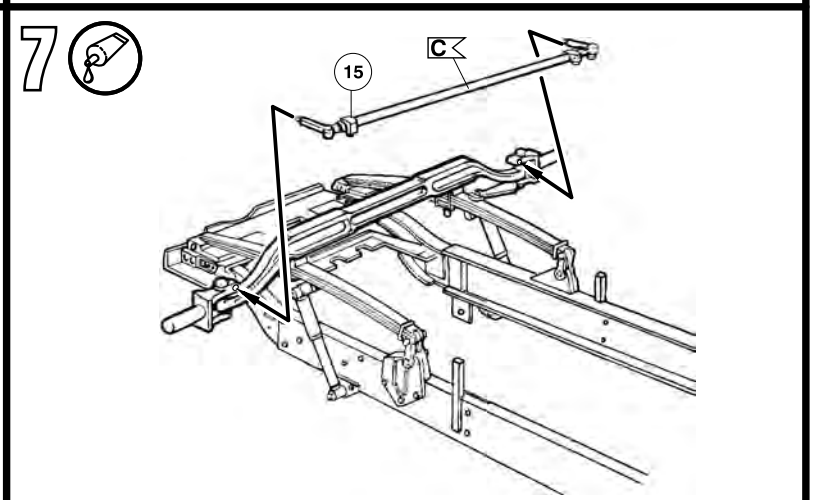
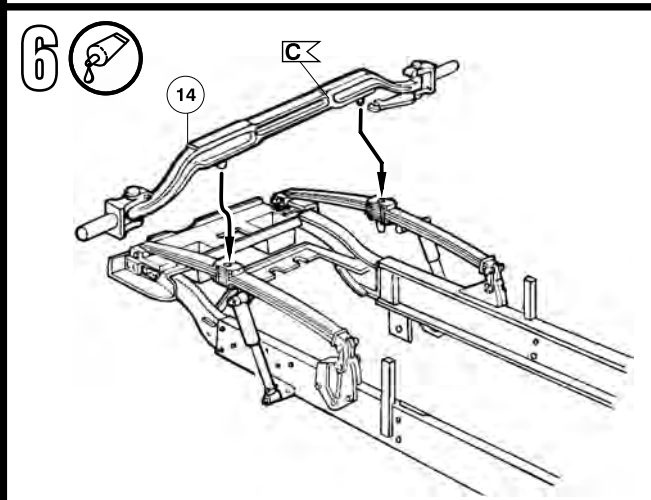
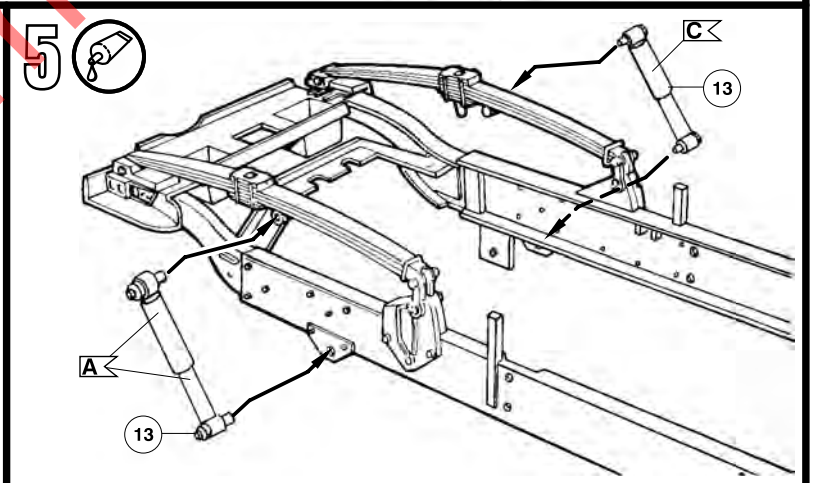
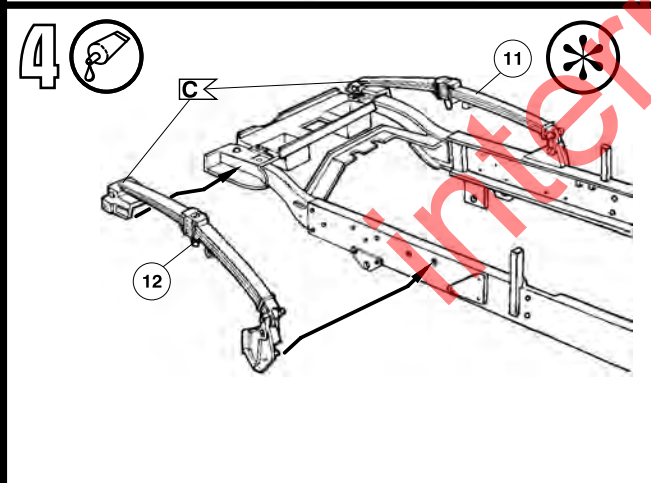
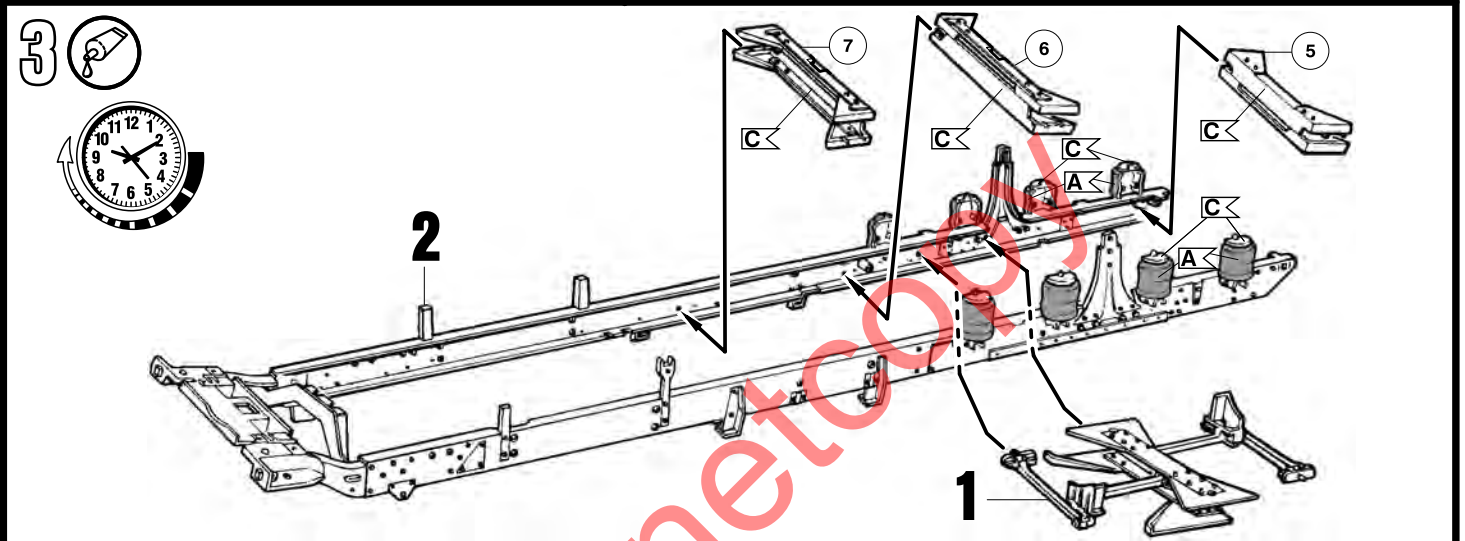
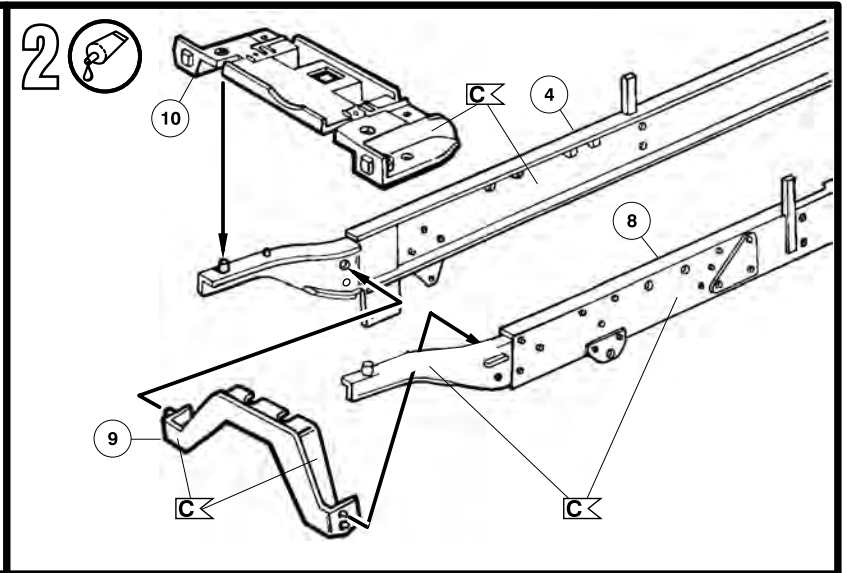
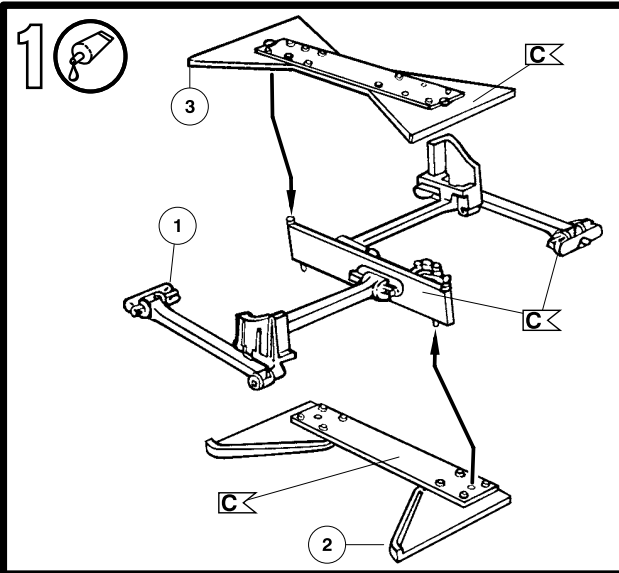

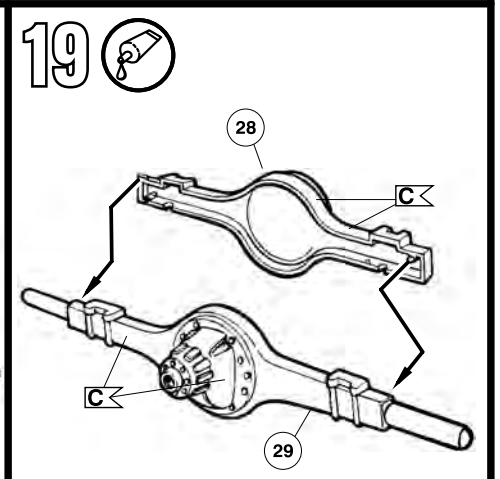
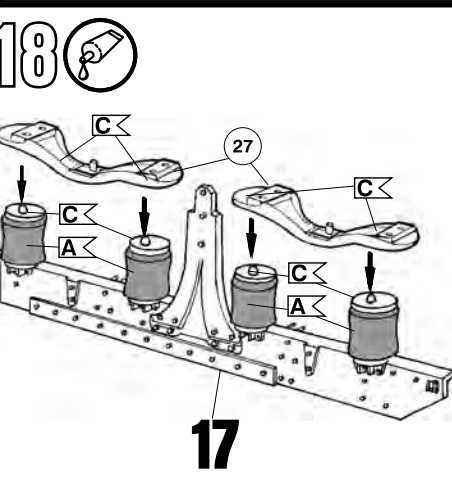
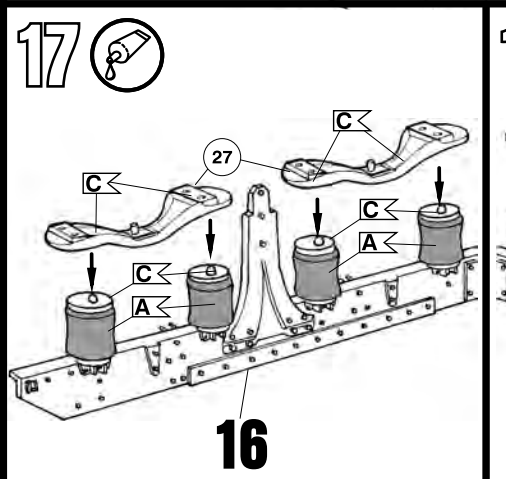
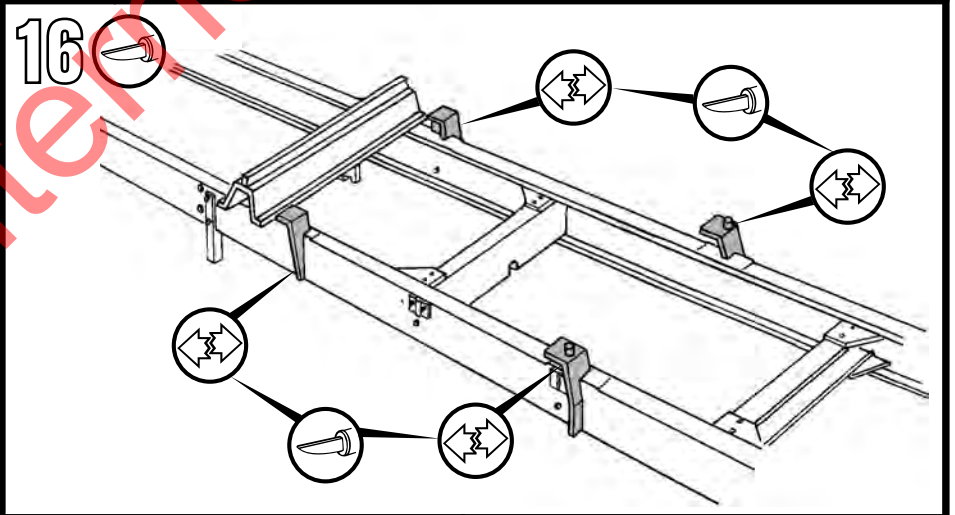
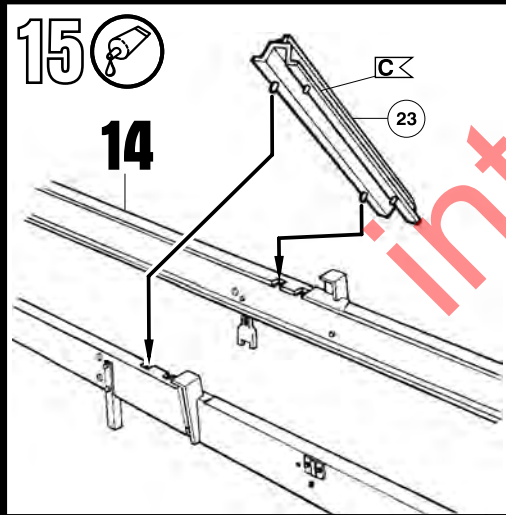
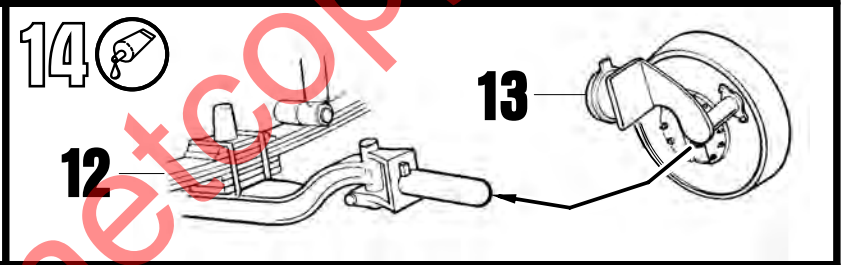
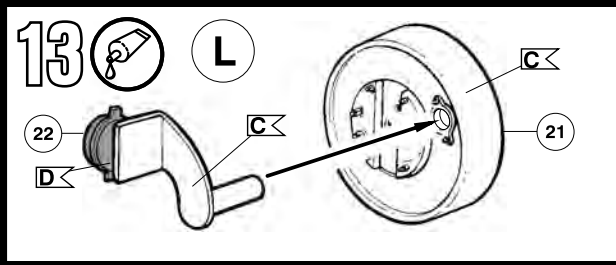
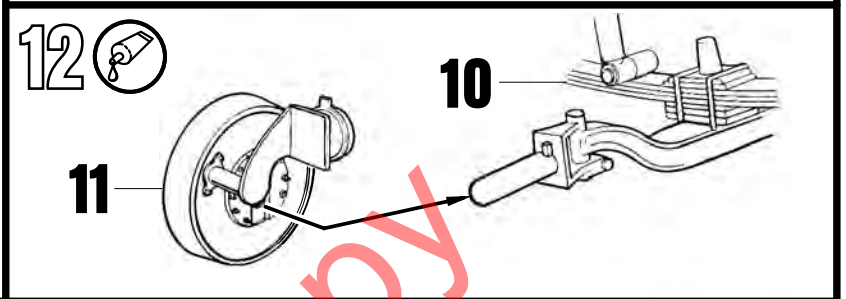
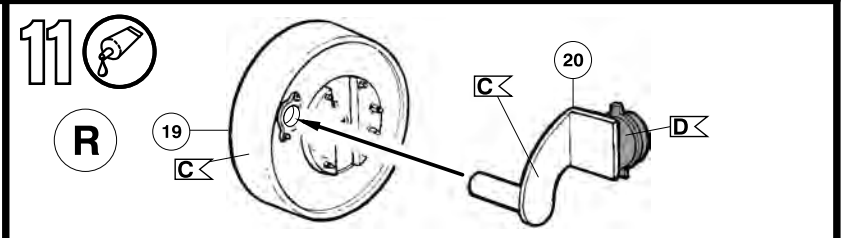
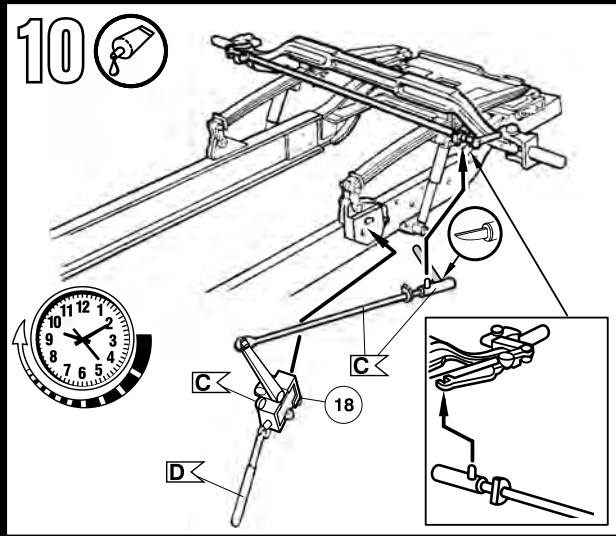
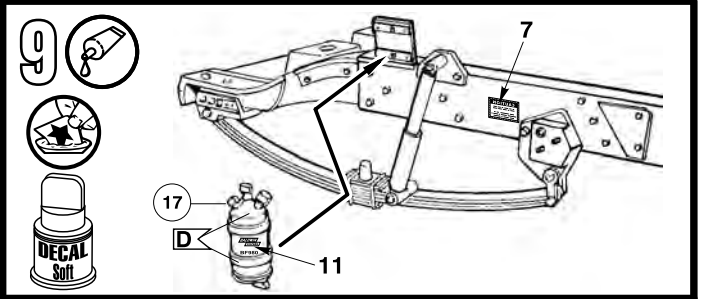
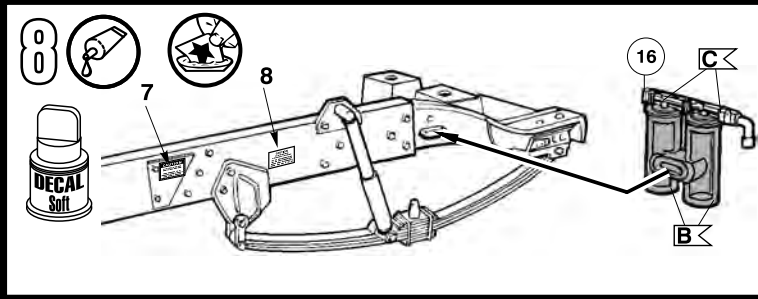

20 

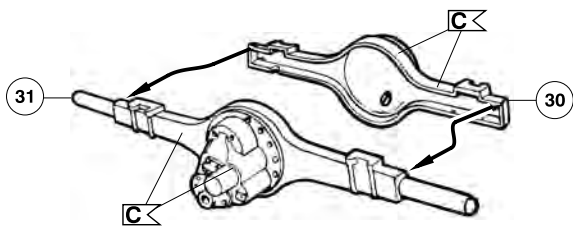

21 

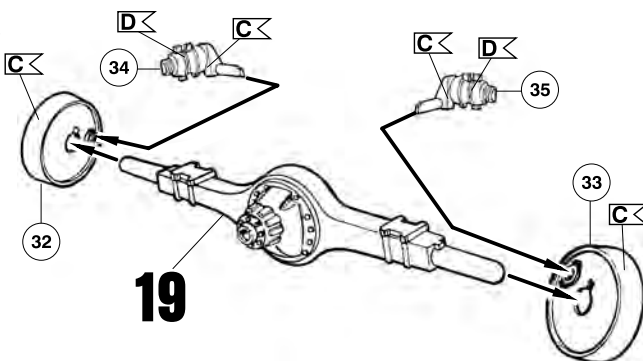

22 

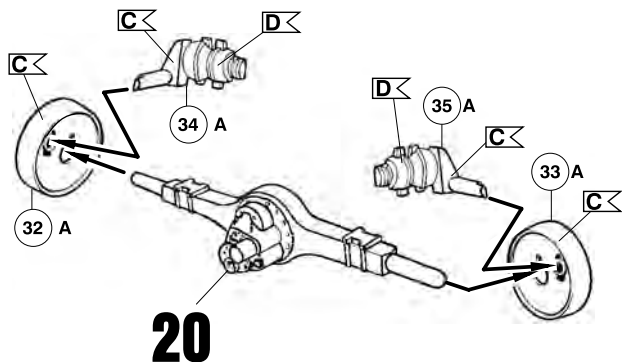

23 

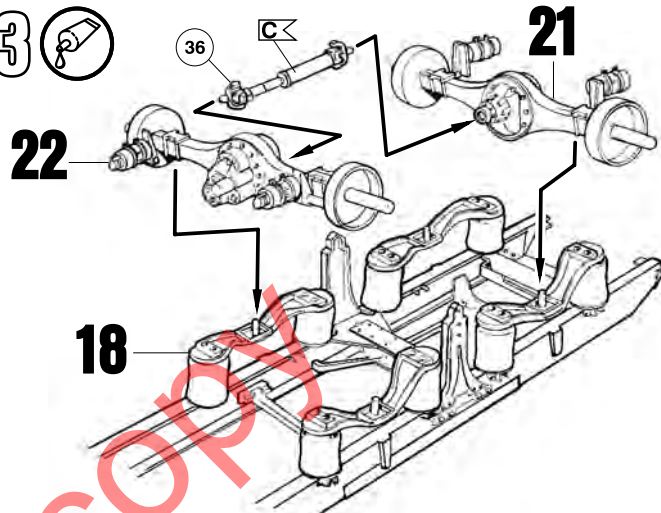

24 

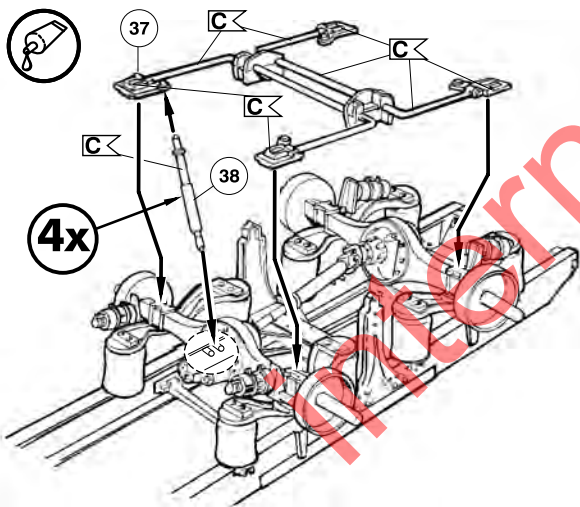

25 

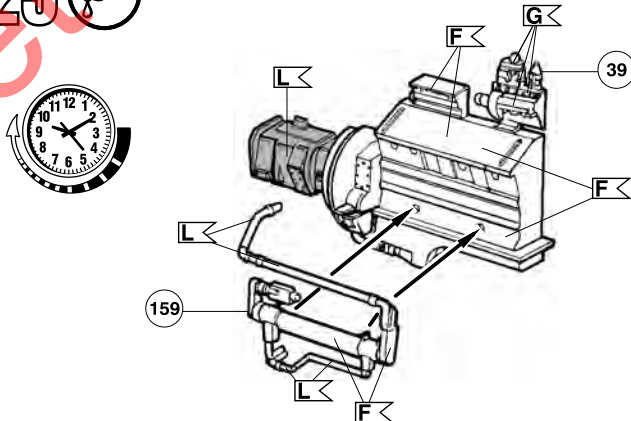

26 

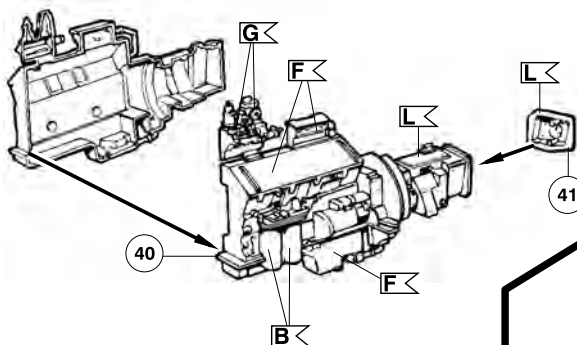

27  

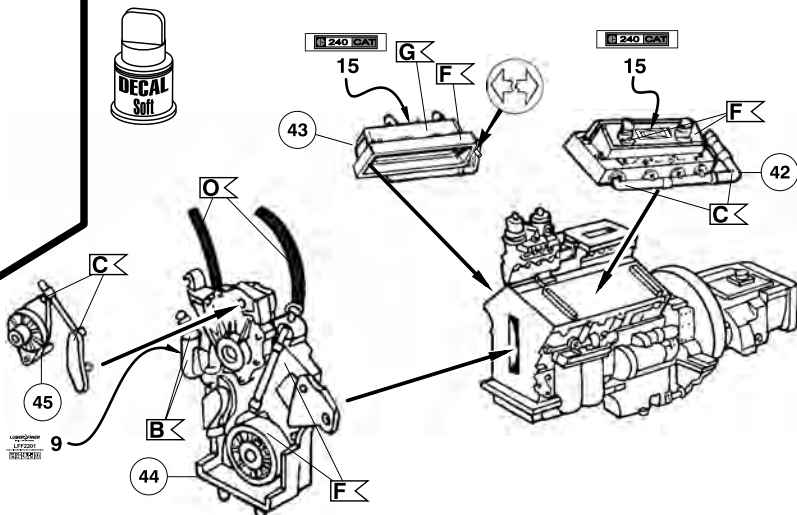

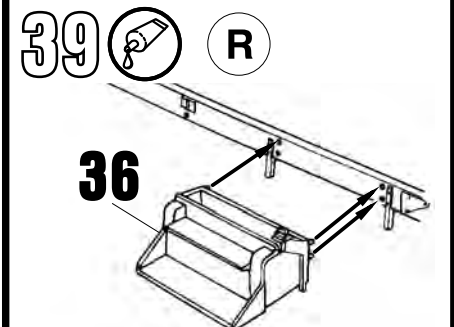
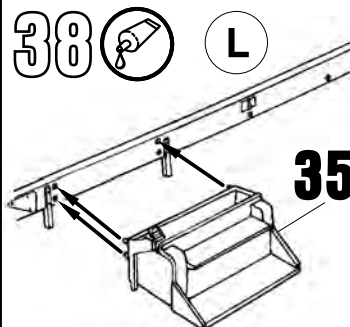
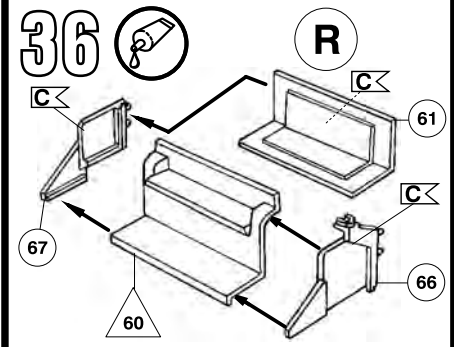
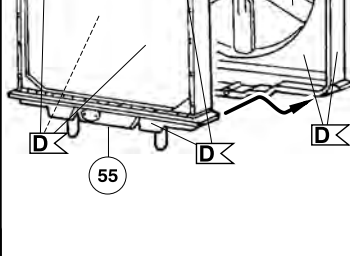
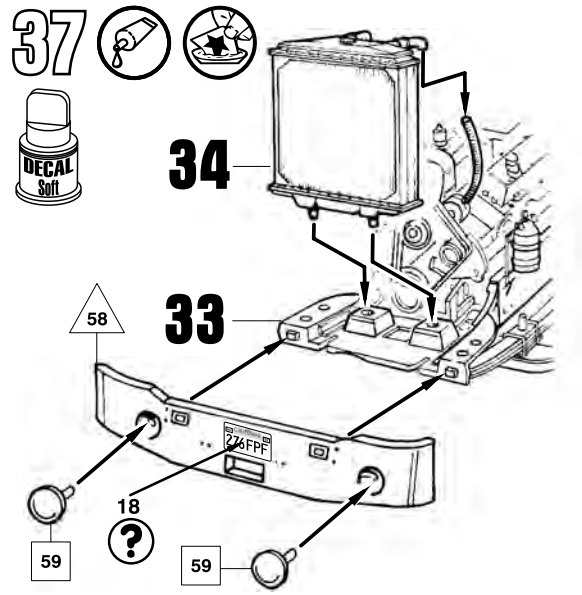
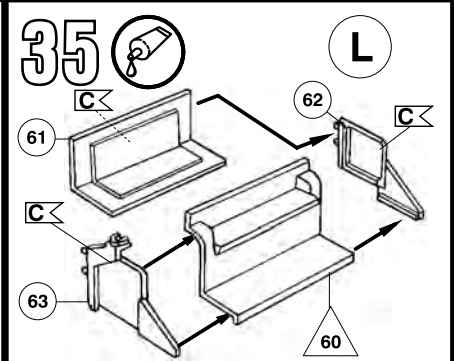
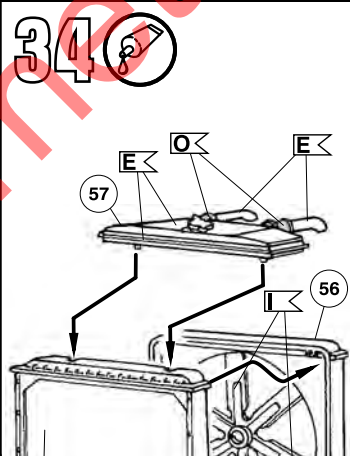
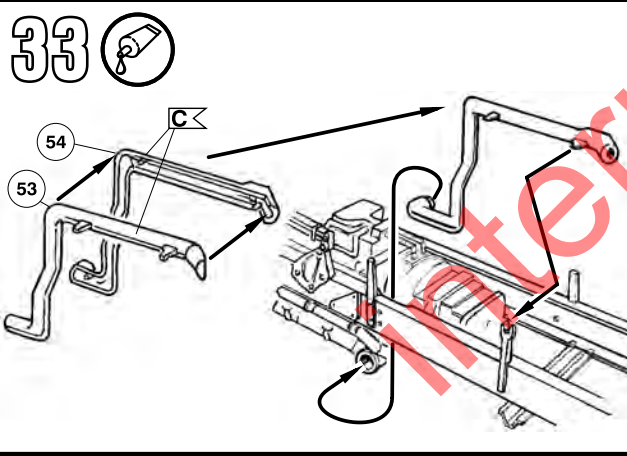
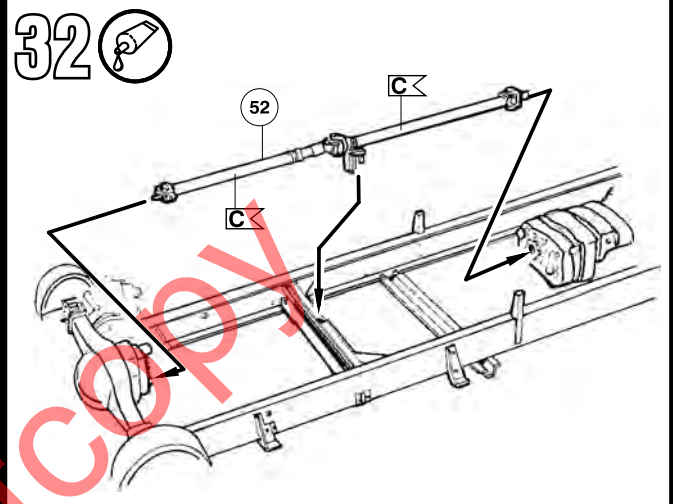
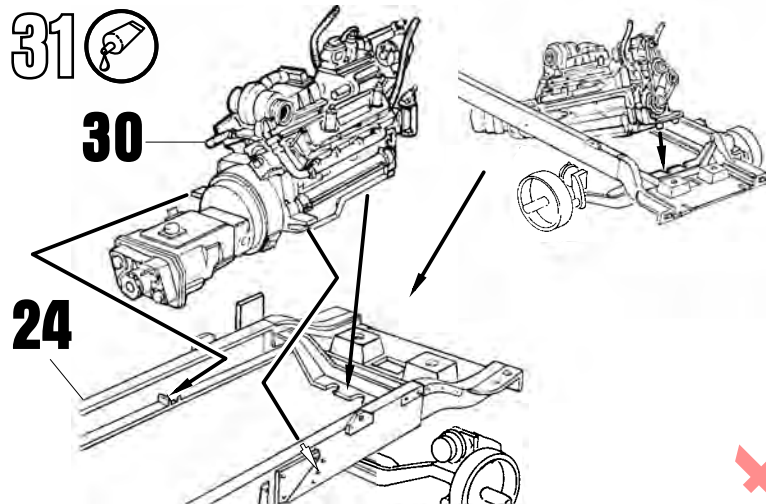
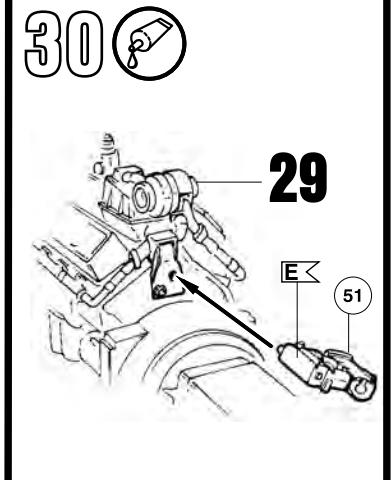
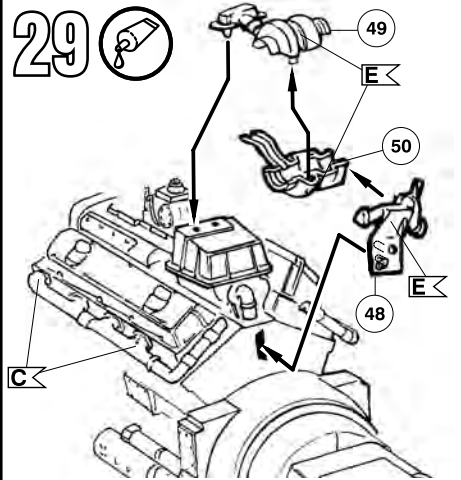
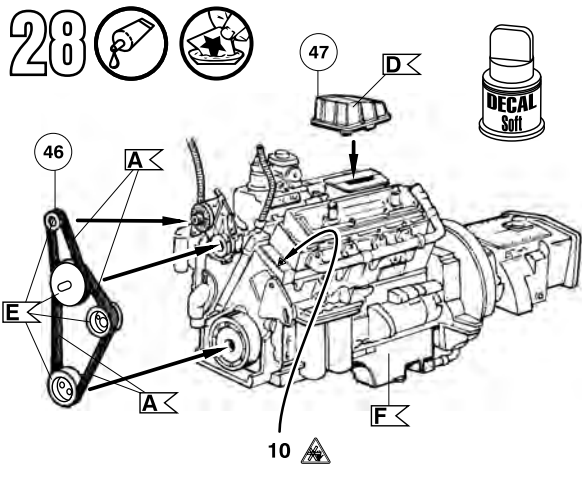

40

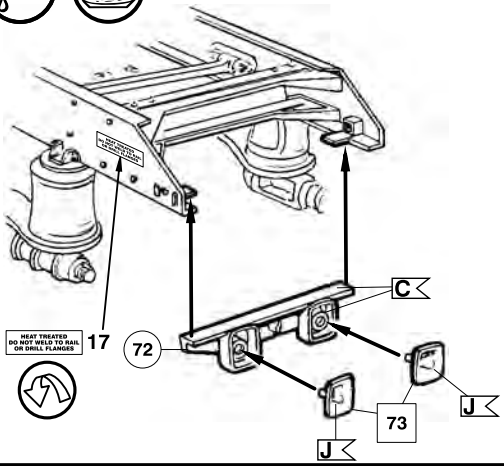

41

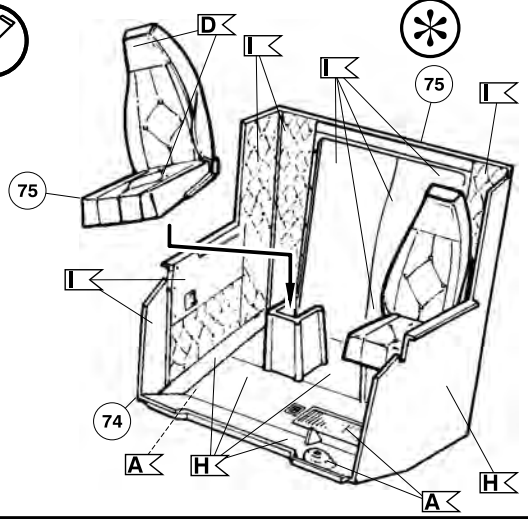

42

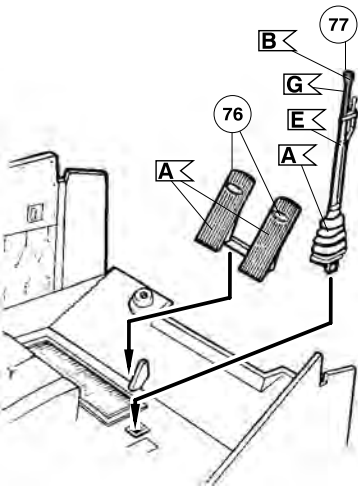

43

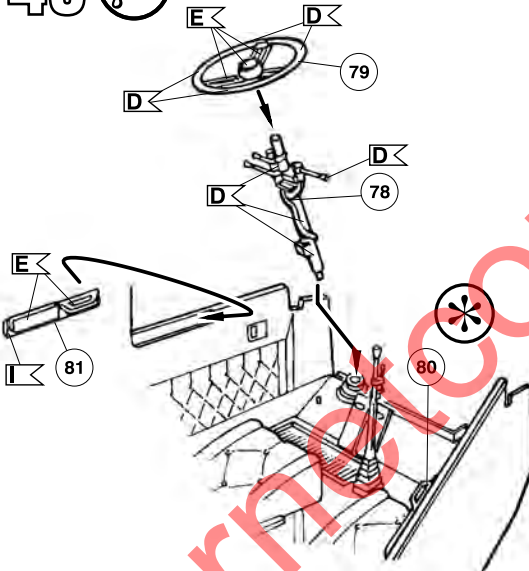

44

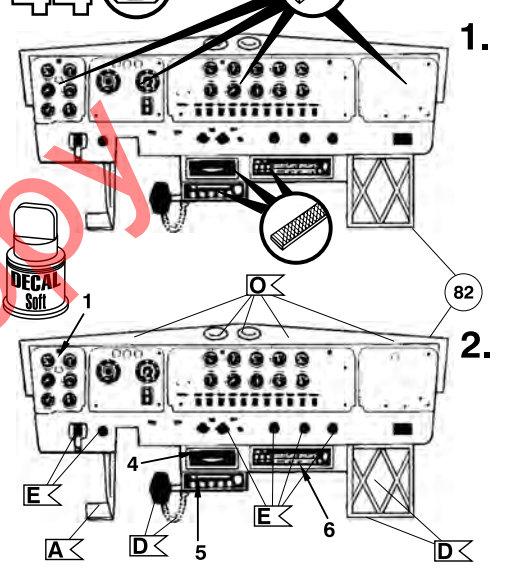

45

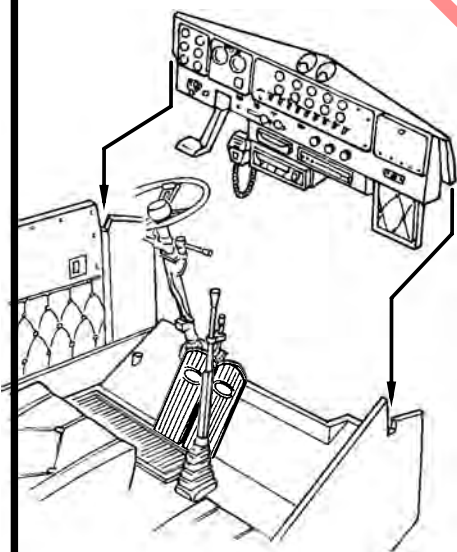

46

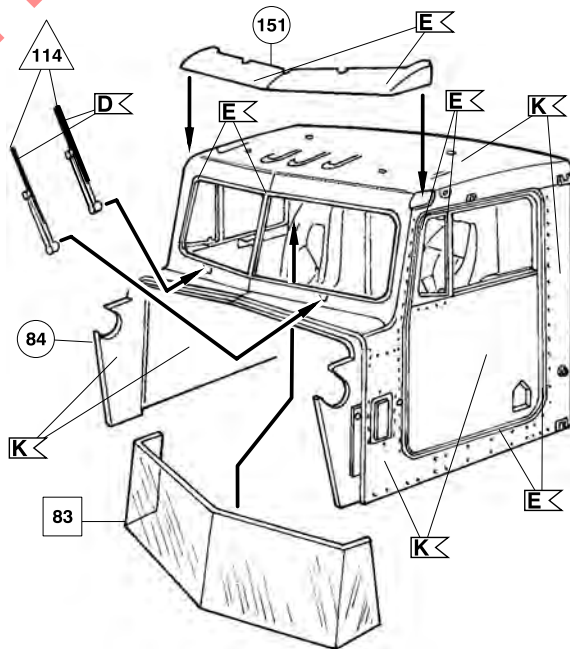

47

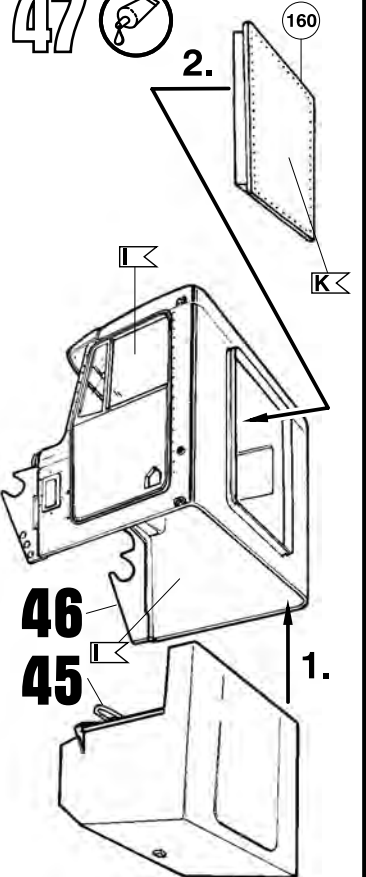

48

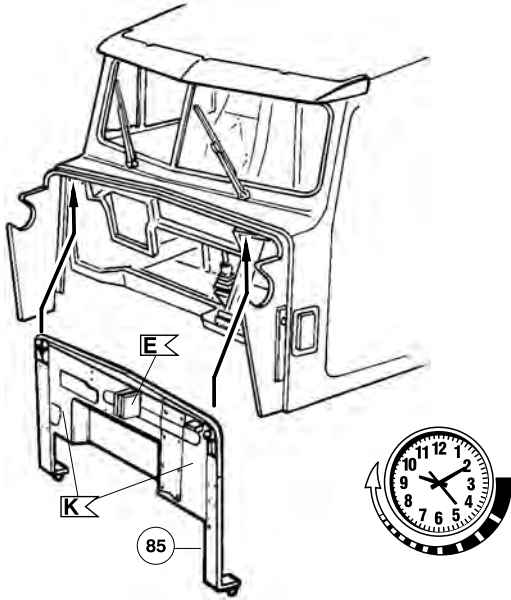

49

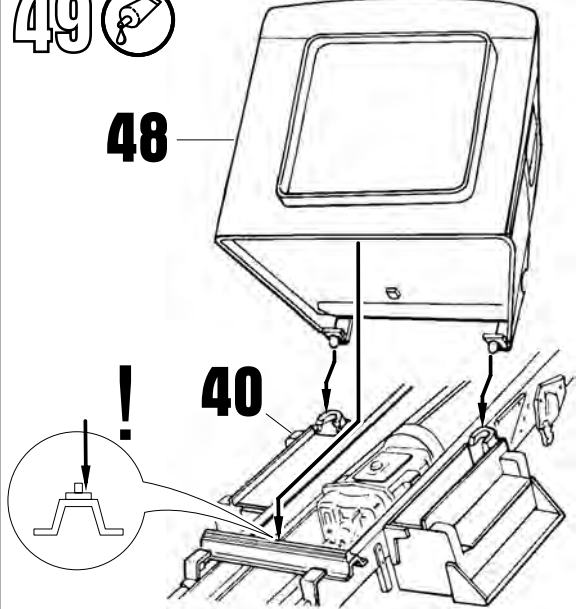

50

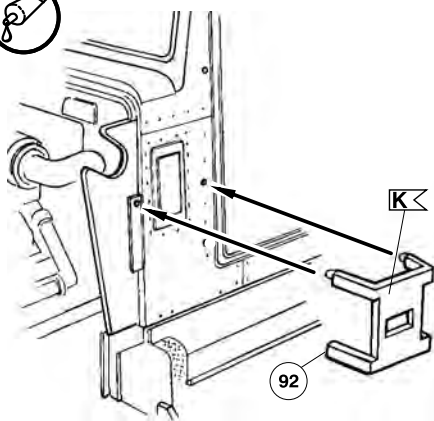

51

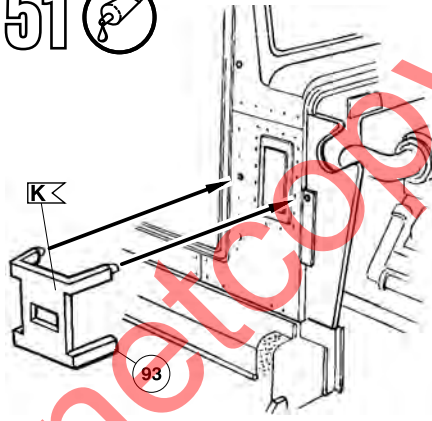

52

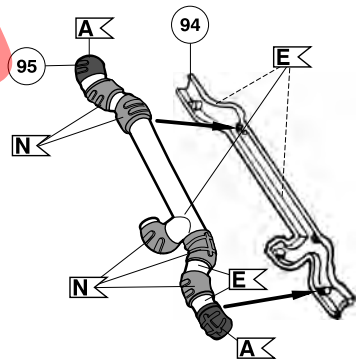

53

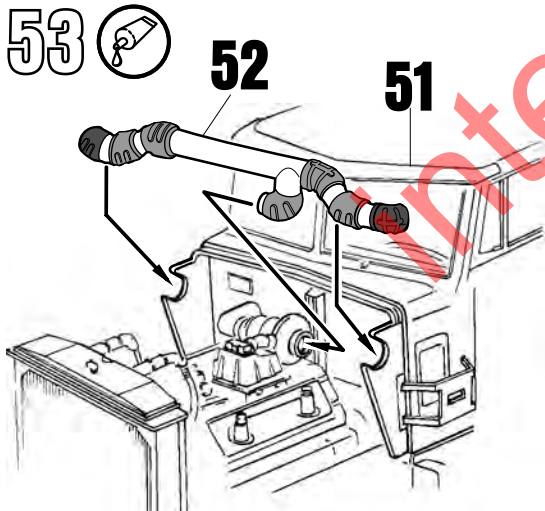

54

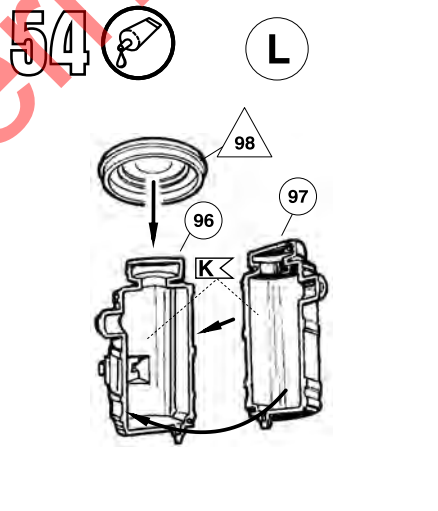

55

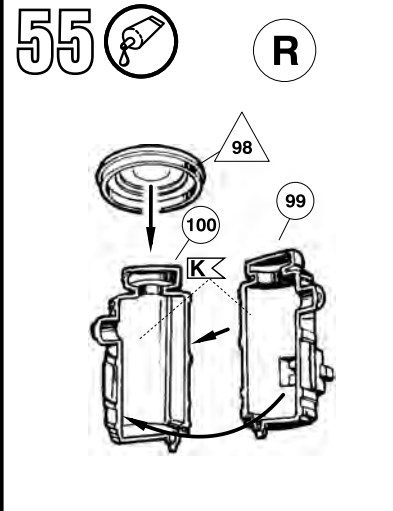

56

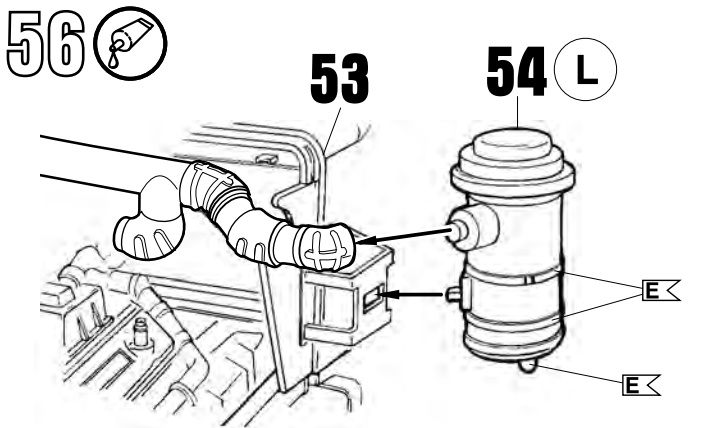

57

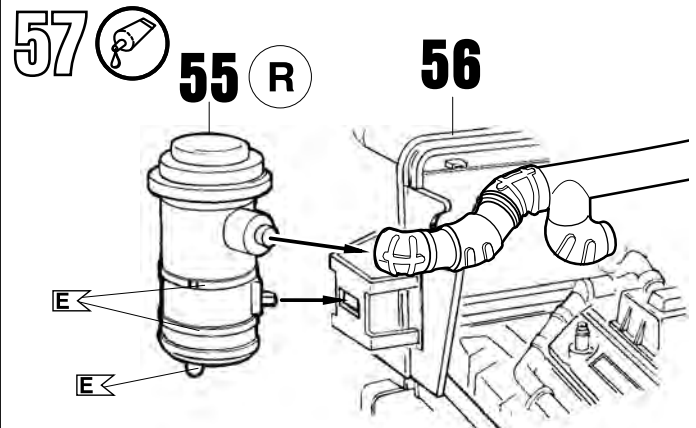

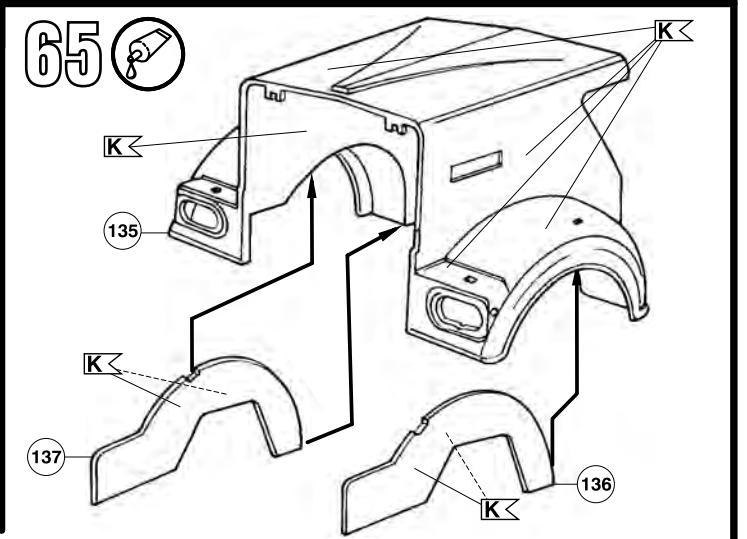
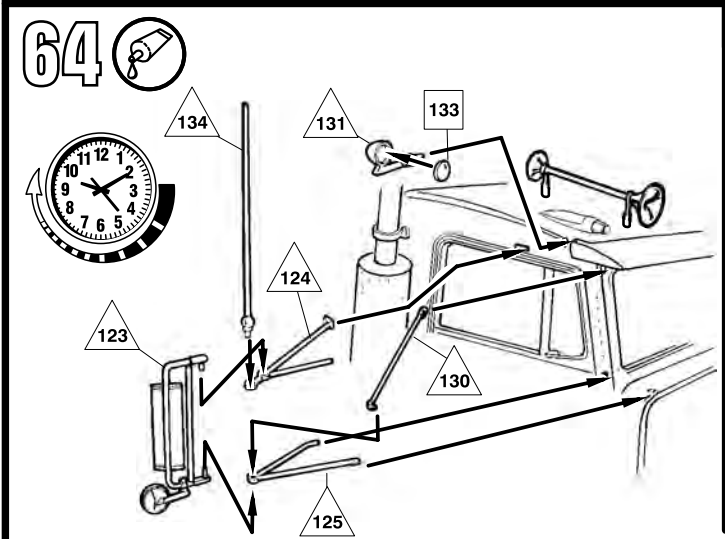
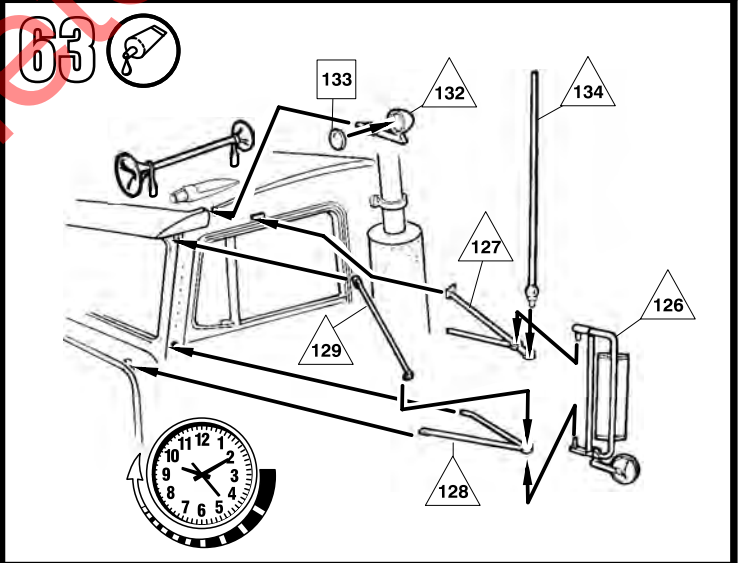
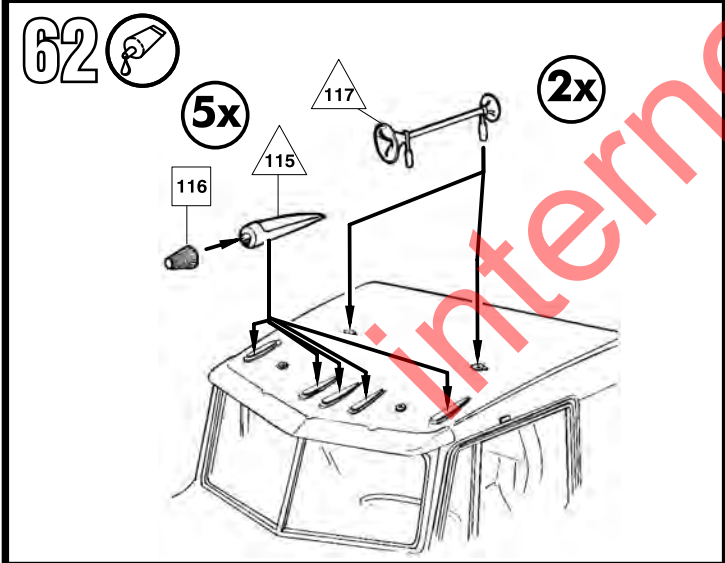
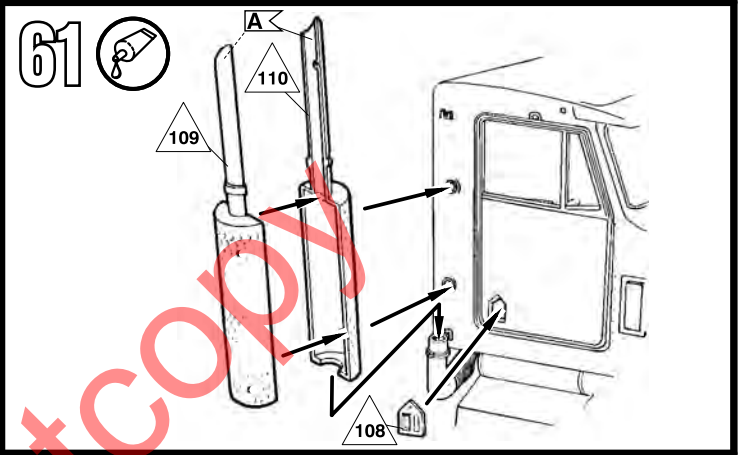
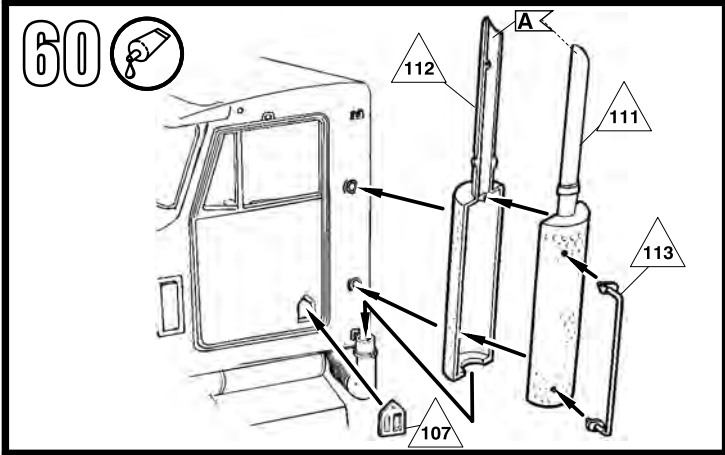
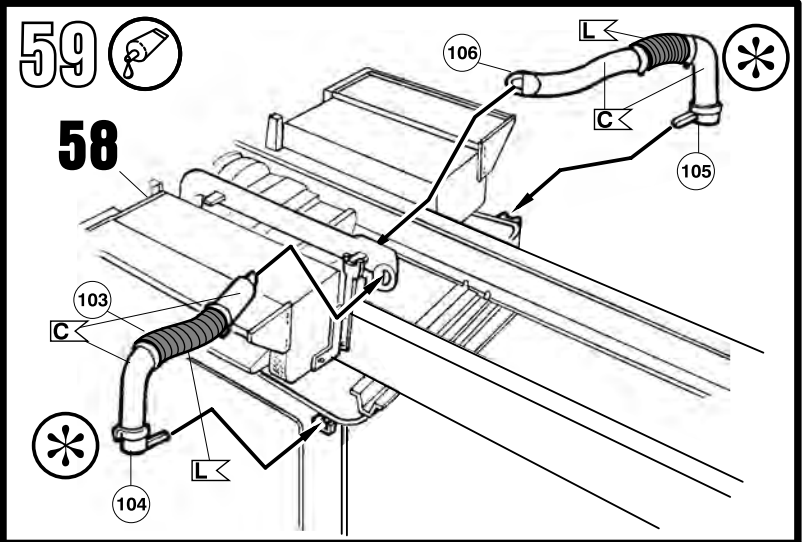
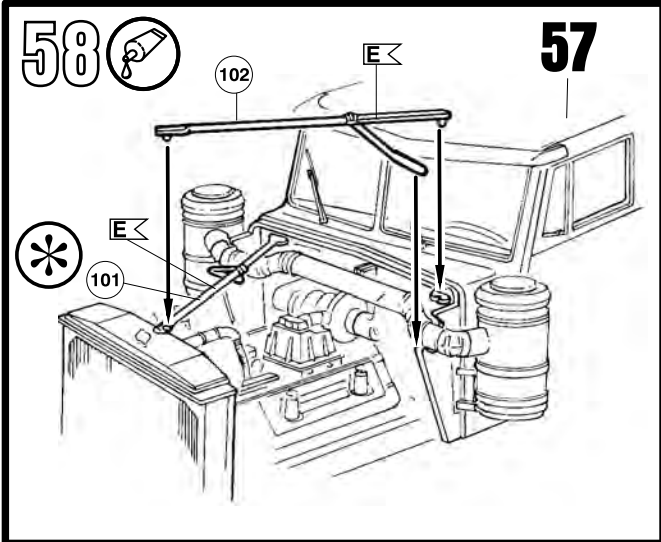

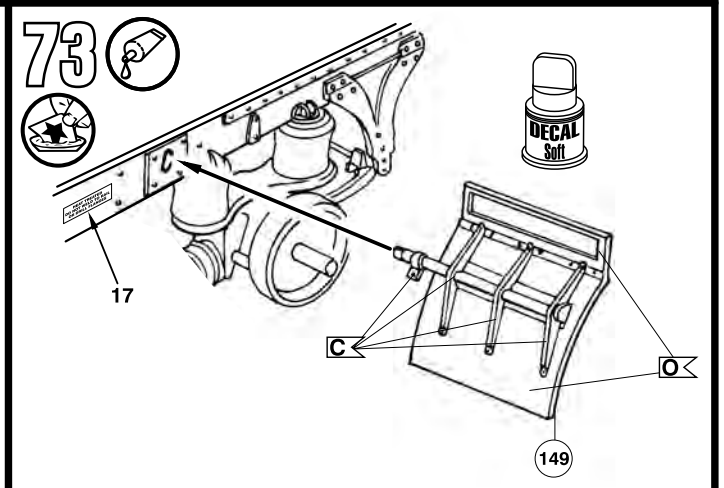
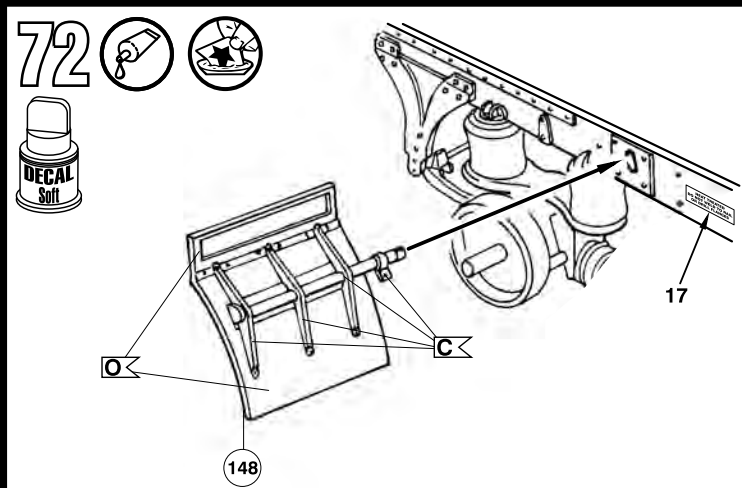
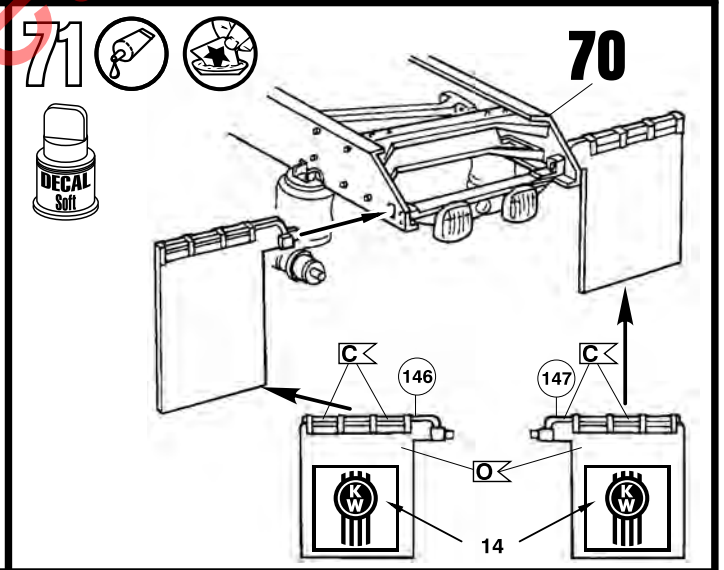
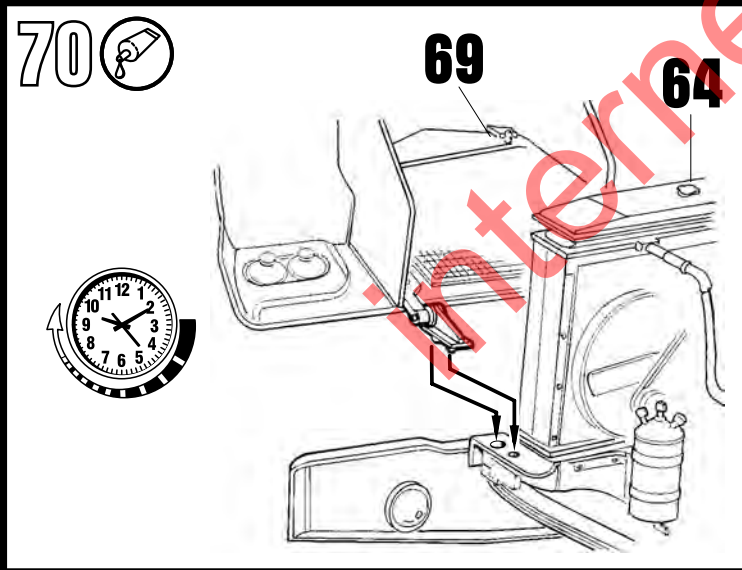
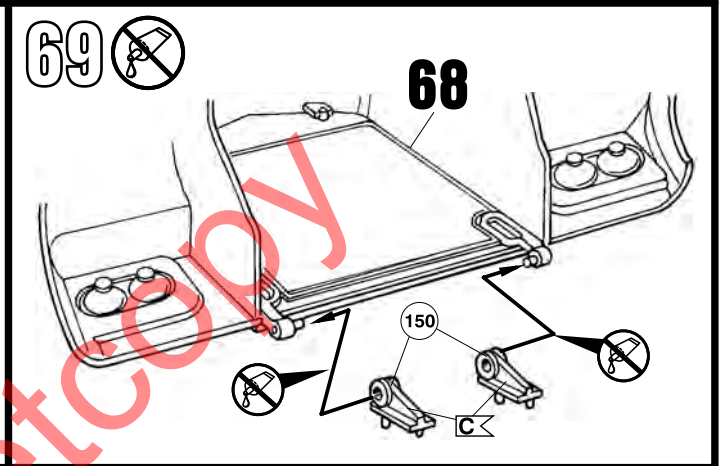
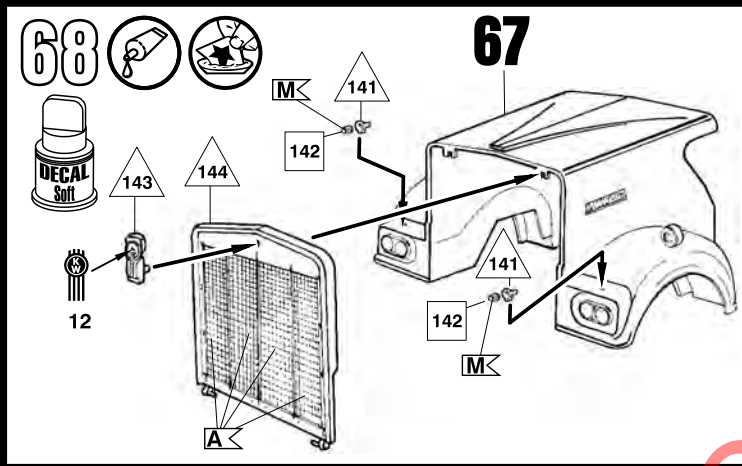
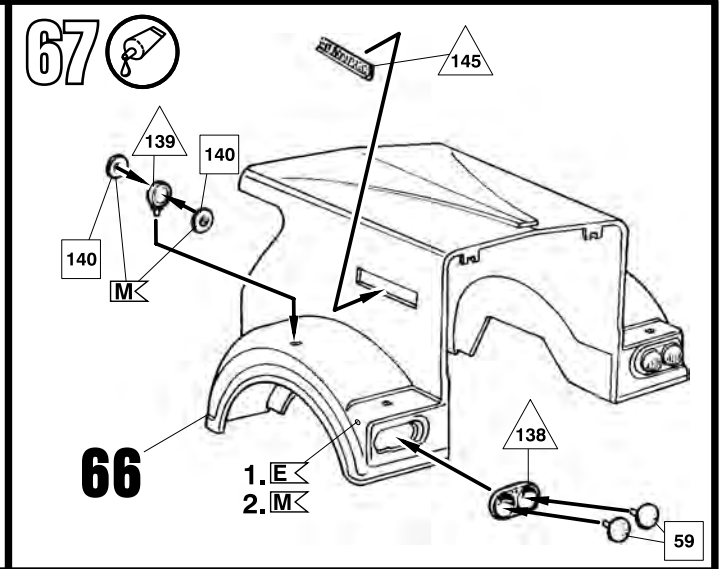
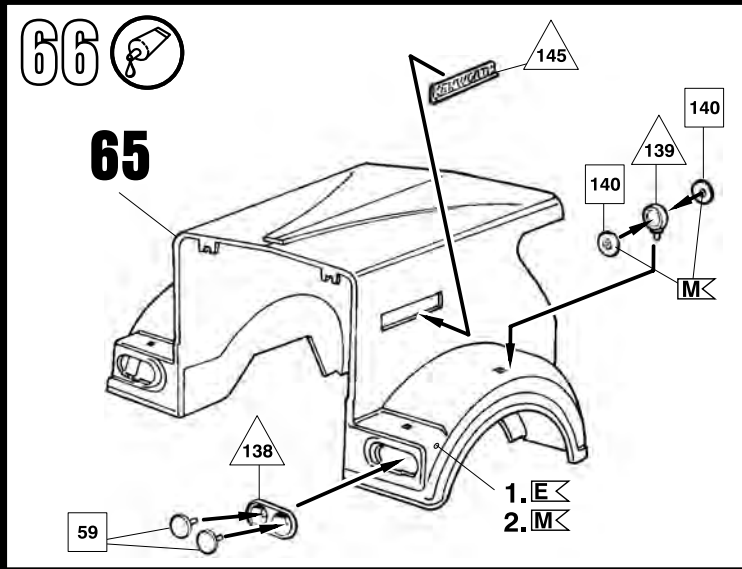

74



2x

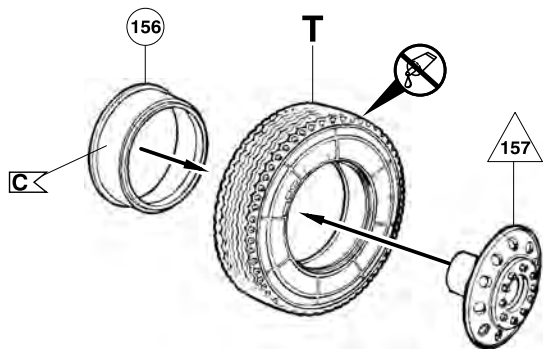

75

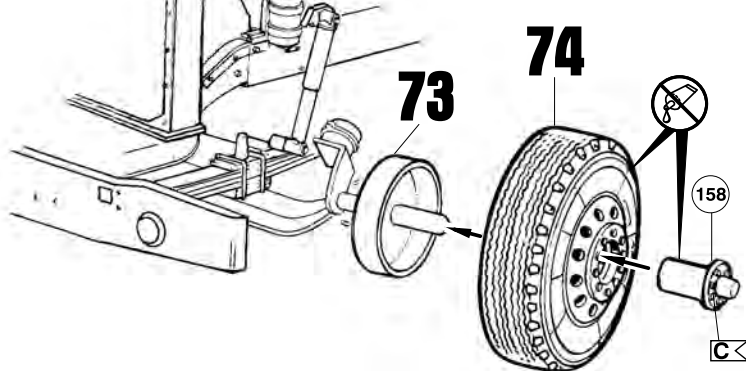

76

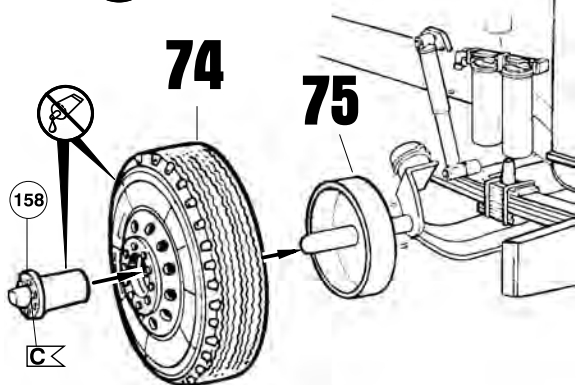

77



4x

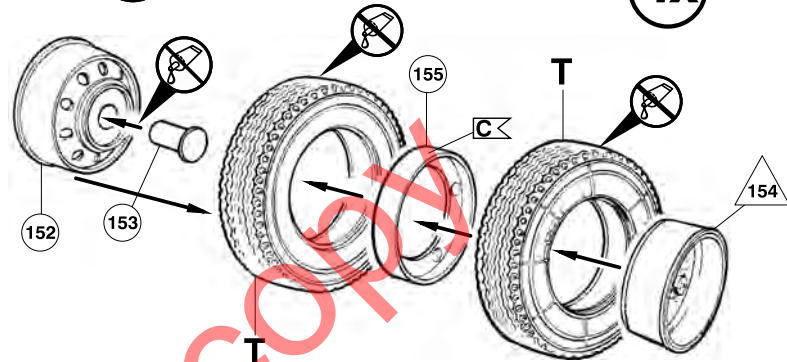

78



77 2x

76

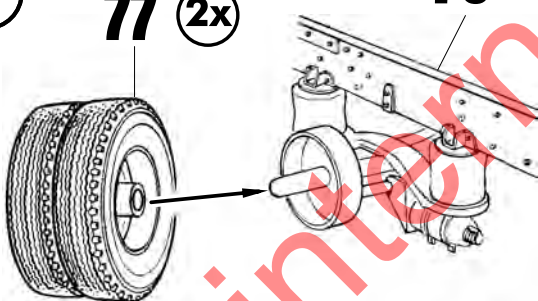

79



78

77 2x

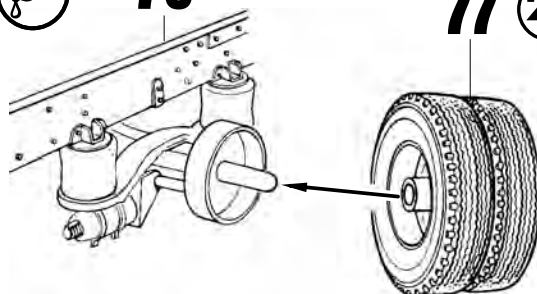

80

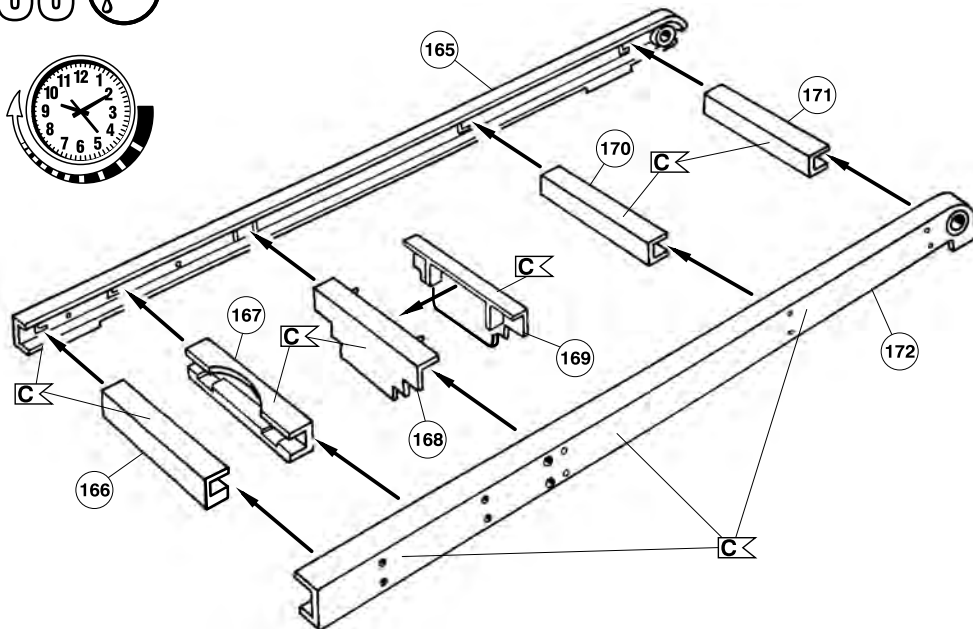

81

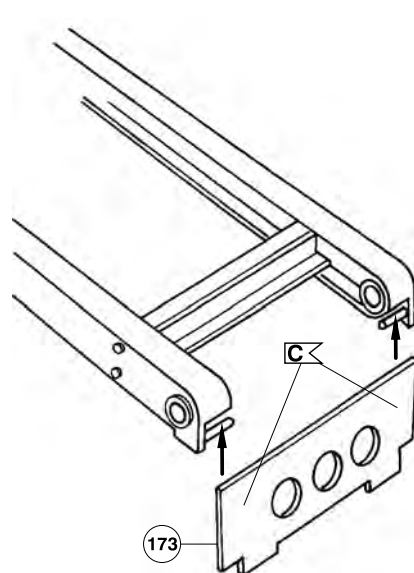

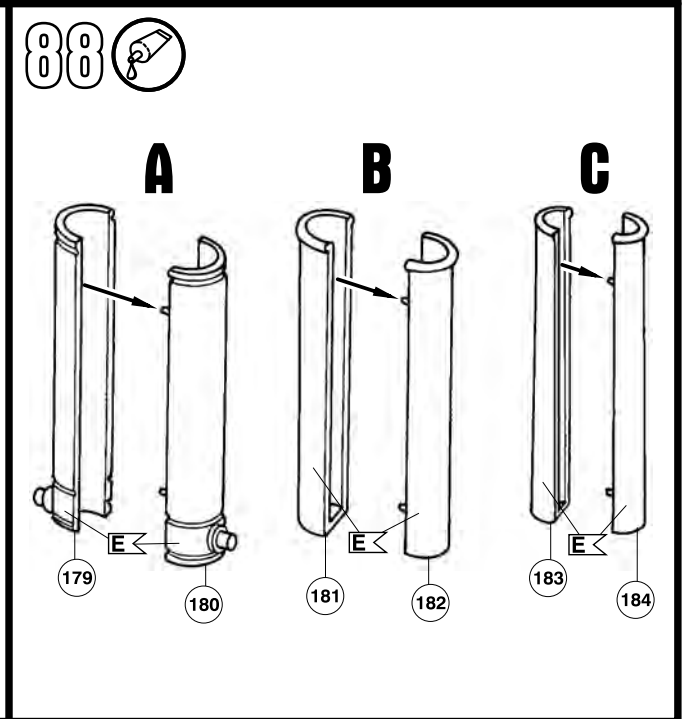
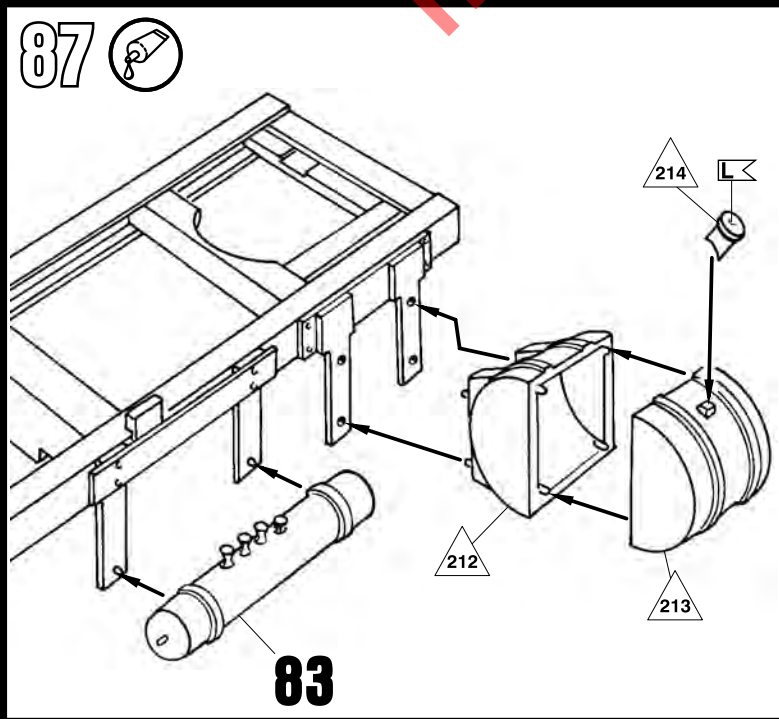
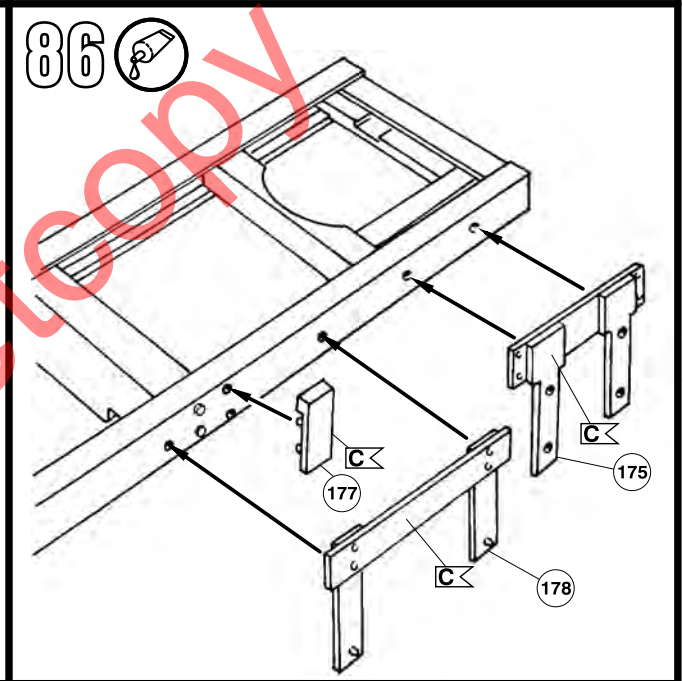
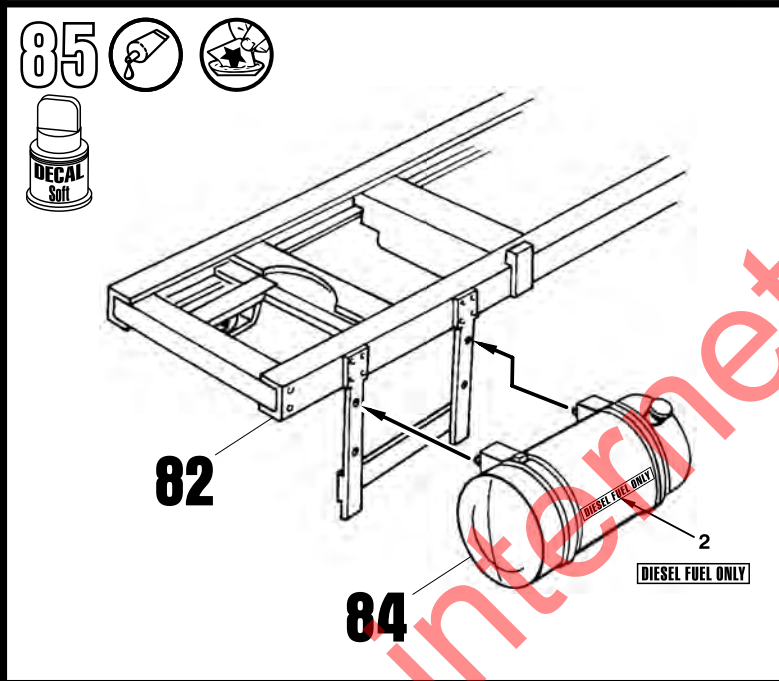
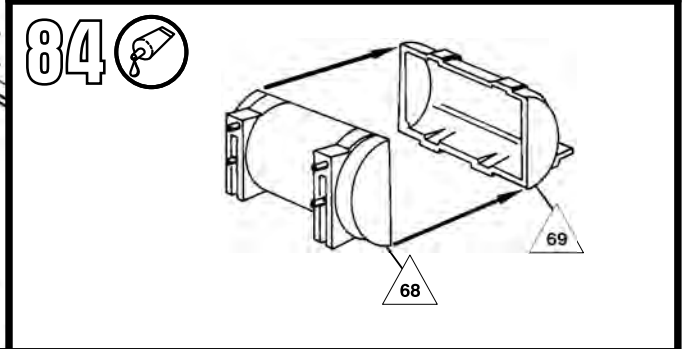
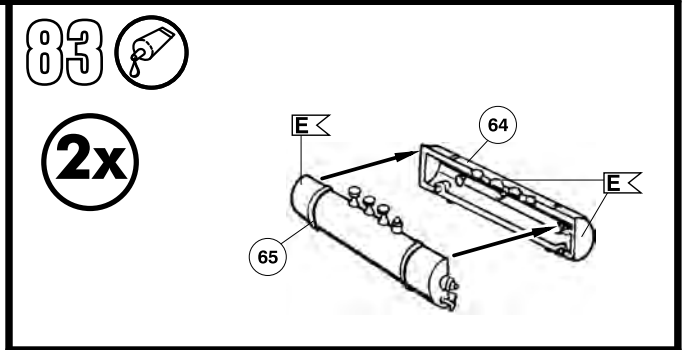
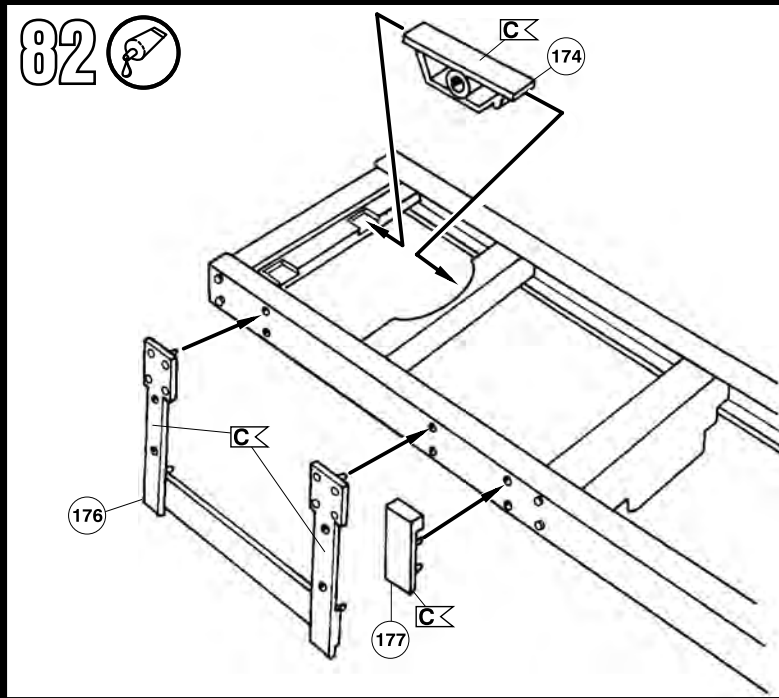

89 

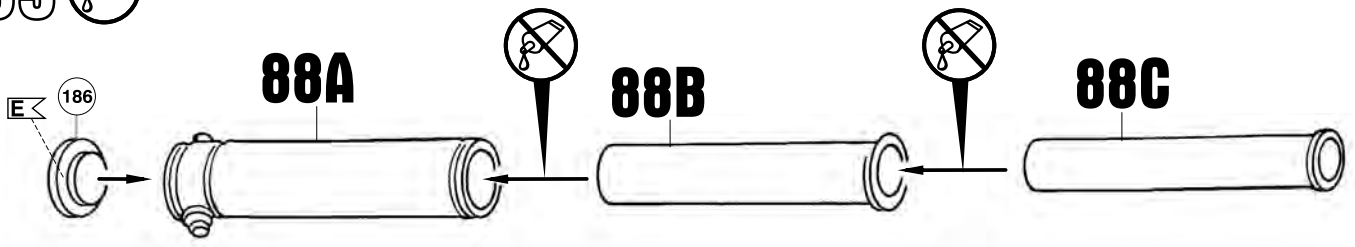

90 

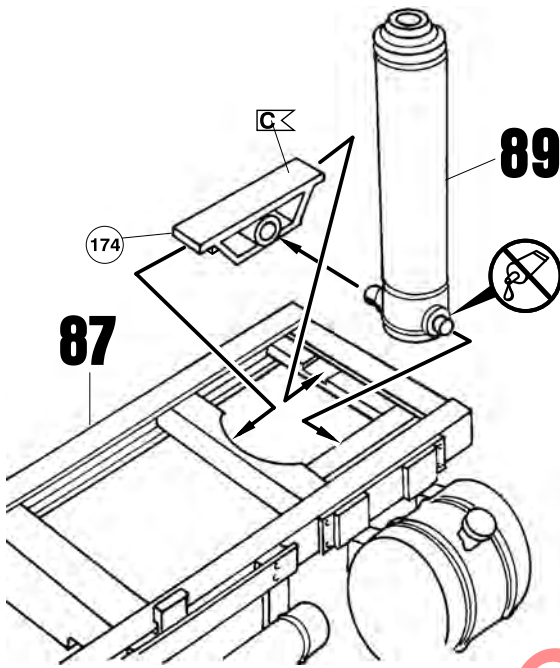

91 

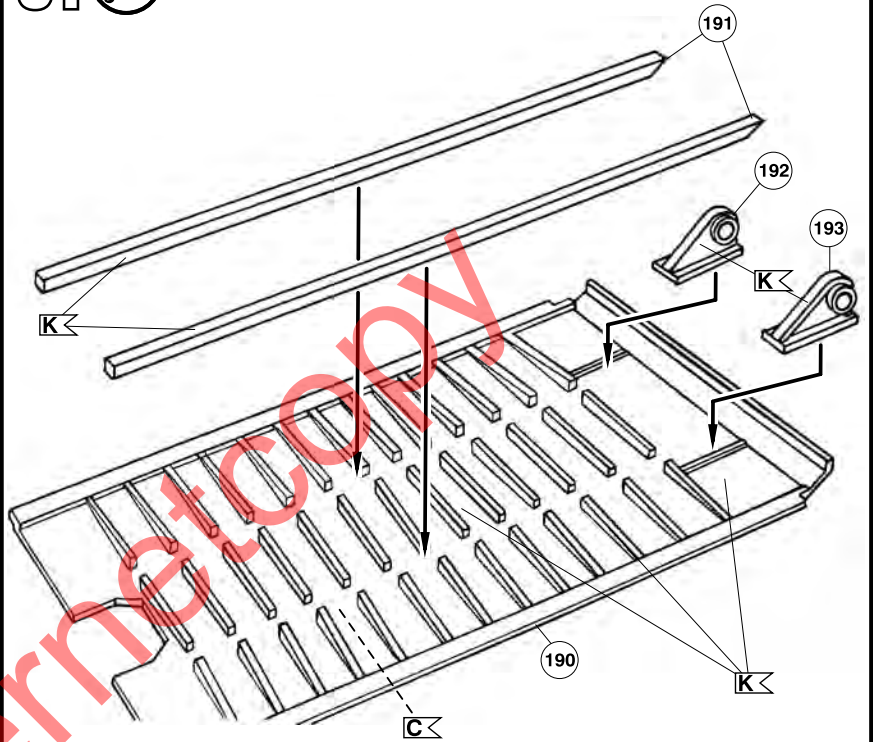

92 

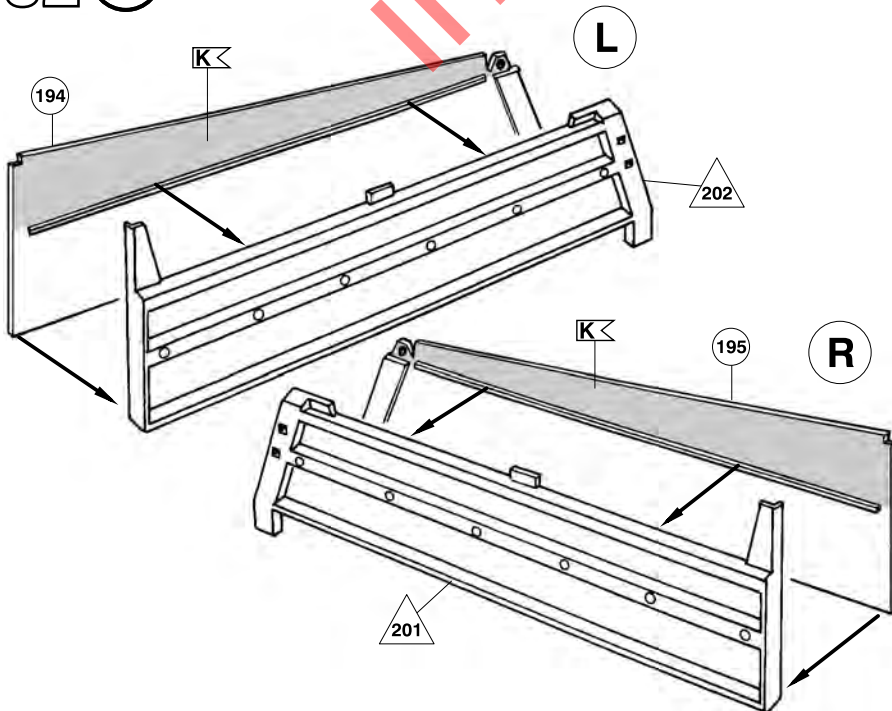

93 

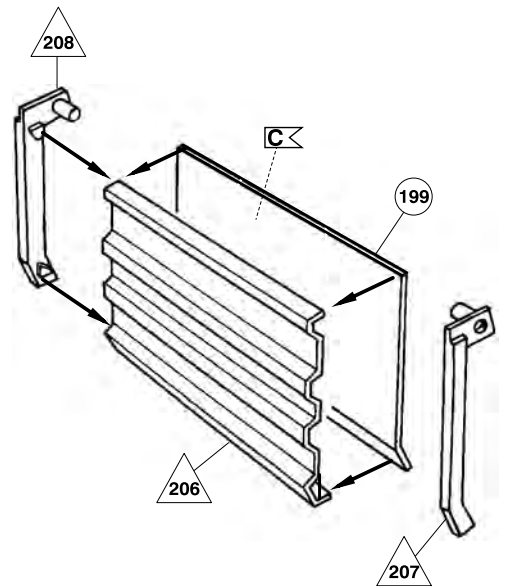

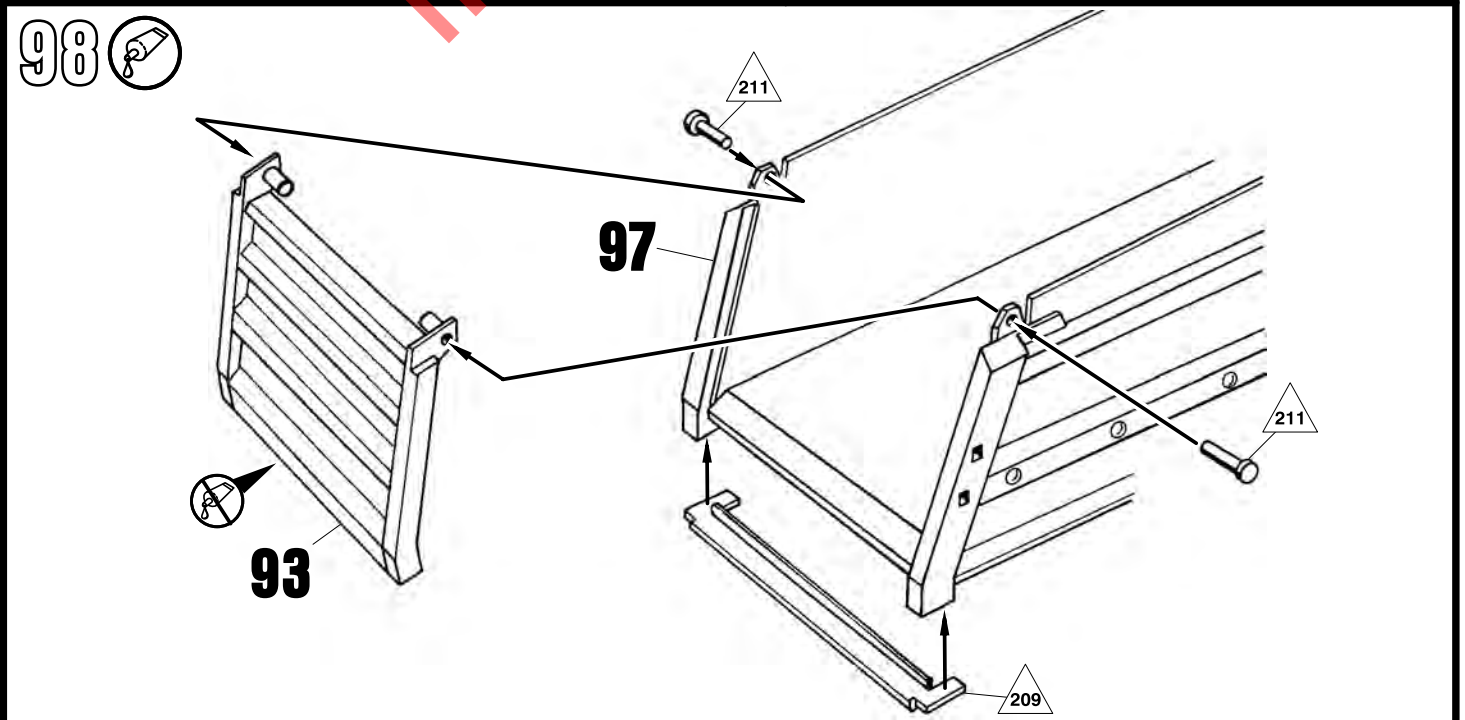
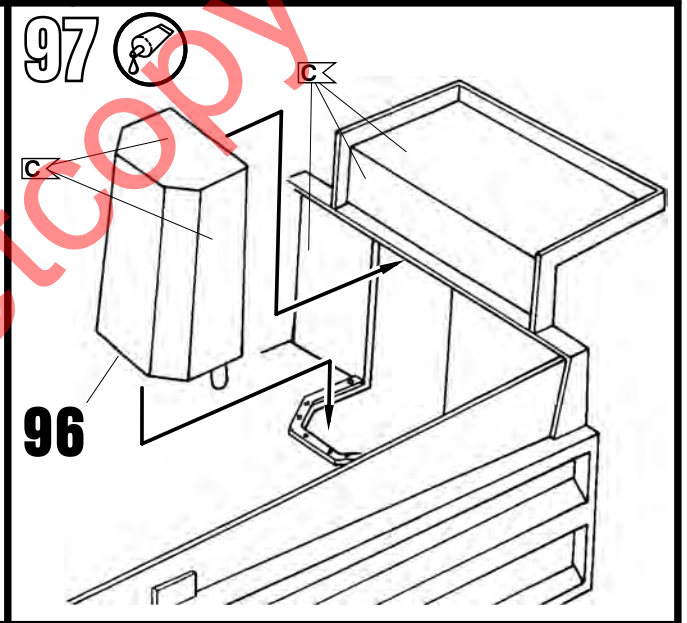
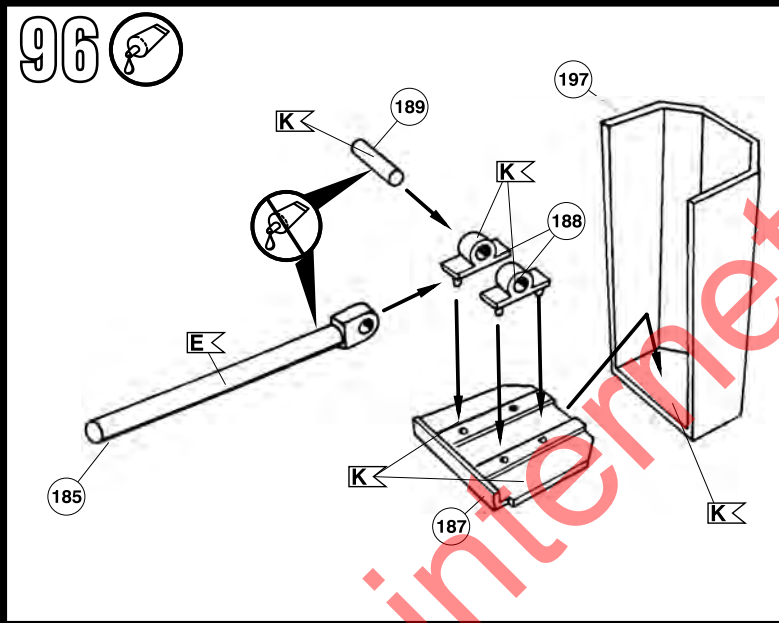
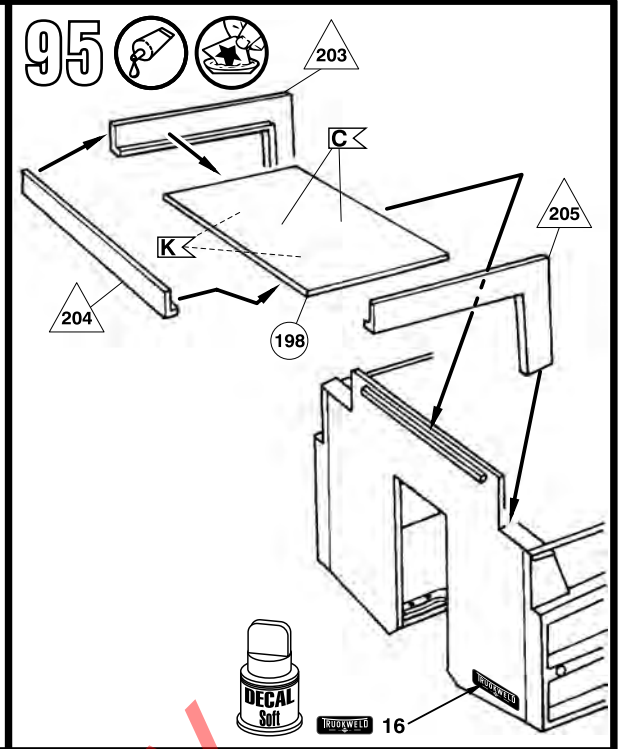
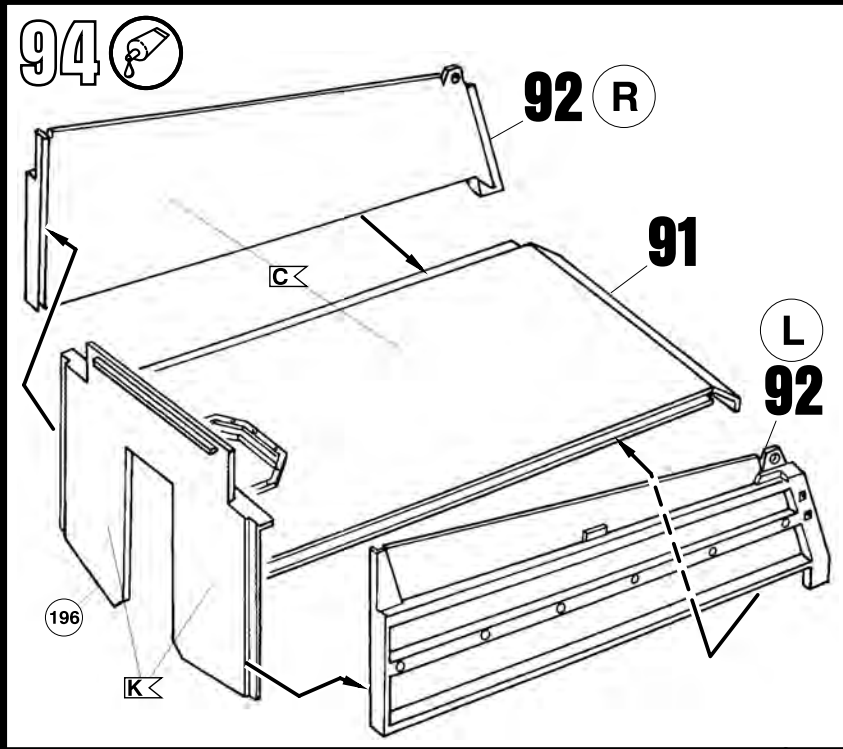

99 

98

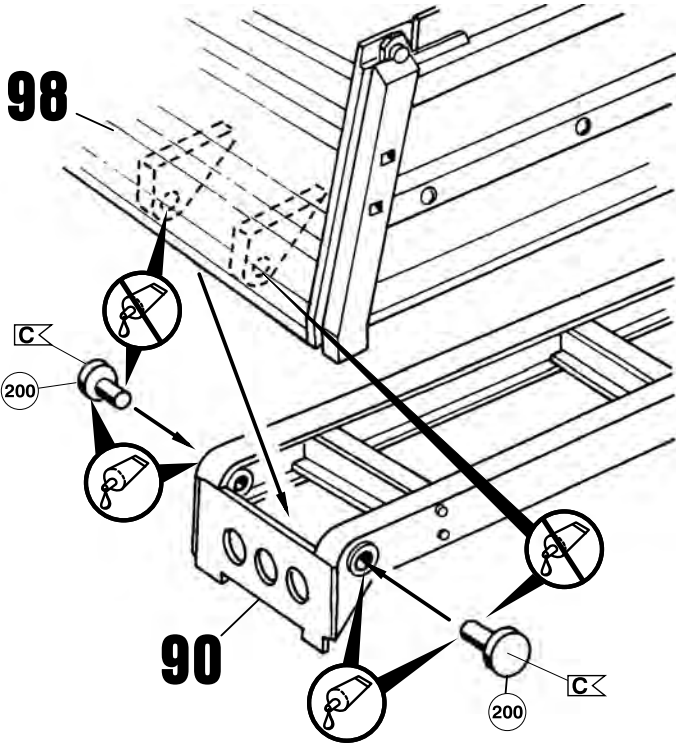

90

100 

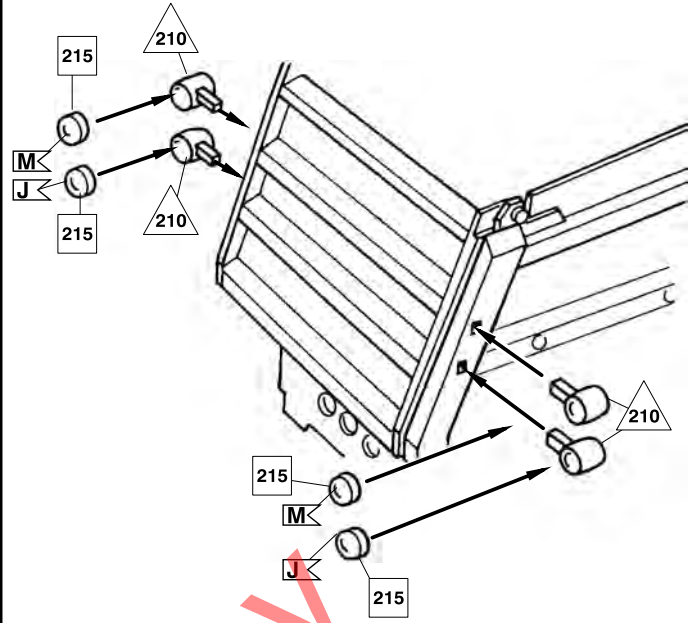

101 

100

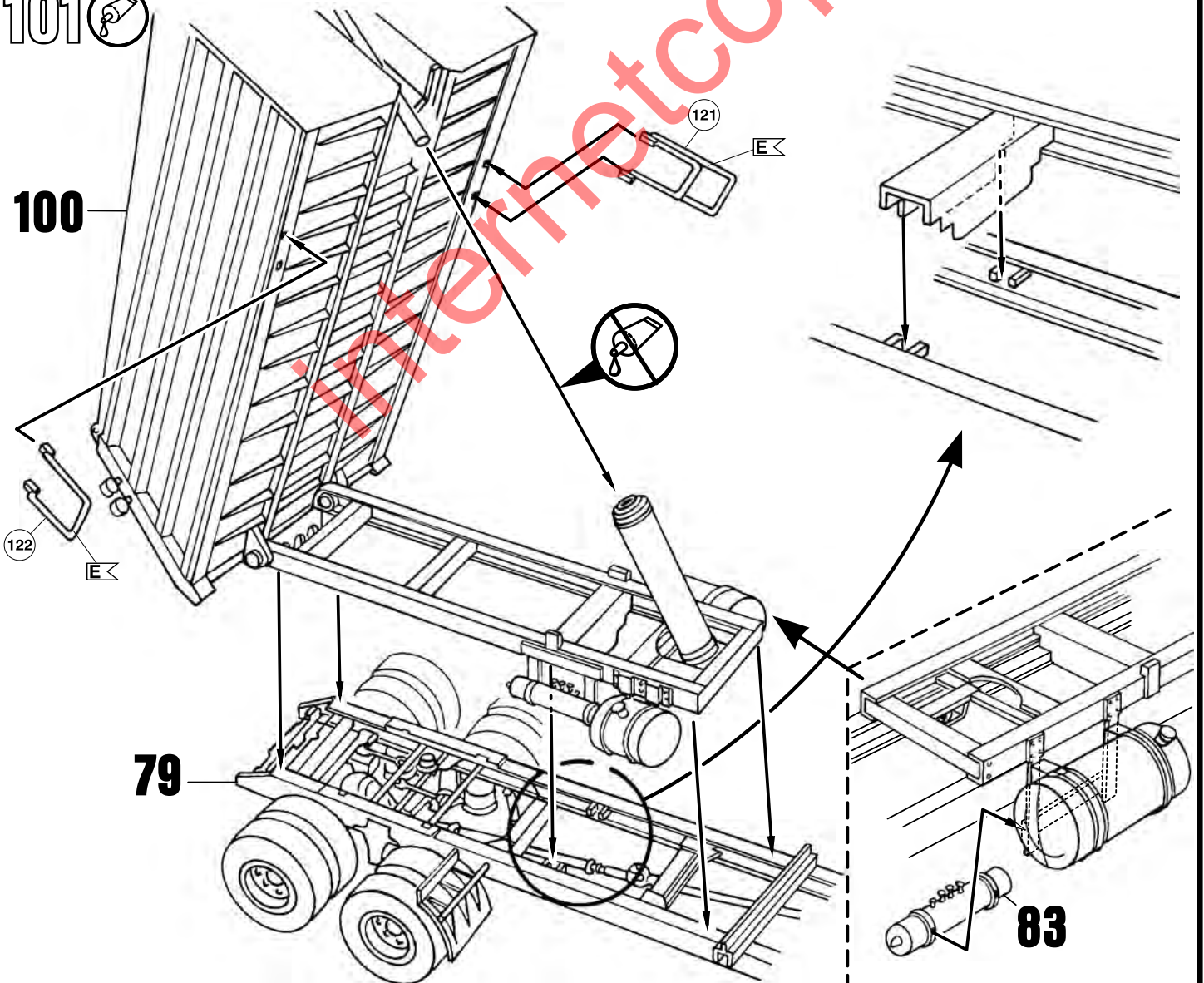

79

83

102

