

# TWU 007

## 1975 Italian Grand Prix - James Hunt

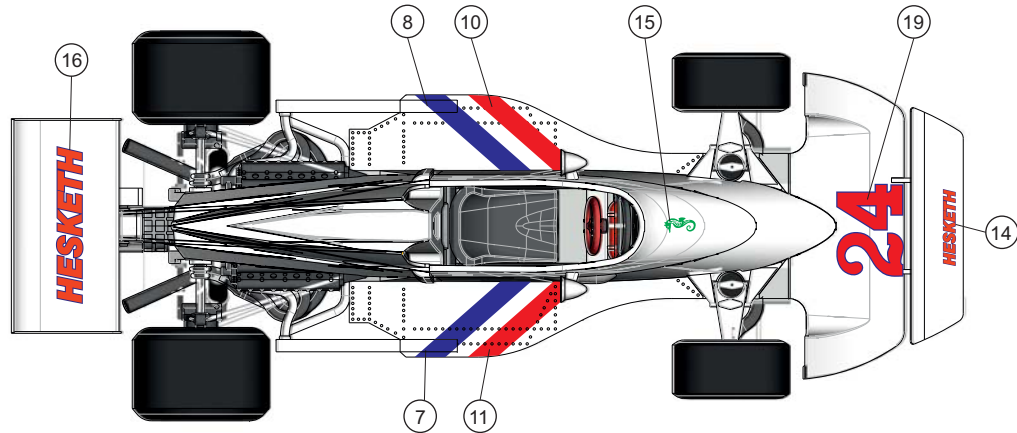

Top view - Decal Layout

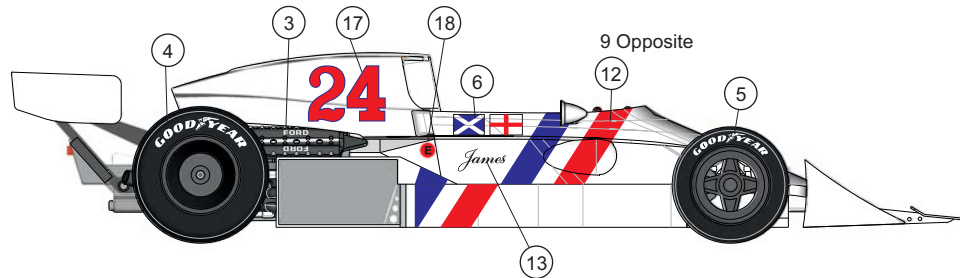

POSA DECAL

Side view - Decal Layout

# HESKETH 308C



The distinctive Hesketh 308C first raced towards the end of the 1975 European season. Designed by Harvey Postlethwaite; a very shallow monocoque was used in an effort to reduce frontal area and drag. Initially the chassis was not rigid enough and made the car very difficult to drive. Despite this James Hunt finished 5th in the Italian GP and 4th in the US GP at Watkins Glen.

The car ran without sponsorship, carrying only the white, red and blue colours of the Hesketh family. Cosworth engines and Hewland gearboxes were used. The suspension members were inboard and coil springs or rubber dampers were used. At the end of 1975 the cars were sold to Walter Wolf.

1/43rd Scale White Metal Kit  
Collectors model  
Not suitable for small children

## Photo Etch

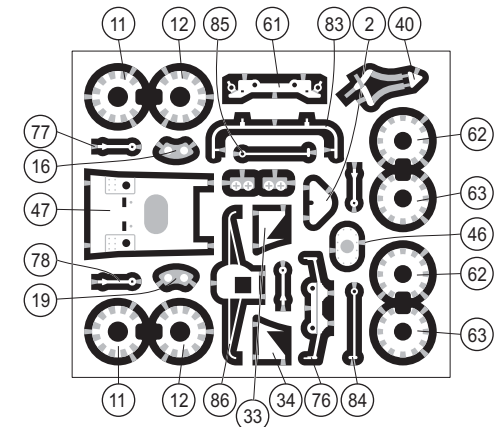
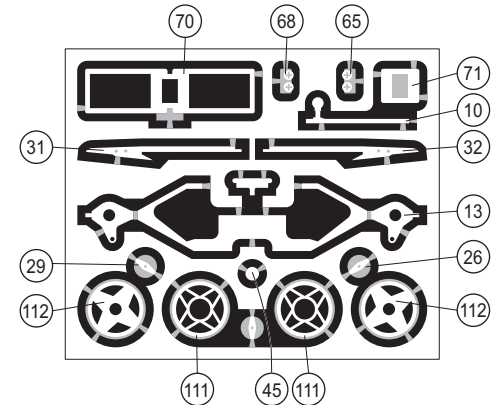
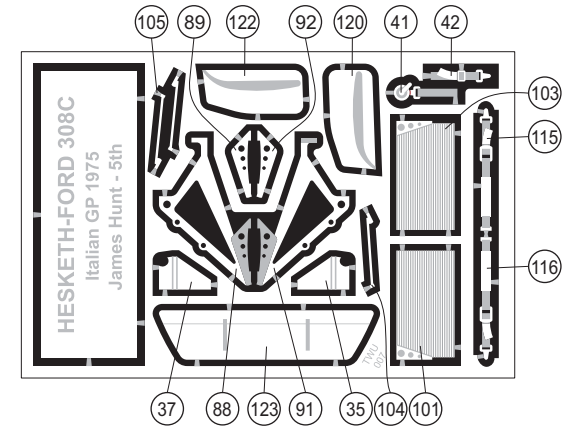

# PAINT COLOURS

- |                      |                             |                           |
|----------------------|-----------------------------|---------------------------|
| <b>TS26</b> white    | <b>X11</b> silver           | <b>XF8</b> flat blue      |
| <b>X7</b> red        | <b>X18</b> semi gloss black | <b>XF16</b> aluminium     |
| <b>X10</b> gun metal | <b>XF1</b> flat black       | <b>XF56</b> metallic grey |

# DRILLING INSTRUCTIONS

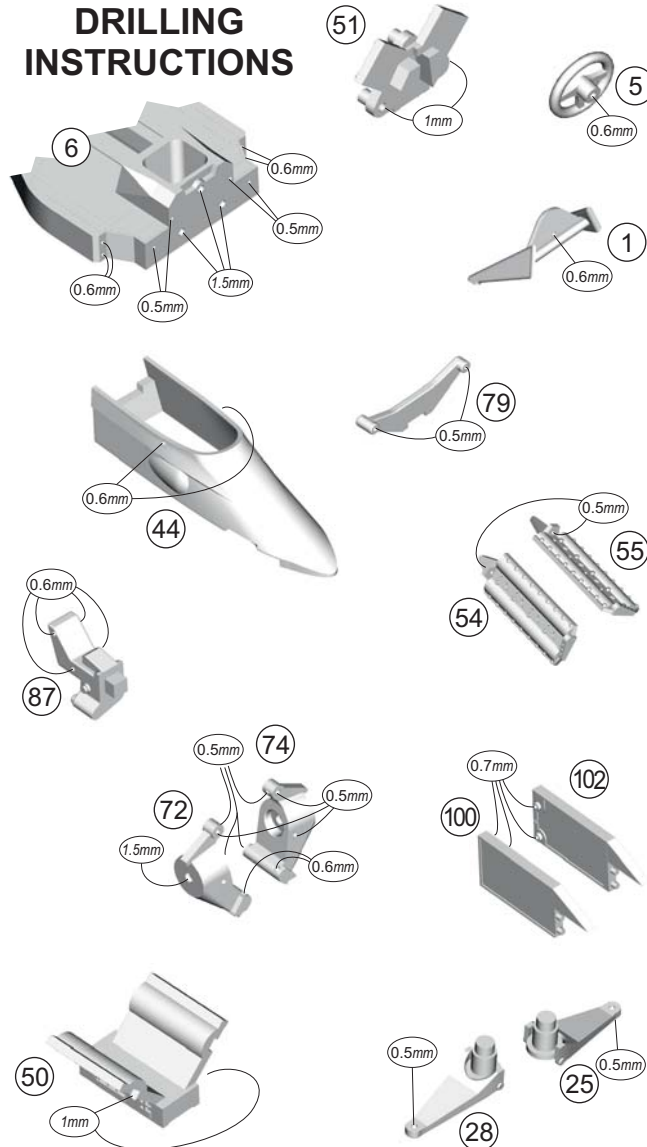

1

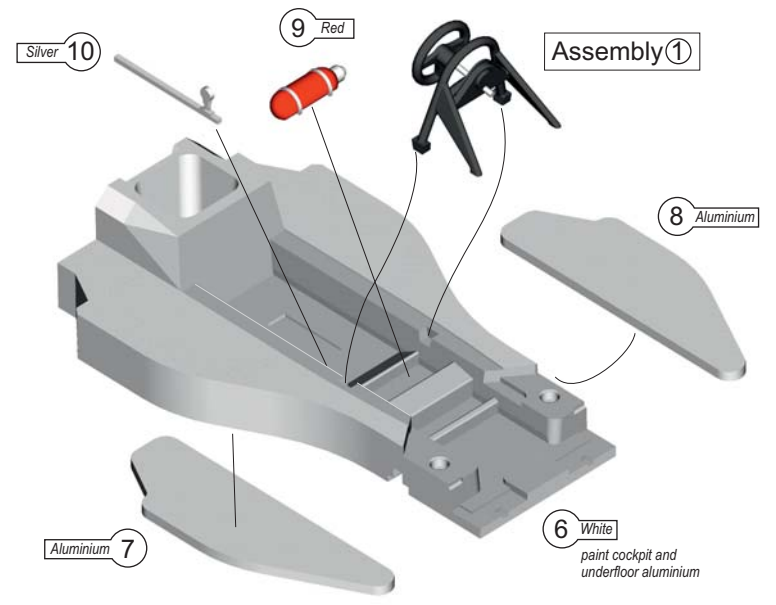

2

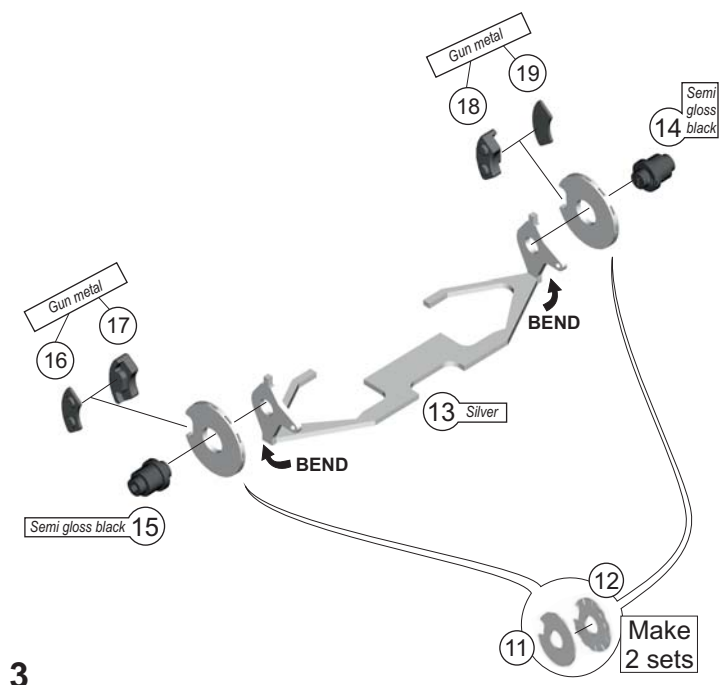

3

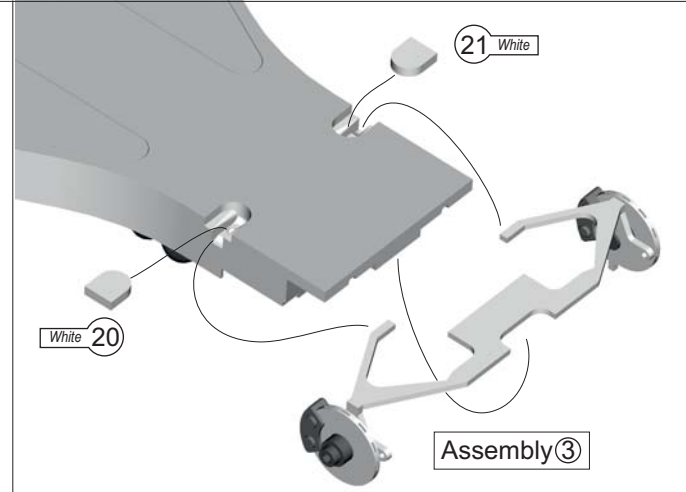

4

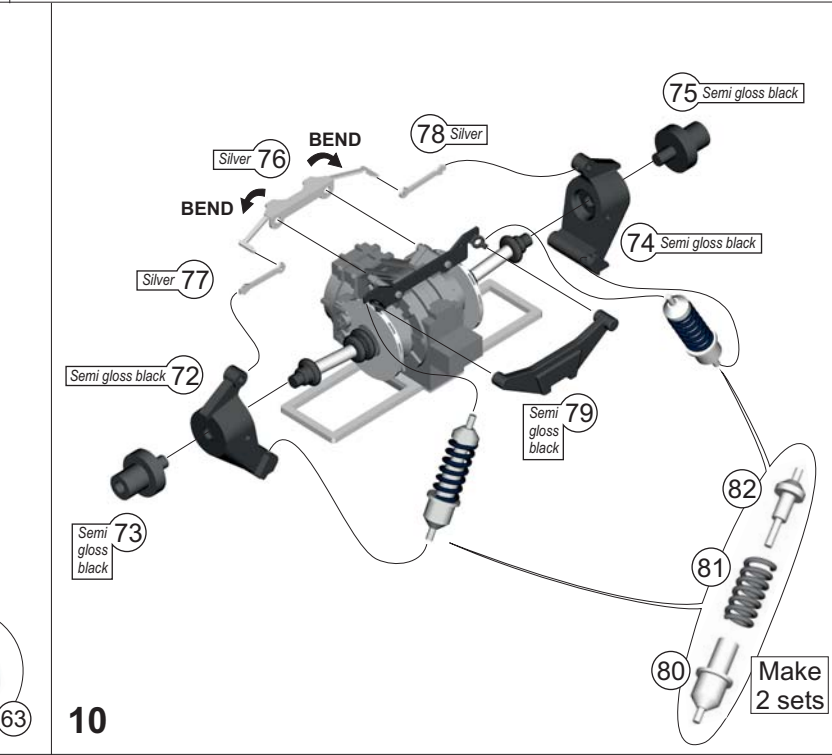
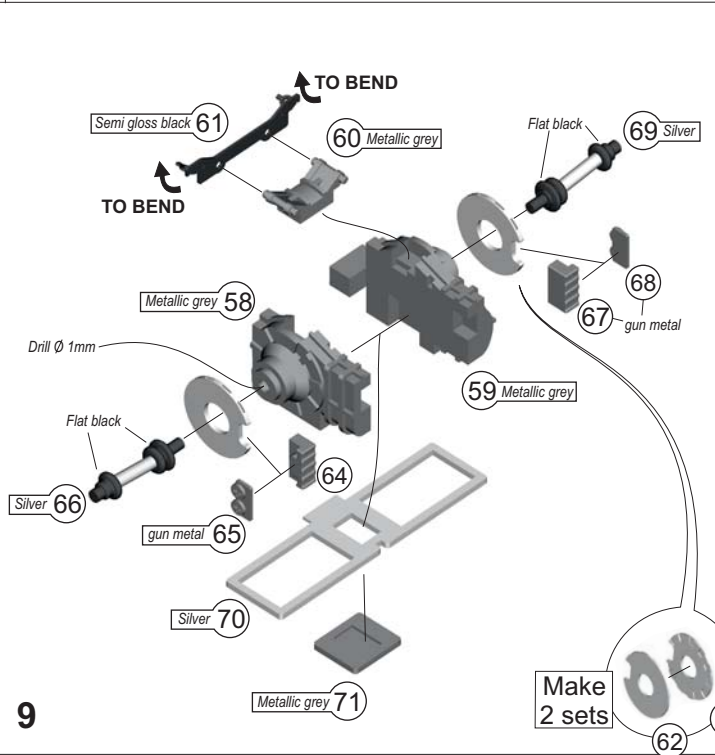
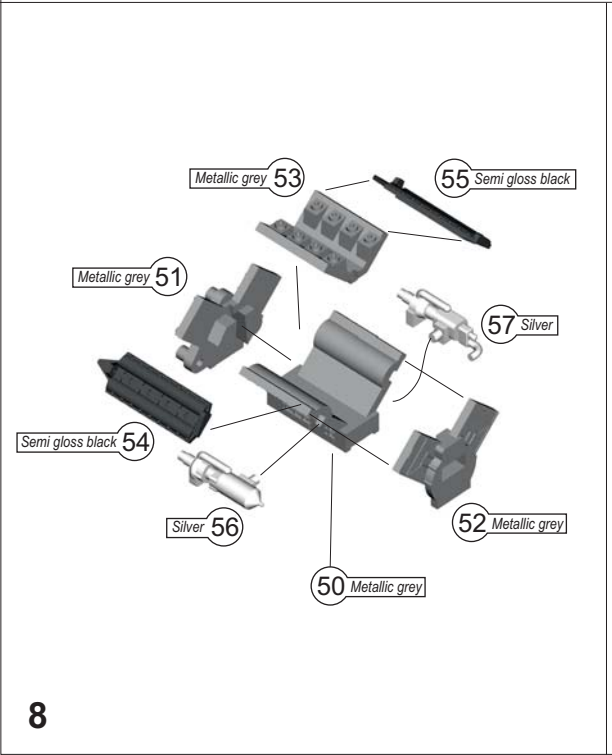
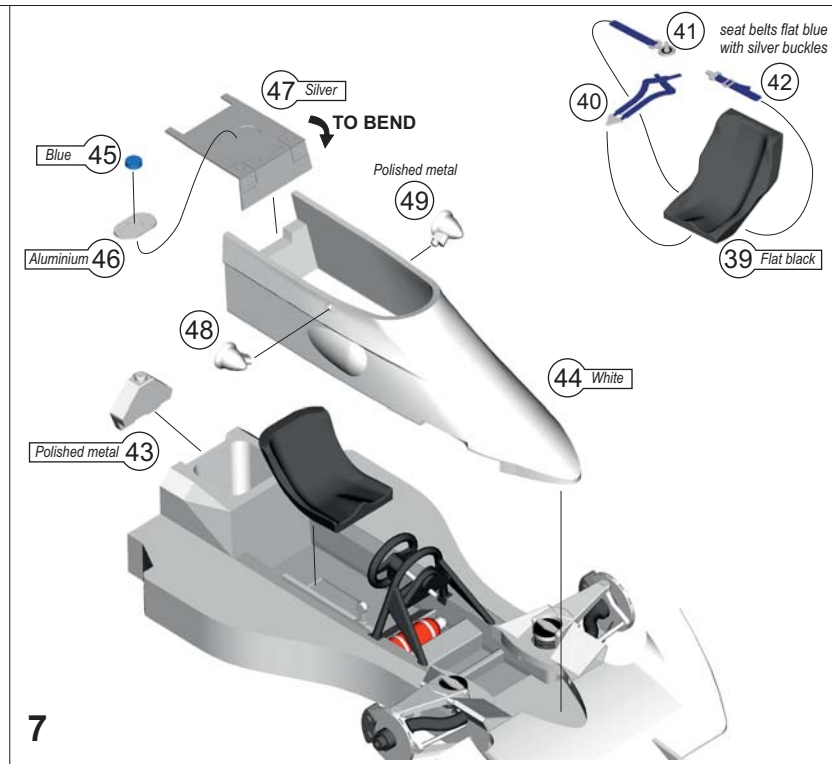
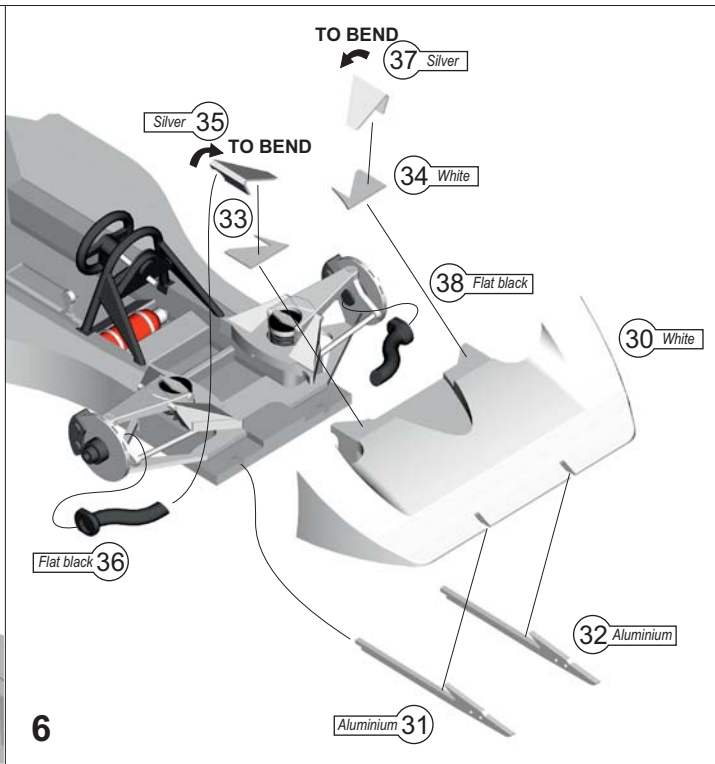
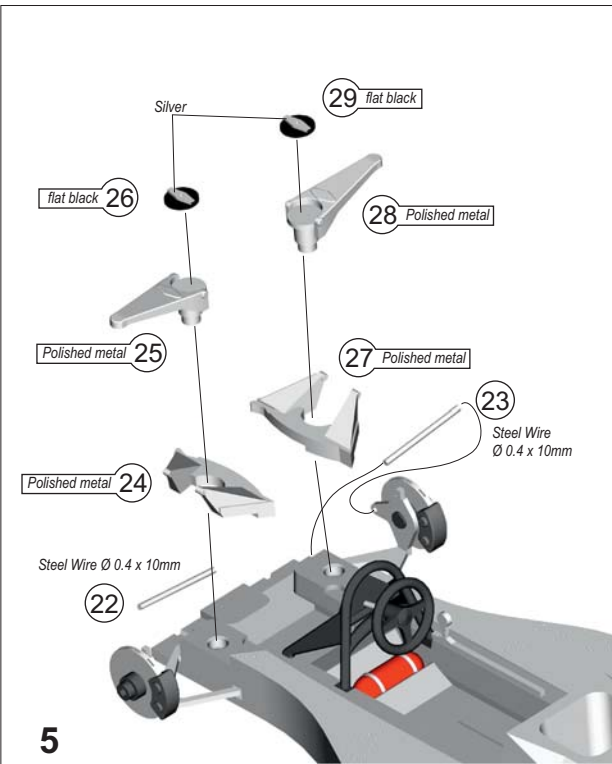

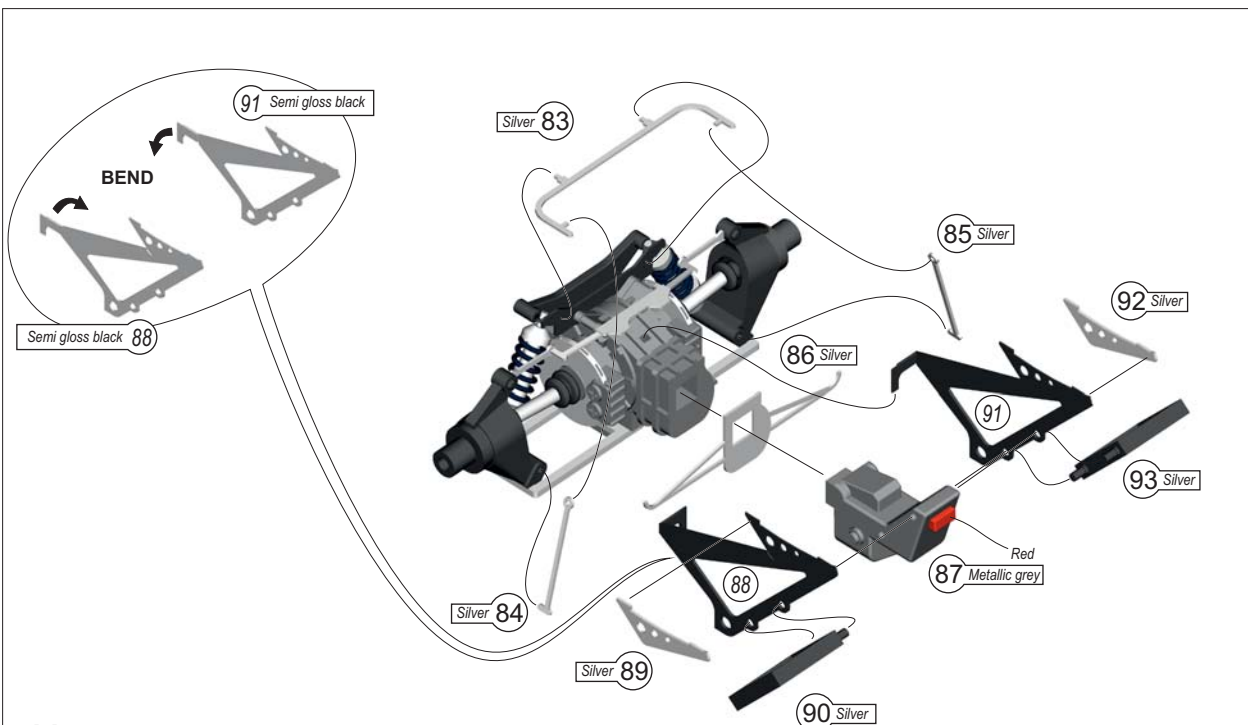

11

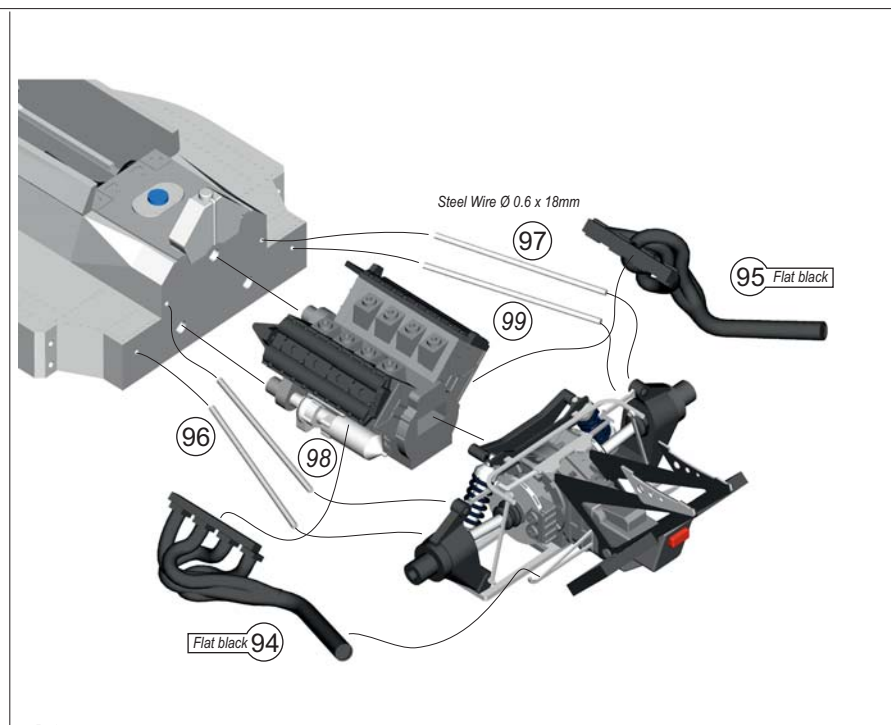

12

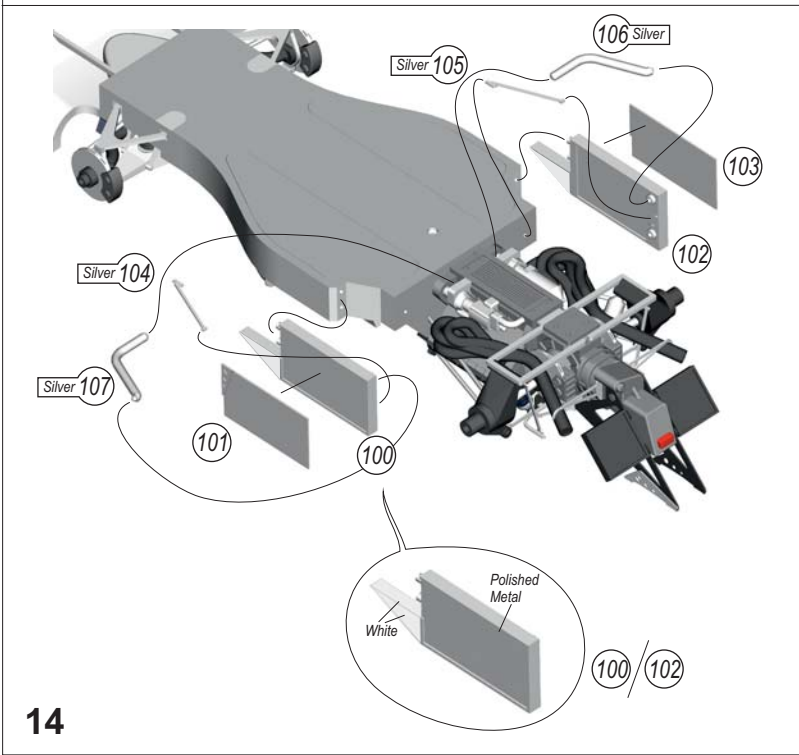

14

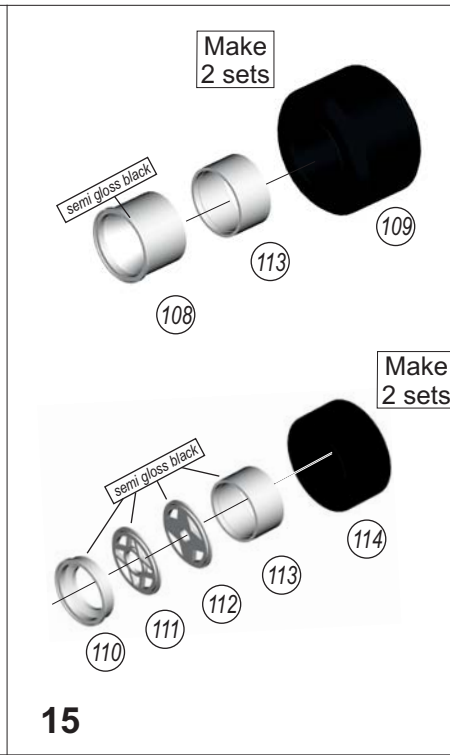

15

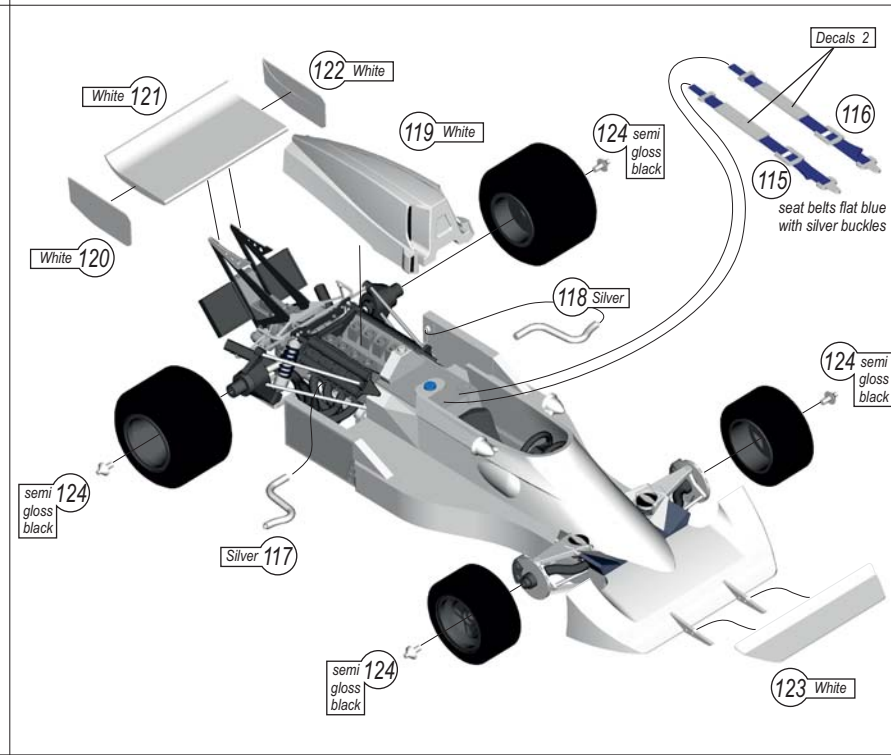

123 White